

DESIGN		
INT.	DATE	REASON

F.A.U. RTE.	SECTION	COUNTY	TOTAL SHEETS	SHEET NO.
6108	***	LA SALLE	679	175
STA. 242+00		TO STA. 247+00		
FED. ROAD DIST. NO.		ILLINOIS FED. AID PROJECT		
*** (70X, 71X)RS-1, (71X-VBR)DM				
CONTRACT NO. 66225				

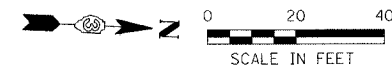

PLOTS & CHECKS		
INT.	DATE	REASON

FILE NAME = \$FILE\$
 PLOT SCALE = \$PSCALE\$
 PLOT DATE = \$DATE\$
 PLOT OPERATOR = \$USER\$

CHECKS		
INT.	DATE	REASON

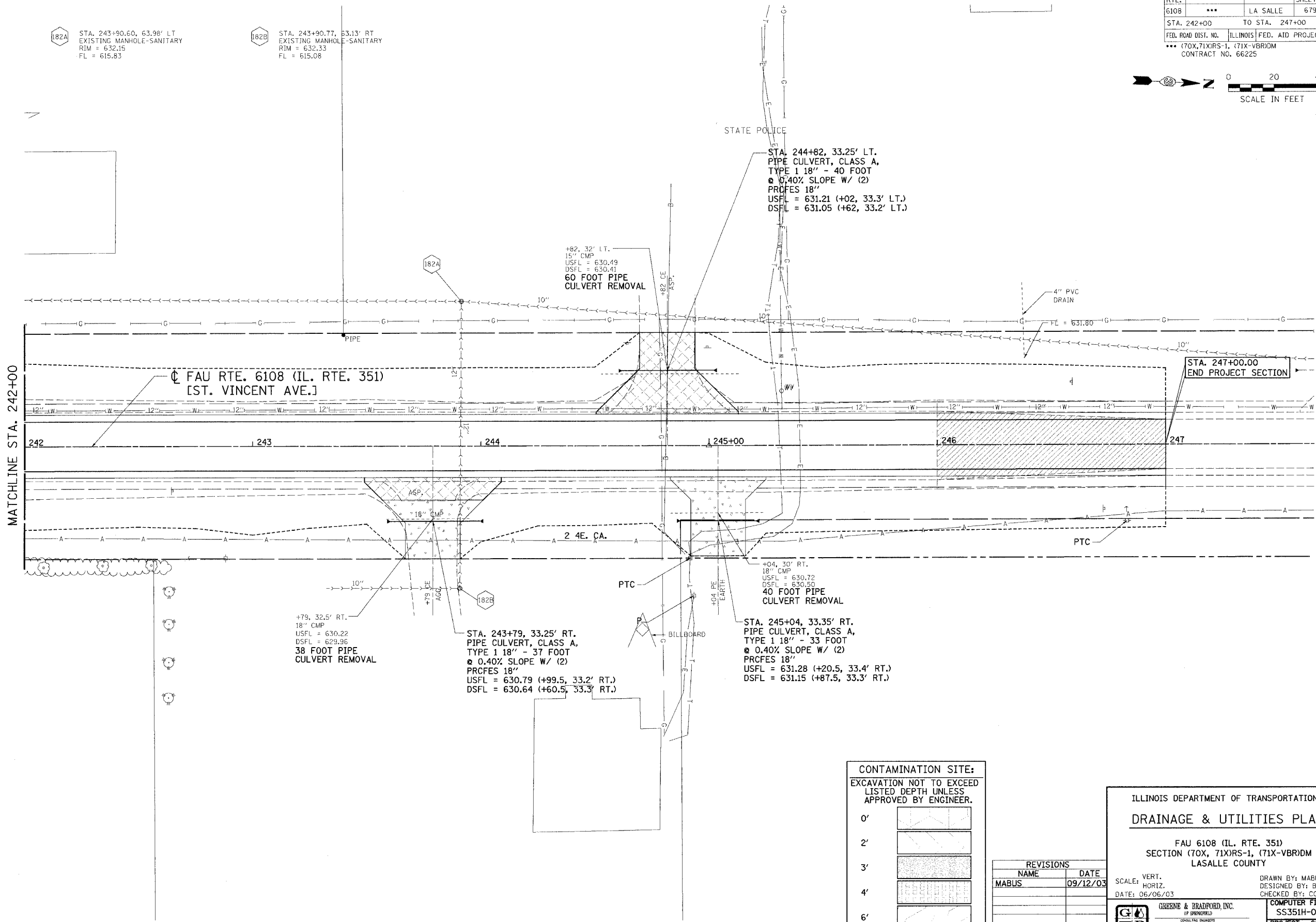

CONTAMINATION SITE:
 EXCAVATION NOT TO EXCEED LISTED DEPTH UNLESS APPROVED BY ENGINEER.

0'	
2'	
3'	
4'	
6'	

REVISIONS	
NAME	DATE
MABUS	09/12/03

ILLINOIS DEPARTMENT OF TRANSPORTATION
DRAINAGE & UTILITIES PLAN

FAU 6108 (IL. RTE. 351)
 SECTION (70X, 71X)RS-1, (71X-VBR)DM
 LASALLE COUNTY

SCALE: VERT.
 HORIZ.
 DATE: 06/06/03

DRAWN BY: MABUS
 DESIGNED BY: BOTT
 CHECKED BY: COLBROOK

GREENE & BRADFORD, INC.
 OF SPRINGFIELD

COMPUTER FILE NO.
 SS351H-02
 PROJECT: 01194_B.S
 04/27/04-RPB