

DESIGN		
INT.	DATE	REASON

PLOTS & CHECKS			
INT.	DATE	NO.	REASON

CHECKS		
INT.	DATE	REASON

F.A.U. RTE.	SECTION	COUNTY	TOTAL SHEETS	SHEET NO.
6108	***	LA SALLE	679	230
STA. TO STA.		LA SALLE		
FED. ROAD DIST. NO. 3 ILLINOIS FED. AID PROJECT				
*** (70X,71X)RS-1, (71X-VBR)DM				
CONTRACT NO. 66225				

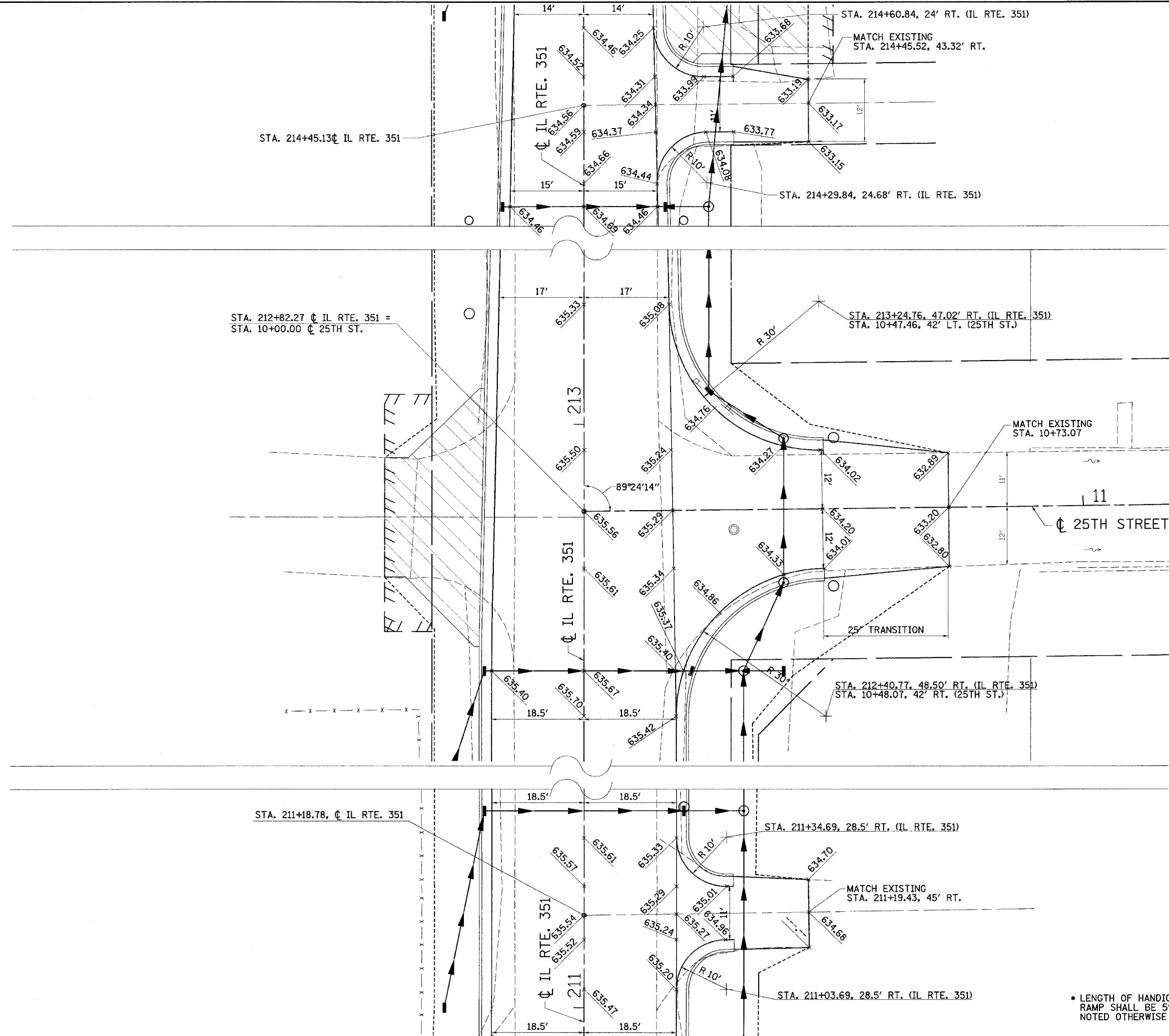
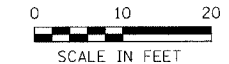

• LENGTH OF HANDICAP RAMP SHALL BE 5' UNLESS NOTED OTHERWISE

REVISIONS	
NAME	DATE

ILLINOIS DEPARTMENT OF TRANSPORTATION

INTERSECTION DETAILS

F.A.U. 6108 (IL RTE. 351)
LA SALLE COUNTY
SEC. (70X,71X) RS-1, (71X-VBR)DM

SCALE: VERT.	DRAWN BY: MABUS DESIGNED BY: KUNTZMAN CHECKED BY: COLBROOK
HORIZ.	
DATE 03/19/01	
 <small>GREENE & BRADFORD, INC. OF SPRINGFIELD CONSULTING ENGINEERS REGISTERED PROFESSIONAL ENGINEERS STATE OF ILLINOIS PROFESSIONAL DESIGN FIRM NO. 021-000918 OFFICE: 601 N. 5TH ST., SPRINGFIELD, ILL. 62762-2501</small>	COMPUTER FILE NO. INT.11-02 PROJECT 01194.B.S 04/01/04-RPB