

DESIGN		
INT. DATE	REASON	

PLOTS & CHECKS		
INT. DATE	NO.	REASON

FILE NAME	SCALE	DRY	PLOTTED

CHECKS		
INT. DATE	REASON	

F.A.U. RTE.	SECTION	COUNTY	TOTAL SHEETS	SHEET NO.
6108	****	LASALLE	679	255
STA.	TO STA.			
FED. ROAD DIST. NO.	ILLINOIS	FED. AID PROJECT		
**** (70X, 71X)RS-1, (71X-V)RDM				
CONTRACT NO. 66225				

EXISTING STRUCTURE
SUPERSTRUCTURE: TIMBER DECK-22' ROADWAY.
SUBSTRUCTURE: TIMBER POST BEAMS ON CONCRETE FOOTINGS AND ONE STONE MASONRY PIER.
EXISTING CULVERT: 6'-3" TIMBER.
EXISTING BRIDGE AND CULVERT TO BE REMOVED BY CONTRACTOR.

B.M. #100 ON N.E. CORNER EXISTING
 TIMBER BRIDGE APPROX STA. 13+60
 EL. 630.21
 B.M. #101
 E.R. SPIKE IN POWER POLE
 30' LT. OF STA. 46+05
 EL. 640.01

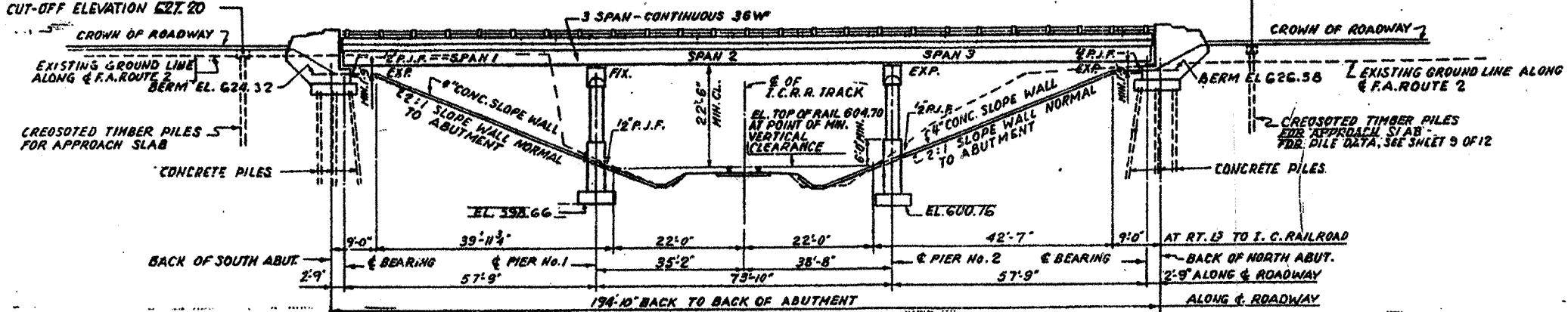

INDEX OF SHEETS

SHEET NO	TITLE
1.	GENERAL PLAN AND ELEVATION
2.	BORINGS AND QUANTITIES
3.	GENERAL NOTES, EXCAVATION AND NAME PLATE
4.	DECK REINFORCEMENT PLAN AND CROSS SECTION
5.	TOP OF SLAB ELEVATION
6.	FRAMING PLAN AND BEARING DETAILS
7.	HANDRAIL DETAILS
8.	NORTH AND SOUTH ABUTMENT PLAN
9.	ABUTMENT DETAILS
10.	PIERS 1 AND 2
11.	REINFORCEMENT BAR LIST
12.	ABUTMENT PILES

NOTE: SLOPEWALLS ARE REINFORCED WITH WELDED WIRE FABRIC 6"x6" MESH NO. 4 WIRE WEIGHING APPROX. 58# PER 100 SQ. FEET. CUT OFF WALL IS INCLUDED IN QUANTITY OF SLOPE WALL.
 FOR EXCAVATION LIMITS AT PIERS AND ABUTMENTS, AND LOCATION OF NAME PLATES SEE SHEET 3.
 FOR SPACING OF 3"x6" FLOOR DRAINS SEE SHEET 4. LAYOUT OF SLOPE WALLS AND PAVED DITCHES MAY BE VARIED TO SUIT GROUND CONDITIONS IN THE FIELD AS DIRECTED BY THE ENGINEER.
 FOR SECTION A-A, B-B, D-D, G-G, H-H SEE SHT. 3. FOR LOCATION OF APPROACH SLAB PILES SEE SHT 9. QUANTITIES OF EARTH EXCAVATION AND EMBANKMENT ARE INCLUDED IN QUANTITIES OF ROAD PLANS. FOR VERTICAL CURVE DATA SEE ROAD PLAN SHT. 4 OF 24.

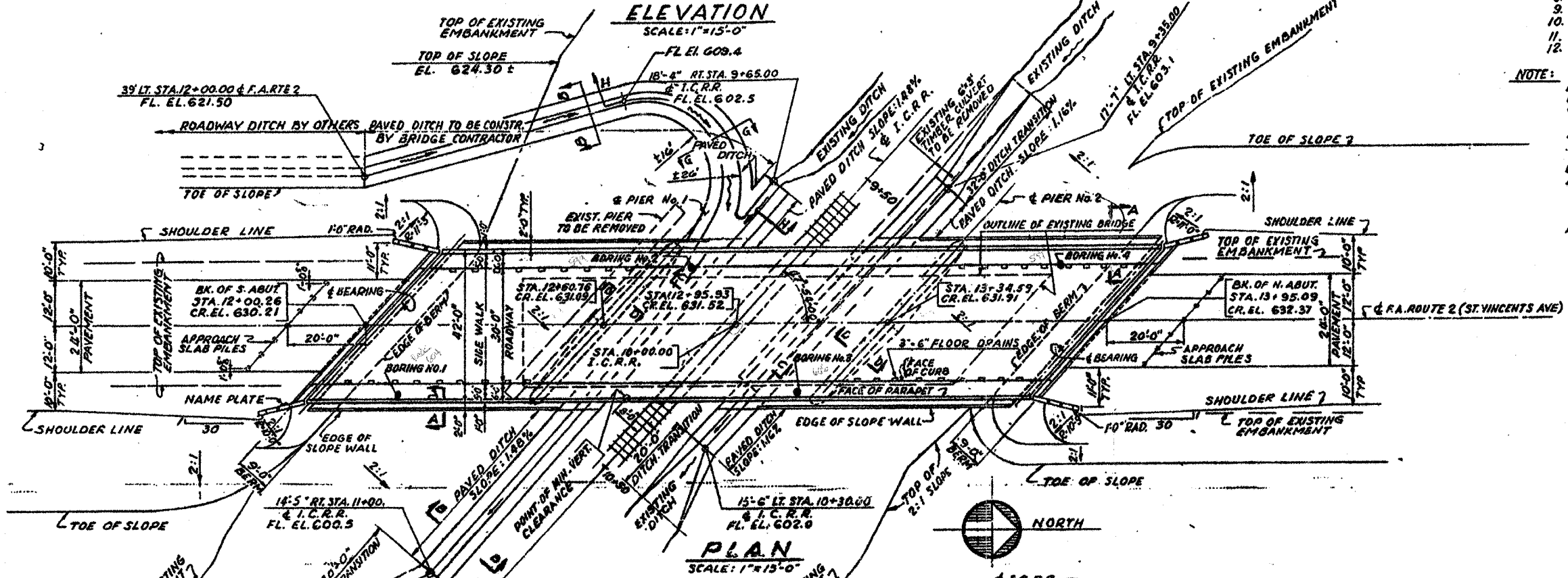

HIGHWAY CLASSIFICATION
 D.H.V. TYPE M.P.H.
 531 M 50

DESIGN LOADS
 LL+70-S16-84 EXCEPT SLAB DESIGNED IN ACCORDANCE WITH A.A.S.H.O. T. 8 (59).

FUTURE D.I. 1/2" BIT WEARING SURFACE

DESIGN STRESSES
CONCRETE:
 F_c = 3500 P.S.I.
 F_t = 1400 P.S.I.
 F_c = 1000 P.S.I. (FOOTINGS)
 F_t = 75 P.S.I. (FOOTINGS)
 n = 10

STRUCTURAL STEEL
 F_y = 18,000 P.S.I.
REINFORCING STEEL
 F_y = 20,000 P.S.I.

FOUNDATION:
 ABUTMENT = 25 TONS (CONCRETE PILES)
 APPROACH SLAB = 15 TONS (TIMBER PILES)
 PIERS (SPREAD FOOTINGS) = 7,000 P.S.F.

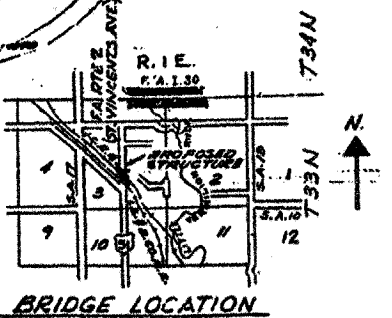
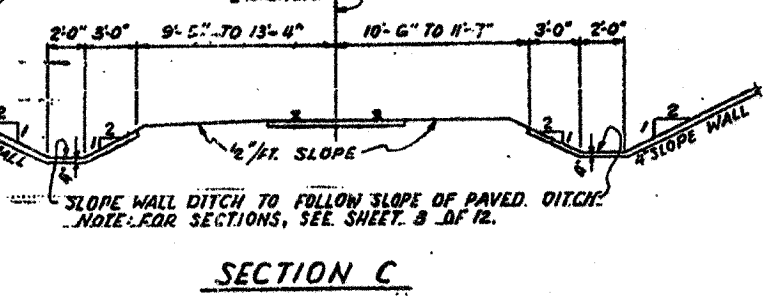

ILLINOIS DEPARTMENT OF TRANSPORTATION
EXISTING BRIDGE PLANS
 EXISTING (SN 050-0025)

REVISIONS	
NAME	DATE

SCALE: VERT. HORIZ. DATE: 01/03/03

DRAWN BY: JETT
 DESIGNED BY: KUNTZMAN
 CHECKED BY: COLBROOK

GREENE & BRADFORD, INC.
 OF SPRINGFIELD

COMPUTER FILE NO.
 EX BRIDGE-1
 PROJECT 01194.B.S
 10/30/03-JLJ