

FAU RTE.	SECTION	COUNTY	TOTAL SHEETS	SHEET NO.
6194 (109)R.	RS-4	KANKAKEE	82	36
STA.		TO STA.		
FED. ROAD DIST. NO.		ILLINOIS FED. AID PROJECT		

66402

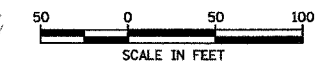

PLAN
 SURVEYED BY: _____ DATE: _____
 ALIGNED BY: _____
 CHECKED BY: _____
 DATE: _____
 NOTE BOOK NO. _____

PROFILE
 SURVEYED BY: _____ DATE: _____
 GRADED BY: _____
 CHECKED BY: _____
 DATE: _____
 STRUCTURE NOTATION: _____
 NOTE BOOK NO. _____

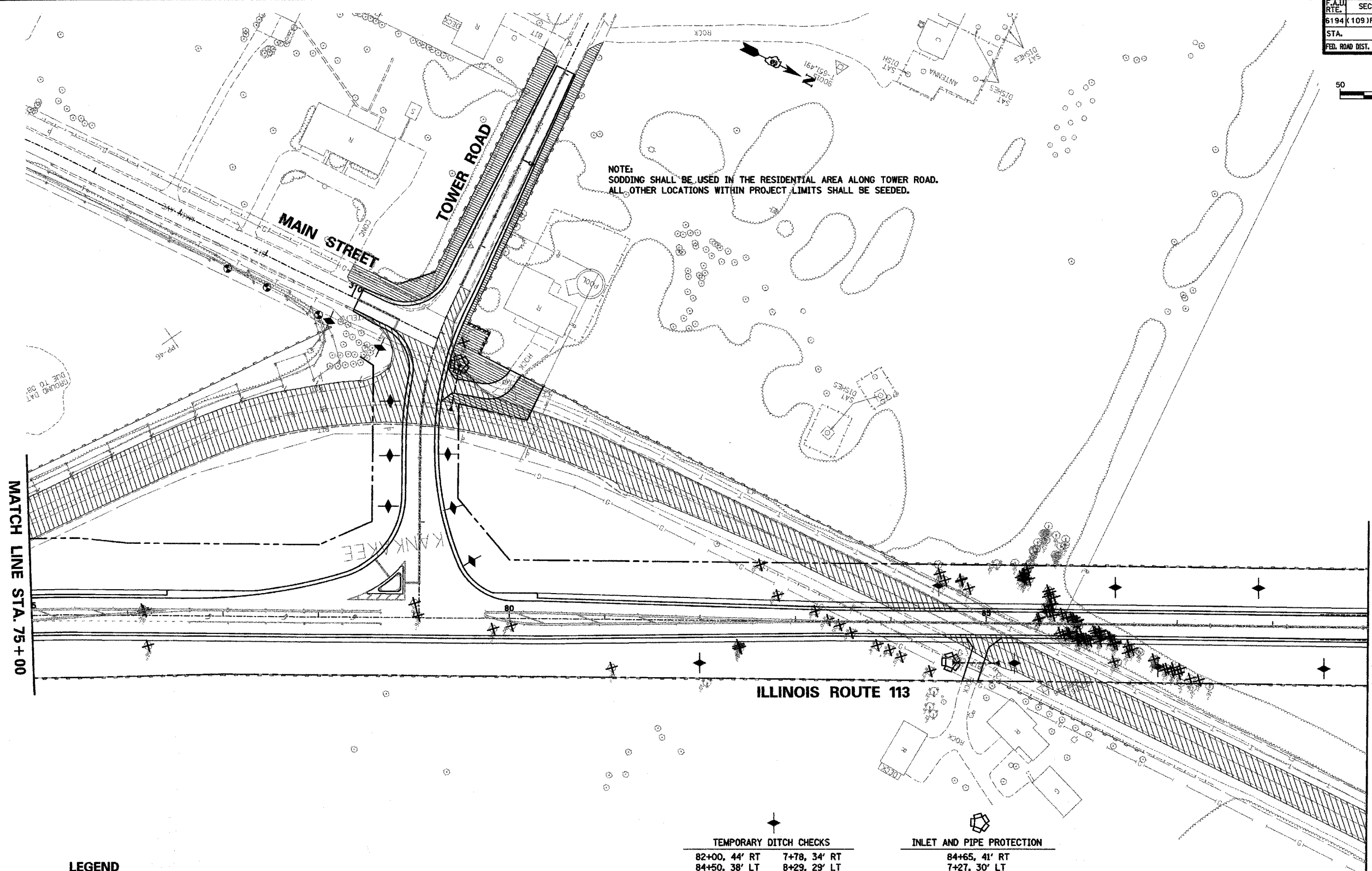

MATCH LINE STA. 75 + 00

MATCHLINE STA. 89 + 00

LEGEND

- PERIMETER EROSION BARRIER
- PROPOSED R.O.W.
- TEMPORARY EASEMENT
- EXISTING R.O.W.
- TREE REMOVAL
- PAVEMENT REMOVAL
- SODDING, SALT TOLERANT

TEMPORARY DITCH CHECKS

82+00, 44' RT	7+78, 34' RT
84+50, 38' LT	8+29, 29' LT
85+30, 41' RT	8+31, 32' RT
86+35, 38' LT	8+84, 33' RT
86+80, 43' RT	8+85, 35' LT
87+85, 39' LT	9+41, 55' LT
88+54, 43' RT	309+90, 33' RT
	310+50, 35' RT

INLET AND PIPE PROTECTION

84+65, 41' RT
7+27, 30' LT

ILLINOIS DEPARTMENT OF TRANSPORTATION
 FAU 6194 (ILLINOIS ROUTE 113)
 EROSION CONTROL PLAN
 TREE / PAVEMENT REMOVAL PLAN
 STA 75+00 TO STA 89+00

SCALE: VERT. _____
 HORIZ. _____
 DATE _____

DRAWN BY _____
 CHECKED BY _____

*****DATE*****