

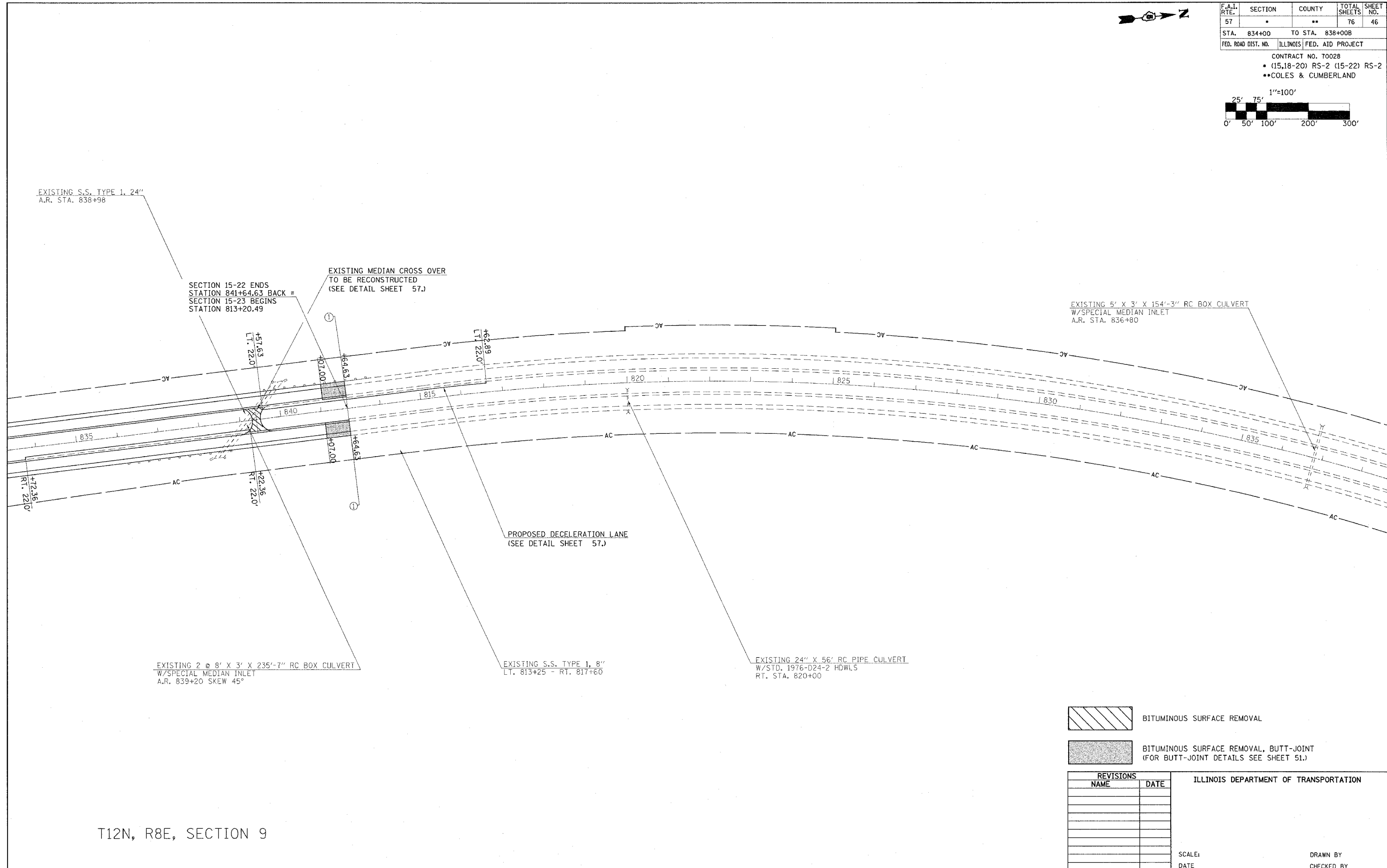

F.A.I. RTE.	SECTION	COUNTY	TOTAL SHEETS	SHEET NO.
57	*	**	76	46
STA. 834+00		TO STA. 838+00B		
FED. ROAD DIST. NO. ILLINOIS FED. AID PROJECT				

CONTRACT NO. T0028  
 • (15,18-20) RS-2 (15-22) RS-2  
 ••COLES & CUMBERLAND

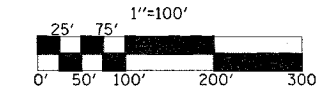

SECTION 15-22 ENDS  
 STATION 841+64.63 BACK =  
 SECTION 15-23 BEGINS  
 STATION 813+20.49

EXISTING MEDIAN CROSS OVER  
 TO BE RECONSTRUCTED  
 (SEE DETAIL SHEET 57.)

EXISTING 5' X 3' X 154'-3" RC BOX CULVERT  
 W/SPECIAL MEDIAN INLET  
 A.R. STA. 836+80

PROPOSED DECELERATION LANE  
 (SEE DETAIL SHEET 57.)

EXISTING 2 @ 8' X 3' X 235'-7" RC BOX CULVERT  
 W/SPECIAL MEDIAN INLET  
 A.R. 839+20 SKEW 45°

EXISTING S.S. TYPE 1, 8"  
 LT. 813+25 - RT. 817+60

EXISTING 24" X 56' RC PIPE CULVERT  
 W/STD. 1976-D24-2 HDWLS  
 RT. STA. 820+00

- BITUMINOUS SURFACE REMOVAL
- BITUMINOUS SURFACE REMOVAL, BUTT-JOINT  
 (FOR BUTT-JOINT DETAILS SEE SHEET 51.)

REVISIONS		ILLINOIS DEPARTMENT OF TRANSPORTATION
NAME	DATE	
		SCALE: DATE

T12N, R8E, SECTION 9

**REVISED**  
 2-22-05  
 SHEET

DRAWN BY  
 CHECKED BY