

T11N, R7E, SECTION 1

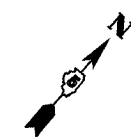

F.A.I. RTE.	SECTION	COUNTY	TOTAL SHEETS	SHEET NO.
57		**	76	35
STA. 521+00	TO STA. 553+00			
FED. ROAD DIST. NO.	ILLINOIS	FED. AID PROJECT		
CONTRACT NO. 70028				
• (15,18-20) RS-2 (15-22) RS-2				
•• COLES & CUMBERLAND				
1"=100'				
0' 50' 100' 200' 300'				

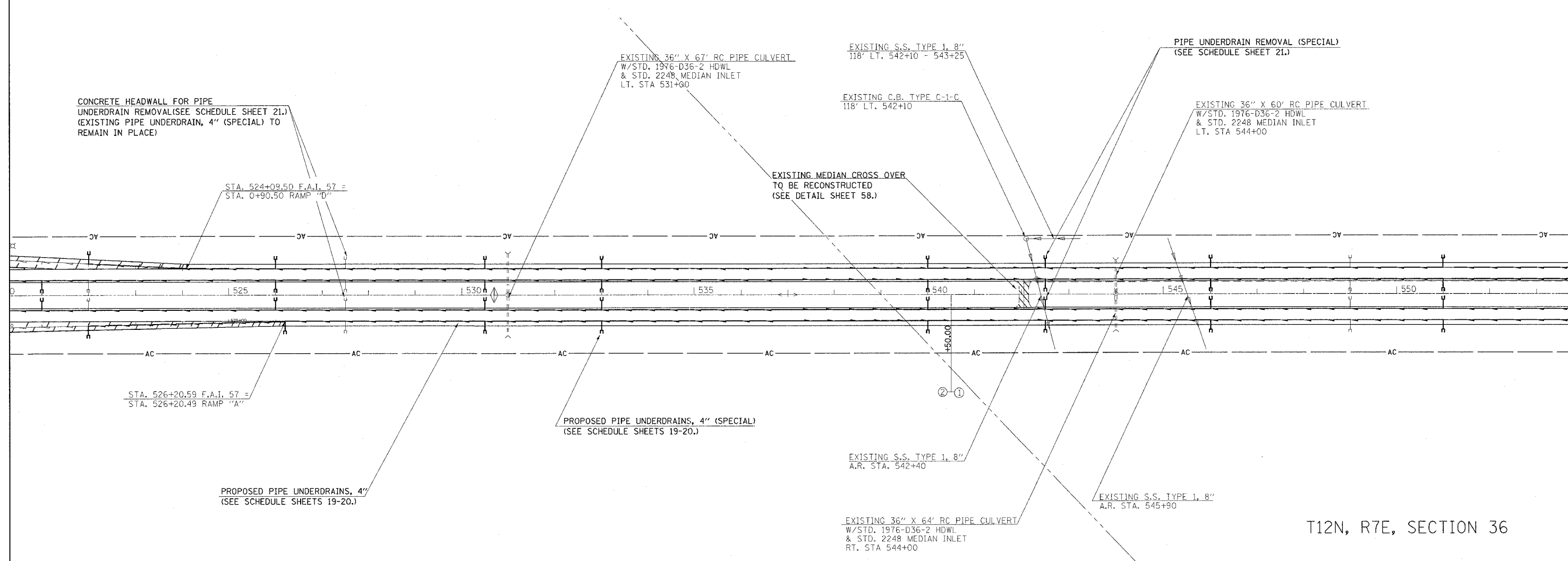

T12N, R7E, SECTION 36

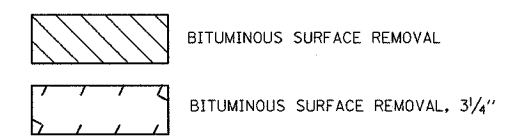

REVISIONS	
NAME	DATE

ILLINOIS DEPARTMENT OF TRANSPORTATION

SCALE: \_\_\_\_\_ DATE \_\_\_\_\_

DRAWN BY \_\_\_\_\_ CHECKED BY \_\_\_\_\_