

F.A.P. RTE.	SECTION	COUNTY	TOTAL SHEETS	SHEET NO.
709	*	CHAMPAIGN	64	40
STA. 418+00		TO STA. 424+00		
FED. ROAD DIST. NO.		ILLINOIS	FED. AID PROJECT	

\* 113RS-6 & (113BR-2)I  
CONTRACT NO. 70181

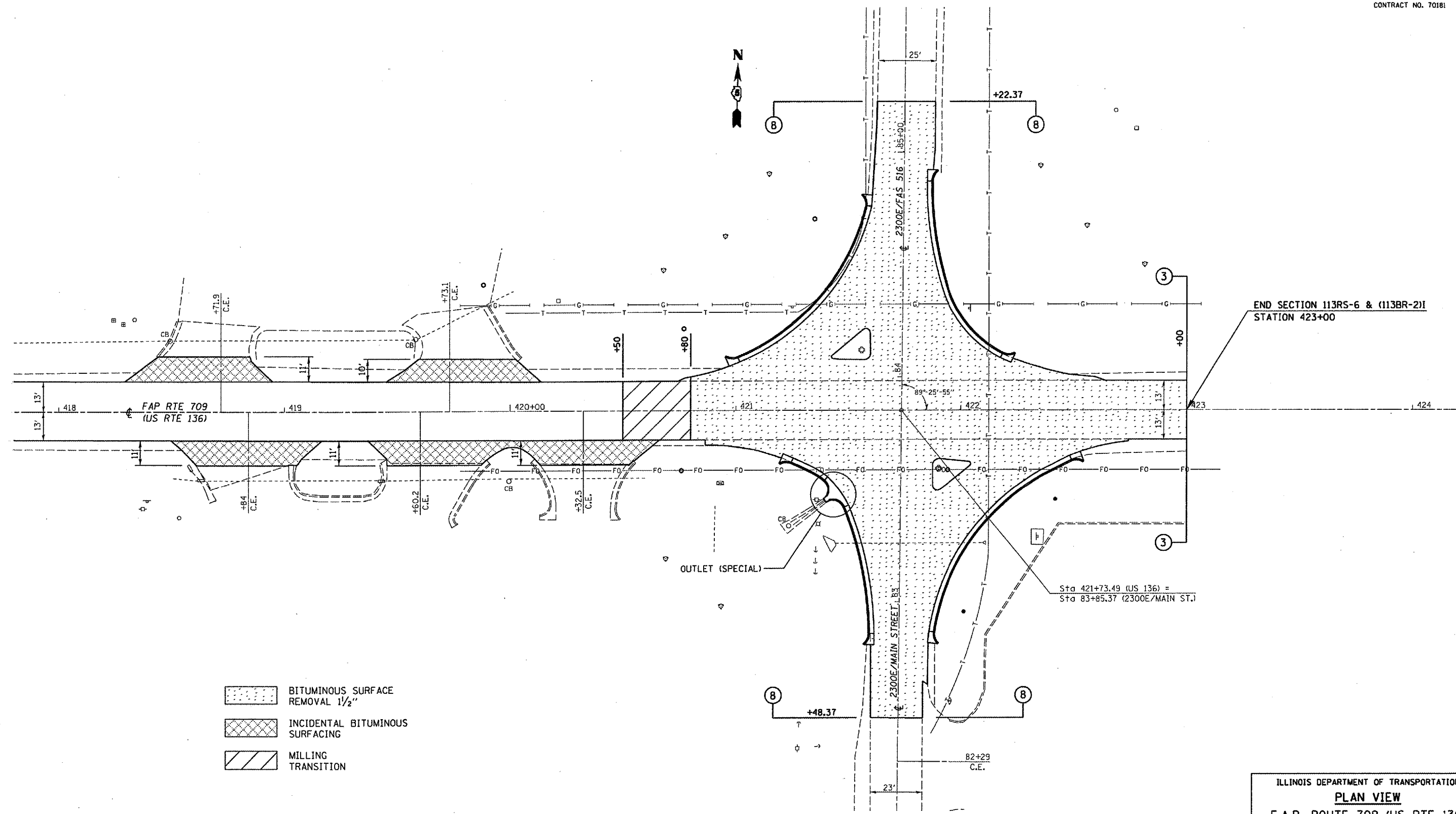

END SECTION 113RS-6 & (113BR-2)I  
STATION 423+00

Sta 421+73.49 (US 136) =  
Sta 83+85.37 (2300E/MAIN ST.)

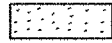
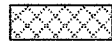
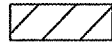
-  BITUMINOUS SURFACE REMOVAL 1 1/2"
-  INCIDENTAL BITUMINOUS SURFACING
-  MILLING TRANSITION

ILLINOIS DEPARTMENT OF TRANSPORTATION  
**PLAN VIEW**  
F.A.P. ROUTE 709 (US RTE 136)  
SECTION 113RS-6 & (113BR-2)I  
CHAMPAIGN COUNTY

SCALE: DATE 08/23/04  
DRAWN BY: CADD  
CHECKED BY:

