

F.A.P. RTE.	SECTION	COUNTY	TOTAL SHEETS	SHEET NO.
709	*	CHAMPAIGN	64	50
STA. 117+00		TO STA. 129+00		
FED. ROAD DIST. NO. ILLINOIS FED. AID PROJECT				
* 113RS-6 & (113BR-2)I CONTRACT NO. 70181				

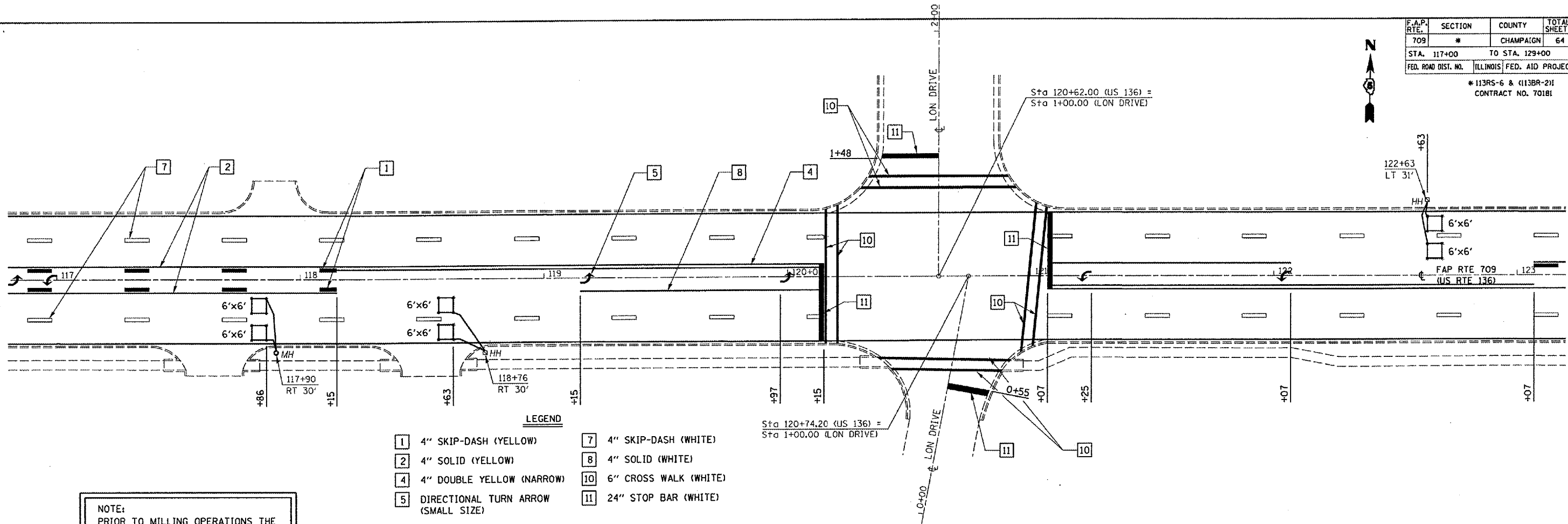

LEGEND

1 4" SKIP-DASH (YELLOW)	7 4" SKIP-DASH (WHITE)
2 4" SOLID (YELLOW)	8 4" SOLID (WHITE)
4 4" DOUBLE YELLOW (NARROW)	10 6" CROSS WALK (WHITE)
5 DIRECTIONAL TURN ARROW (SMALL SIZE)	11 24" STOP BAR (WHITE)

NOTE:
PRIOR TO MILLING OPERATIONS THE ENGINEER SHALL VERIFY PLACEMENT OF DETECTOR LOOPS IN ACCORDANCE WITH THIS DETAIL.

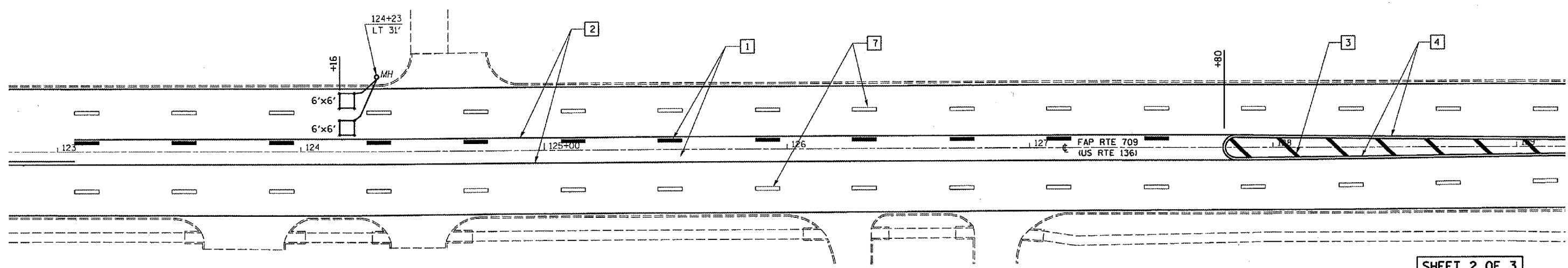

LEGEND

1 4" SKIP-DASH (YELLOW)
2 4" SOLID (YELLOW)
3 12" DIAGONAL (YELLOW)
4 4" DOUBLE YELLOW (NARROW)
7 4" SKIP-DASH (WHITE)

SHEET 2 OF 3

ILLINOIS DEPARTMENT OF TRANSPORTATION
URBAN STRIPING DETAILS
 F.A.P. ROUTE 709 (US RTE 136)
 SECTION 113RS-6 & (113BR-2)I
 CHAMPAIGN COUNTY

SCALE: 1" = 20'
 DATE 09/03/04
 DRAWN BY: CADD
 CHECKED BY:

