

F.A.P. RTE.	SECTION	COUNTY	TOTAL SHEETS	SHEET NO.
709	*	CHAMPAIGN	64	52
STA.		TO STA.		
FED. ROAD DIST. NO.	ILLINOIS FED. AID PROJECT			
	* 113RS-6 & (113BR-2)I CONTRACT NO. 70181			

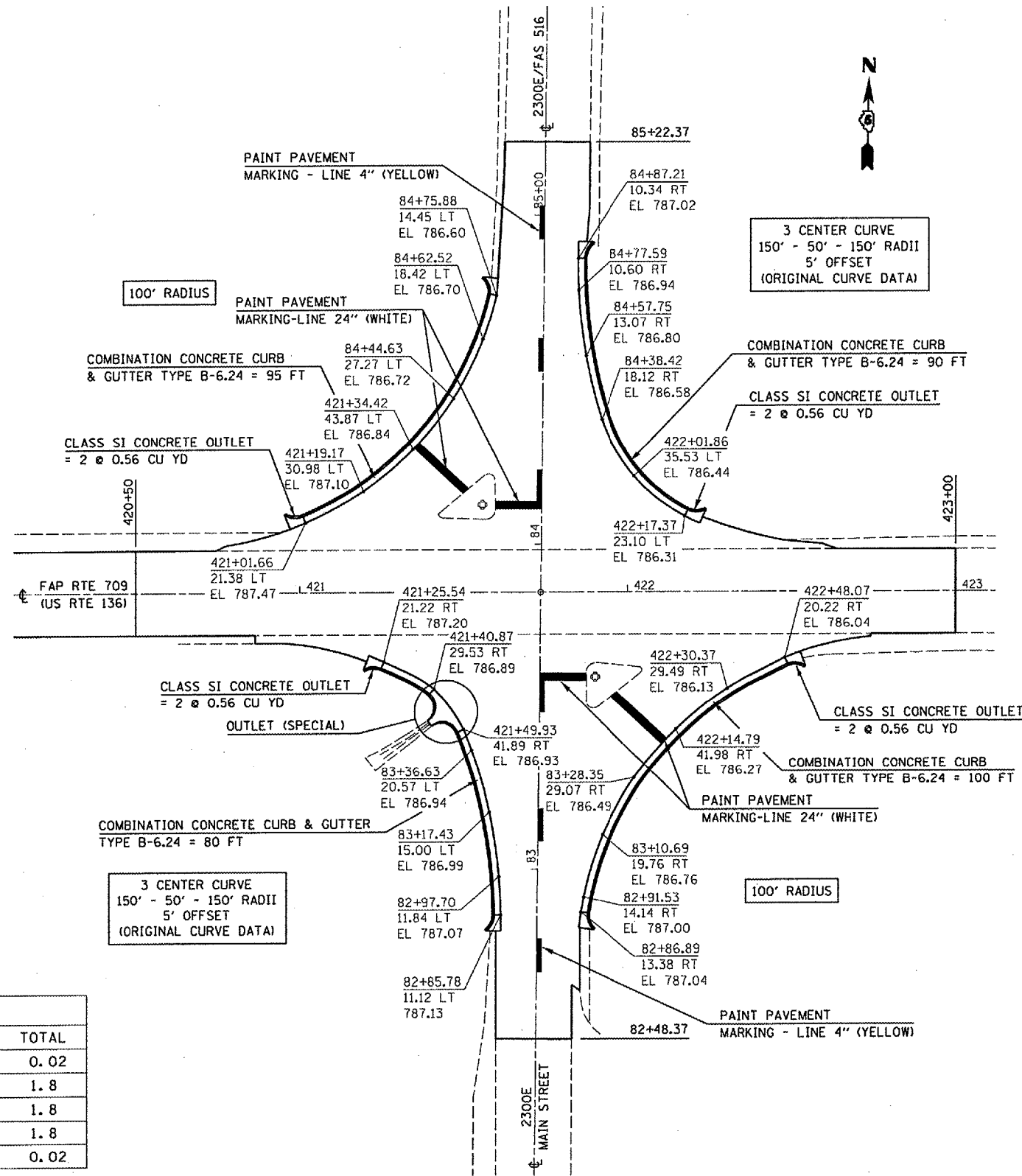

NOTES:

- EXISTING COMBINATION CURB & GUTTER SHALL NOT BE REMOVED; AND COMBINATION CONCRETE CURB & GUTTER TYPE B-6.24 SHALL NOT BE CONSTRUCTED UNTIL THE COMPLETION OF THE BITUMINOUS SURFACE REMOVAL 1/2".
- ALL STATIONS, OFFSETS AND GRADES SHALL BE CHECKED BY ENGINEER IN THE FIELD PRIOR TO CONSTRUCTION. ANY VARIATIONS OCCURRING BETWEEN THE PLANS AND EXISTING CONDITIONS SHALL BE CORRECTED IN THE FIELD AND NO ADDITIONAL COMPENSATION SHALL BE ALLOWED.
- ALL AREAS DISTURBED DURING THE CONSTRUCTION OF THE CURB & GUTTER SHALL BE REPAIRED AND SEEDED ACCORDING TO SECTION 250 OF THE STANDARD SPECIFICATIONS. THIS WORK SHALL BE INCLUDED IN THE CONTRACT UNIT PRICE FOR COMBINATION CONCRETE CURB & GUTTER TYPE B-6.24.

ITEM	UNIT	TOTAL
SEEDING, CLASS 2	ACRE	0.02
NITROGEN FERTILIZER NUTRIENT	POUND	1.8
PHOSPHOROUS FERTILIZER NUTRIENT	POUND	1.8
POTASSIUM FERTILIZER NUTRIENT	POUND	1.8
MULCH, METHOD 2	ACRE	0.02

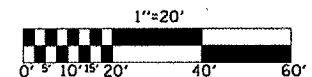

ILLINOIS DEPARTMENT OF TRANSPORTATION  
**INTERSECTION DETAILS**  
 F.A.P. ROUTE 709 (US RTE 136)  
 SECTION 113RS-6 & (113BR-2)I  
 CHAMPAIGN COUNTY  
 SCALE: DATE 09/03/04  
 DRAWN BY: CADD  
 CHECKED BY: