

stefnmk
 10/26/2004
 c:\projects\74048\d02904pa.dgn

2

FAP NO.	SECTION	COUNTY	TOTAL SHEETS	SHEET NO.
821		JEFFERSON	11	6

FED. ROAD DIST. NO. 7 ILLINOIS FED. AID PROJECT NO.
 CONTRACT NO. 74048
 (13-2)RS-2,13ZRS-3

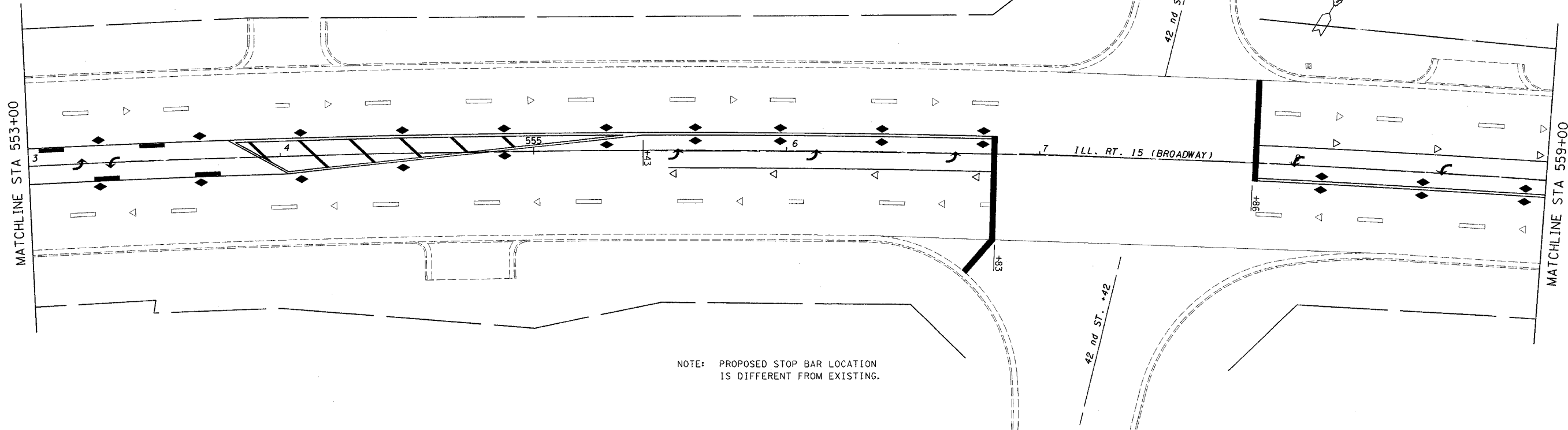

NOTE: PROPOSED STOP BAR LOCATION IS DIFFERENT FROM EXISTING.

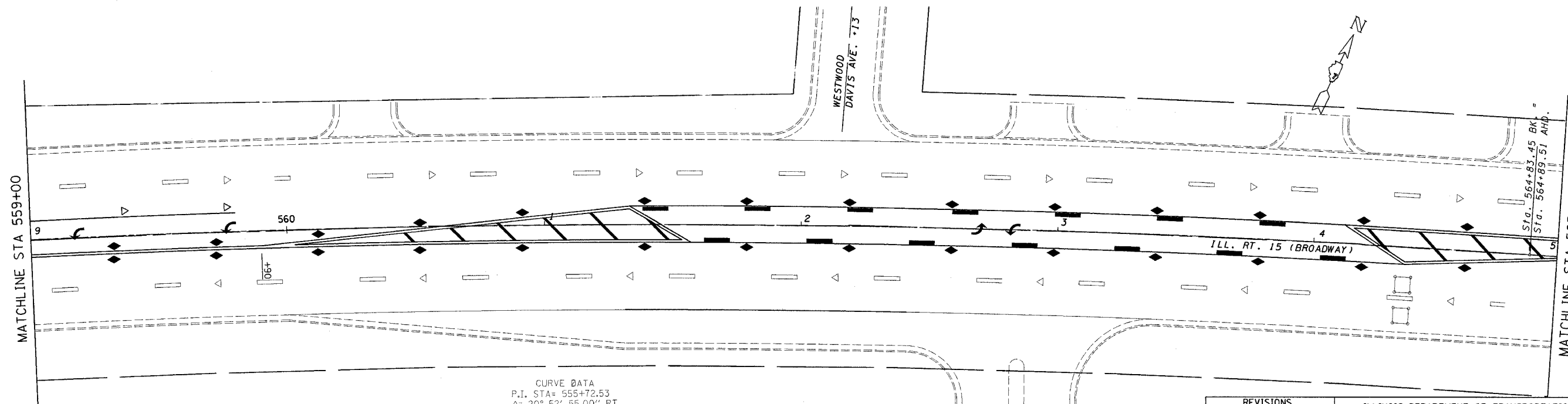

CURVE DATA
 P.I. STA= 555+72.53
 $\Delta= 20^{\circ} 52' 55.00''$ RT
 $D= 1^{\circ} 07' 60.00''$
 R= 5,055.51
 T= 931.60
 L= 1,842.52
 E= 85.12
 S.E.=
 P.C. STA= 546+40.93
 P.T. STA= 564+83.45

REVISIONS	
NAME	DATE

ILLINOIS DEPARTMENT OF TRANSPORTATION

**STA. 553 + 00
 TO
 STA. 565 + 00**

SCALE: VERT.
 HORIZ.
 DATE

DRAWN BY
 CHECKED BY