

steffenmk
10/26/2004
c:\projects\74048\d02\04pe.dgn

FAP No.	SECTION	COUNTY	TOTAL SHEETS	SHEET NO.
821	•	JEFFERSON	//	7
FED. ROAD DIST. NO. 7	ILLINOIS	FED. AID PROJECT NO.		
CONTRACT NO. 74048				
• (13-2)RS-2,13ZRS-3				

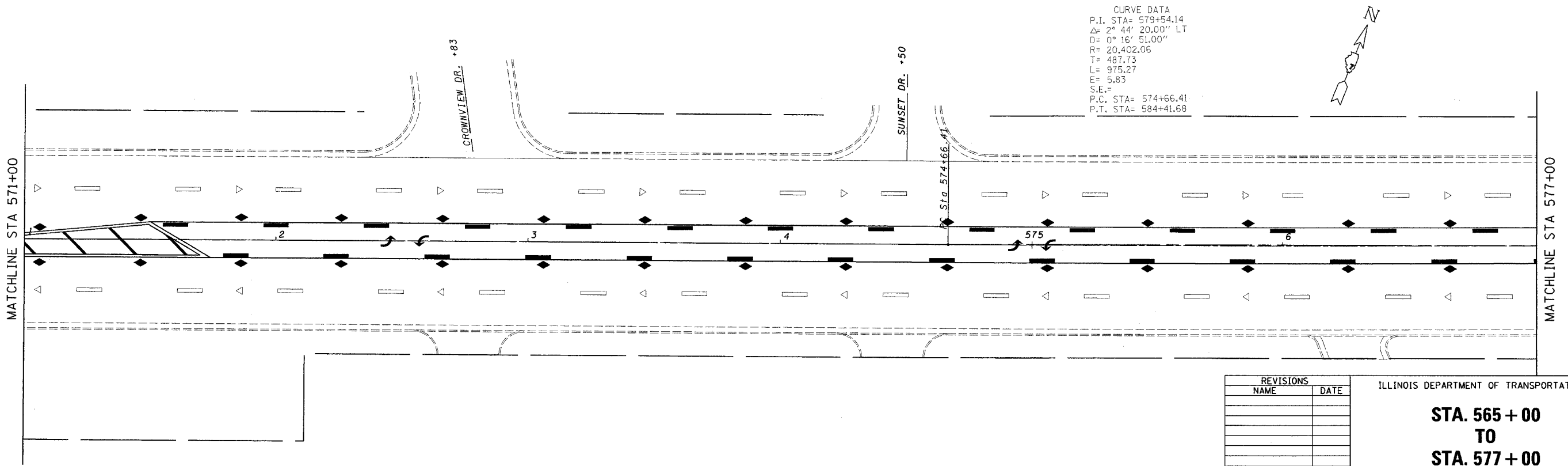
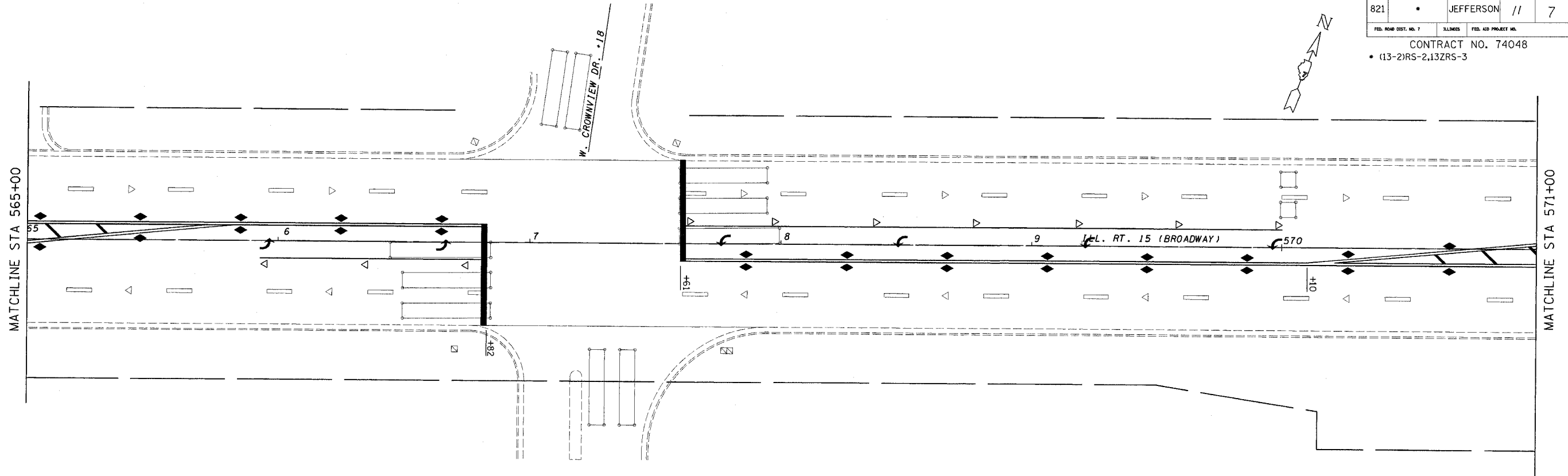

CURVE DATA
P.I. STA= 579+54.14
 Δ = 2° 44' 20.00" LT
D= 0° 16' 51.00"
R= 20,402.06
T= 487.73
L= 975.27
E= 5.83
S.E.=
P.C. STA= 574+66.41
P.T. STA= 584+41.68

REVISIONS	
NAME	DATE

ILLINOIS DEPARTMENT OF TRANSPORTATION

**STA. 565 + 00
TO
STA. 577 + 00**

SCALE: VERT. _____
HORIZ. _____

DATE _____ DRAWN BY _____
CHECKED BY _____