

steffenmk  
 10/26/2004  
 c:\projects\74048\d02904pa.dgn

FAP NO.	SECTION	COUNTY	TOTAL SHEETS	SHEET NO.
821		JEFFERSON	11	9
FED. ROAD DIST. NO. 7		ILLINOIS	FED. AID PROJECT NO.	

CONTRACT NO. 74048  
 (13-2)RS-2,13ZRS-3

CURVE DATA  
 P.I. STA= 590+73.24  
 $\Delta= 12^{\circ} 32' 00.00''$  LT  
 $D= 1^{\circ} 59' 60.00''$   
 $R= 2,864.79$   
 $T= 314.59$   
 $L= 626.67$   
 $E= 17.22$   
 $S.E.=$   
 P.C. STA= 587+58.65  
 P.T. STA= 593+85.32

CURVE DATA  
 P.I. STA= 590+73.24  
 $\Delta= 12^{\circ} 32' 00.00''$  LT  
 $D= 1^{\circ} 59' 60.00''$   
 $R= 2,864.79$   
 $T= 314.59$   
 $L= 626.67$   
 $E= 17.22$   
 $S.E.=$   
 P.C. STA= 587+58.65  
 P.T. STA= 593+85.32

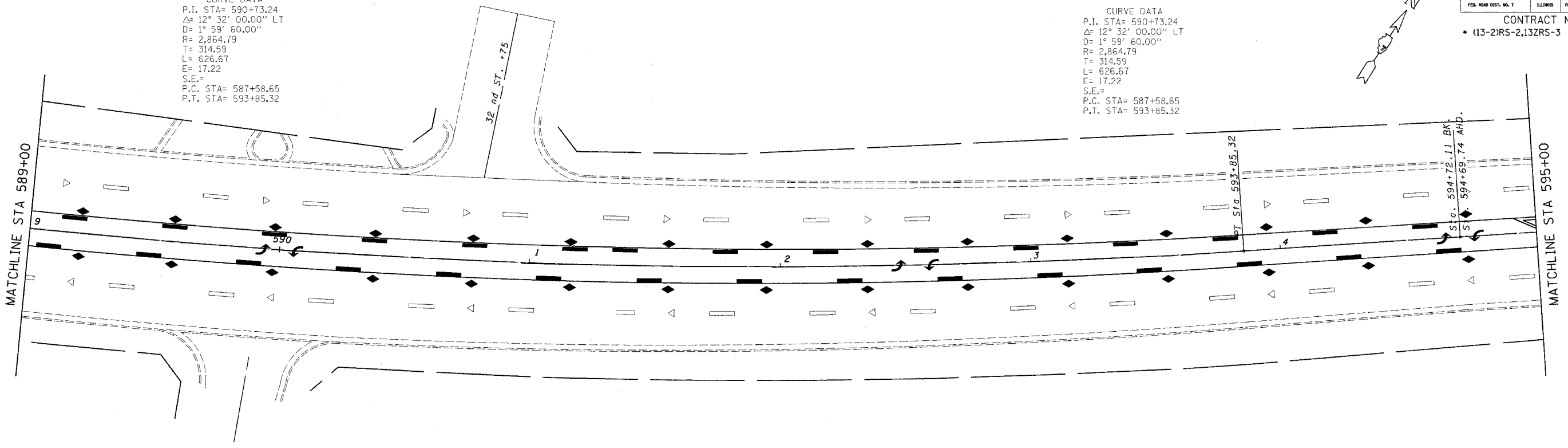

CURVE 5  
 P.I. STA= 600+67.95  
 $\Delta= 9^{\circ} 23' 00.00''$  RT  
 $D= 1^{\circ} 34' 00.00''$   
 $R= 3,657.18$   
 $T= 300.14$   
 $L= 598.94$   
 $E= 12.30$   
 $S.E.=$   
 P.C. STA= 597+67.81  
 P.T. STA= 603+66.75

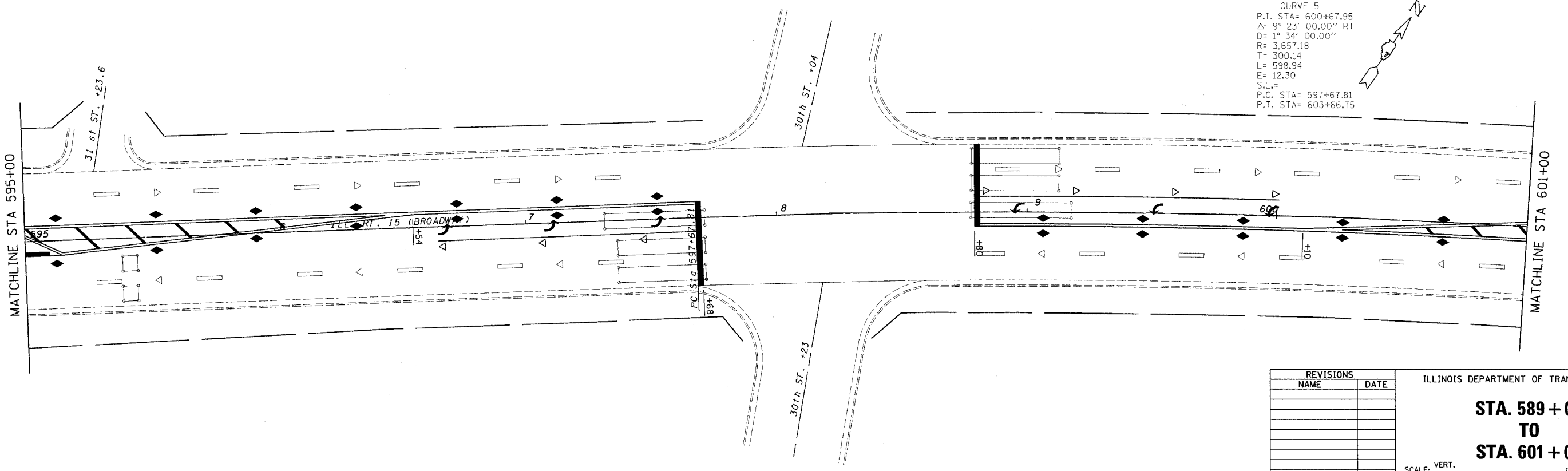

REVISIONS	
NAME	DATE

ILLINOIS DEPARTMENT OF TRANSPORTATION  
**STA. 589 + 00  
 TO  
 STA. 601 + 00**  
 SCALE: VERT.      DRAWN BY  
       HORIZ.        CHECKED BY  
 DATE