

FAP ROUTE	SECTION	COUNTY	TOTAL SHEETS	SHEET NO.
312	71BR	RANDOLPH	1	73

CONTRACT NO.: 76125

D-98-011-00

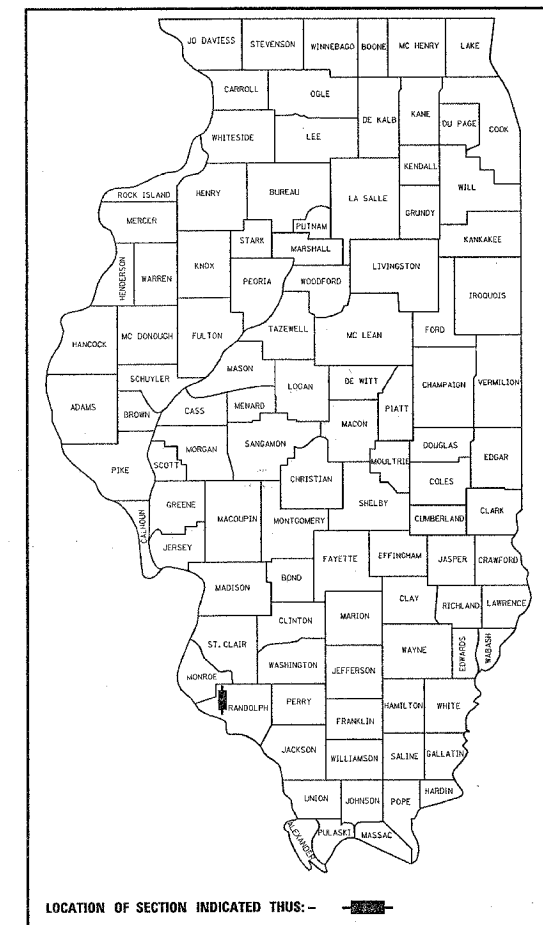

LOCATION OF SECTION INDICATED THUS:

**STATE OF ILLINOIS
DEPARTMENT OF TRANSPORTATION
DIVISION OF HIGHWAYS**

**PLANS FOR PROPOSED
FEDERAL AID HIGHWAY**

**FAP ROUTE 312 (IL 003)
SECTION 71BR
PROJECT NUMBER: BRF-0312(028)
BRIDGE REPLACEMENT OVER HORSE CREEK
1.5 MI. NORTH OF RUMA
RANDOLPH COUNTY**

C-98-096-01

INDEX OF SHEETS

- 1 COVER SHEET AND LIST OF STANDARDS
- 2 GENERAL NOTES, COMMITMENTS, AND MIXTURE CHART
- 3-4 SUMMARY OF QUANTITIES
- 5-7 TYPICAL SECTIONS
- 8-9 SCHEDULES
- 10-12 PLAN AND PROFILE SHEETS
- 13 WIDE LOAD SIGNING
- 14-22 STAGING PLANS
- 23-24 STORM WATER POLLUTION PREVENTION PLAN
- 25-55 BRIDGE PLANS
- 56 SIDEROAD DETAIL
- 57 REMOVAL PLAN SHEETS
- 58-59 DETAILS
- 60 PAVEMENT MARKING
- 61-73 CROSS SECTIONS

LIST OF STANDARDS

000001-04	635006-02	000001-04	720006
420401-05	635011-01	701301-02	720011
482011-01	701001-01	701306-01	729001
609006-02	701006-02	701311-02	780001-01
630001-05	701011-01	701321-02	781001-02
631011-02	701201-02	701326-02	
631031-05	701206-01	720001	

MICROFILMED _____
REEL NUMBER _____
AWARDED _____
RESIDENT ENGINEER _____
AS BUILT CHANGES WERE MADE
ON THE FOLLOWING SHEETS

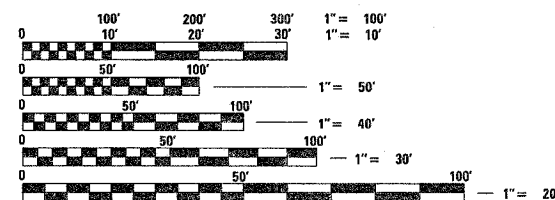

FULL SIZE PLANS HAVE BEEN PREPARED USING STANDARD ENGINEERING SCALES, REDUCED SIZED PLANS WILL NOT CONFORM TO STANDARD SCALES, IN MAKING MEASUREMENTS ON REDUCED PLANS, THE ABOVE SCALES MAY BE USED.

J.U.L.I.E.
JOINT UTILITY LOCATION INFORMATION FOR EXCAVATION
1-800-892-0123

CONTRACT NO. 76125

DESIGN DESIGNATION
OTHER PRINCIPAL ARTERIAL

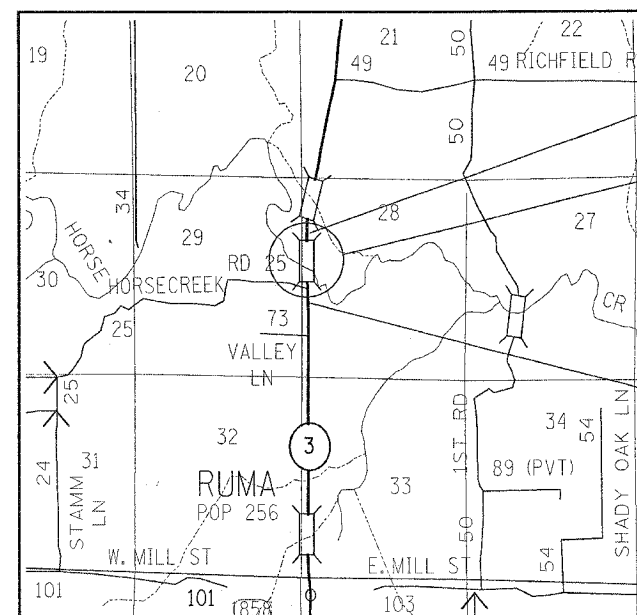

NOT TO SCALE

GROSS PROJECT LENGTH = 960 FT = .18 MILES
NET PROJECT LENGTH = 960 FT = .18 MILES

BEGIN PROJECT
STA. 1124 + 31.1

BRIDGE REPLACEMENT
STA. 1128 + 90.00
EXIST. STRUCTURE NO. 079-0003
PROP. STRUCTURE NO. 079-0048
LATITUDE: 381570
LONGITUDE: -89.99831

END PROJECT
STA. 1133 + 90.9

GROSS LENGTH: 0.12 MILES (653.40 FT.)
NET LENGTH: 0.12 MILES (653.40 FT.)

ADT	
2005	6100
2015	7000
2025	8200
S.U.	13.4%
M.U.	5.6%

**STATE OF ILLINOIS
DEPARTMENT OF TRANSPORTATION
DIVISION OF HIGHWAYS**

SUBMITTED Dec 21, 2004

Mark C. Lomis
DEPUTY DIRECTOR OF HIGHWAYS
REGION FIVE ENGINEER

February 4, 2005
Mike Shire
ENGINEER OF DESIGN AND ENVIRONMENT

February 4, 2005
Victor M. Decker
DIRECTOR, DIVISION OF HIGHWAYS

PRINTED BY THE AUTHORITY OF THE STATE OF ILLINOIS

**PROJECT ENGINEER: PATTI LEBEAU (618) 346-3179
SQUAD CONTACT: ART MUEHLFELD (618) 346-3209**