

F.A.I. ROUTE	SECTION	COUNTY	TOTAL SHEETS	SHEET NO.
80-55-99-10(K,BY&AC-B)	WILL		497	30
STA. TO STA.		FED. AID PROJECT		
FED. ROAD DIST. NO. 1		ILLINOIS		
CONTRACT NO. 80906				

CURVE DATA RAMP A

PROP. CURVE RAMP A-1
 PI STA. = 21+78.40
 $\Delta = 43^\circ 11' 06''$ (RT)
 $D = 5^\circ 05' 35''$
 $R = 1,125.00'$
 $T = 445.25'$
 $L = 847.94'$
 $E = 84.91'$
 P.C. STA. = 17+33.16
 P.T. STA. = 25+81.09

PROP. CURVE RAMP A-2
 PI STA. = 37+03.27
 $\Delta = 37^\circ 27' 28''$ (RT)
 $D = 2^\circ 54' 32''$
 $R = 1,969.66'$
 $T = 667.80'$
 $L = 1,287.68'$
 $E = 110.13'$
 P.C. STA. = 30+35.47
 P.C.C. STA. = 43+23.15

PROP. CURVE RAMP A-3
 PI STA. = 44+73.02
 $\Delta = 4^\circ 54' 11''$ (RT)
 $D = 1^\circ 38' 12''$
 $R = 3,500.49'$
 $T = 149.86'$
 $L = 299.55'$
 $E = 3.21'$
 P.C.C. STA. = 43+23.15
 P.T. STA. = 46+22.70

CURVE DATA WEST FRONTAGE ROAD

PROP. CURVE WFR-4
 PI STA. = 42+33.47
 $\Delta = 82^\circ 18' 43''$ (LT)
 $D = 20^\circ 50' 05''$
 $R = 275.00'$
 $T = 240.37'$
 $L = 395.07'$
 $E = 90.24'$
 P.C. STA. = 39+93.10
 P.T. STA. = 43+88.16

CURVE DATA NORTHEAST FRONTAGE ROAD

PROP. CURVE NEFRONT-1
 PI STA. = 111+14.84
 $\Delta = 1^\circ 31' 20''$ (RT)
 $D = 1^\circ 08' 45''$
 $R = 5,000.00'$
 $T = 66.43'$
 $L = 132.84'$
 $E = 0.44'$
 P.C. STA. = 110+48.42
 P.T. STA. = 111+81.26

CURVE DATA RAMP B

PROP. CURVE RAMP B-1
 PI STA. = 0+91.85
 $\Delta = 12^\circ 20' 07''$ (RT)
 $D = 6^\circ 44' 26''$
 $R = 850.00'$
 $T = 91.85'$
 $L = 183.00'$
 $E = 4.95'$
 P.C. STA. = 0+00.00
 P.C.C. STA. = 1+83.00

PROP. CURVE RAMP B-2
 PI STA. = 2+53.44
 $\Delta = 15^\circ 43' 42''$ (RT)
 $D = 11^\circ 14' 03''$
 $R = 510.02'$
 $T = 70.45'$
 $L = 140.01'$
 $E = 4.84'$
 P.C.C. STA. = 1+83.00
 P.C.C. STA. = 3+23.00

PROP. CURVE RAMP B-3
 PI STA. = 7+49.57
 $\Delta = 114^\circ 47' 40''$ (RT)
 $D = 21^\circ 00' 03''$
 $R = 272.83'$
 $T = 426.56'$
 $L = 546.62'$
 $E = 233.52'$
 P.C.C. STA. = 3+23.00
 P.C.C. STA. = 8+69.62

PROP. CURVE RAMP B-4
 PI STA. = 12+54.19
 $\Delta = 98^\circ 43' 58''$ (RT)
 $D = 17^\circ 21' 44''$
 $R = 330.00'$
 $T = 384.57'$
 $L = 568.67'$
 $E = 176.74'$
 P.C.C. STA. = 8+69.62
 P.C.C. STA. = 14+38.29

PROP. CURVE RAMP B-5
 PI STA. = 15+67.25
 $\Delta = 28^\circ 22' 51''$ (RT)
 $D = 11^\circ 14' 05''$
 $R = 509.99'$
 $T = 128.95'$
 $L = 252.61'$
 $E = 16.05'$
 P.C.C. STA. = 14+38.29
 P.T. STA. = 16+90.91

CURVE DATA TEMPORARY RAMP B

PROP. CURVE T-RBEN-1
 PI STA. = 14+66.51
 $\Delta = 67^\circ 31' 02''$ (RT)
 $D = 29^\circ 18' 03''$
 $R = 195.54'$
 $T = 130.70'$
 $L = 230.43'$
 $E = 39.66'$
 P.C. STA. = 13+35.81
 P.T. STA. = 15+66.24

NOTE:
 - SEE SHEET NO. 36 FOR POINT COORDINATES AND CONSTRUCTION STAKE OUT INFORMATION.
 SEE SHEET NO. 34 FOR SUPERELEVATION TRANSITION PAVEMENT ELEVATIONS.

CURVE DATA FAI-80

PROP. CURVE FAI80-1
 PI STA. = 1928+14.09
 $\Delta = 4^\circ 33' 08''$ (LT)
 $D = 0^\circ 45' 00''$
 $R = 7,638.78'$
 $T = 303.62'$
 $L = 606.93'$
 $E = 6.03'$
 P.C. STA. = 1925+10.47
 P.T. STA. = 1931+17.39

PROP. CURVE FAI80-2
 PI STA. = 1942+45.29
 $\Delta = 3^\circ 45' 33''$ (RT)
 $D = 0^\circ 45' 00''$
 $R = 7,639.44'$
 $T = 250.70'$
 $L = 501.23'$
 $E = 4.11'$
 P.C. STA. = 1939+94.59
 P.T. STA. = 1944+95.82

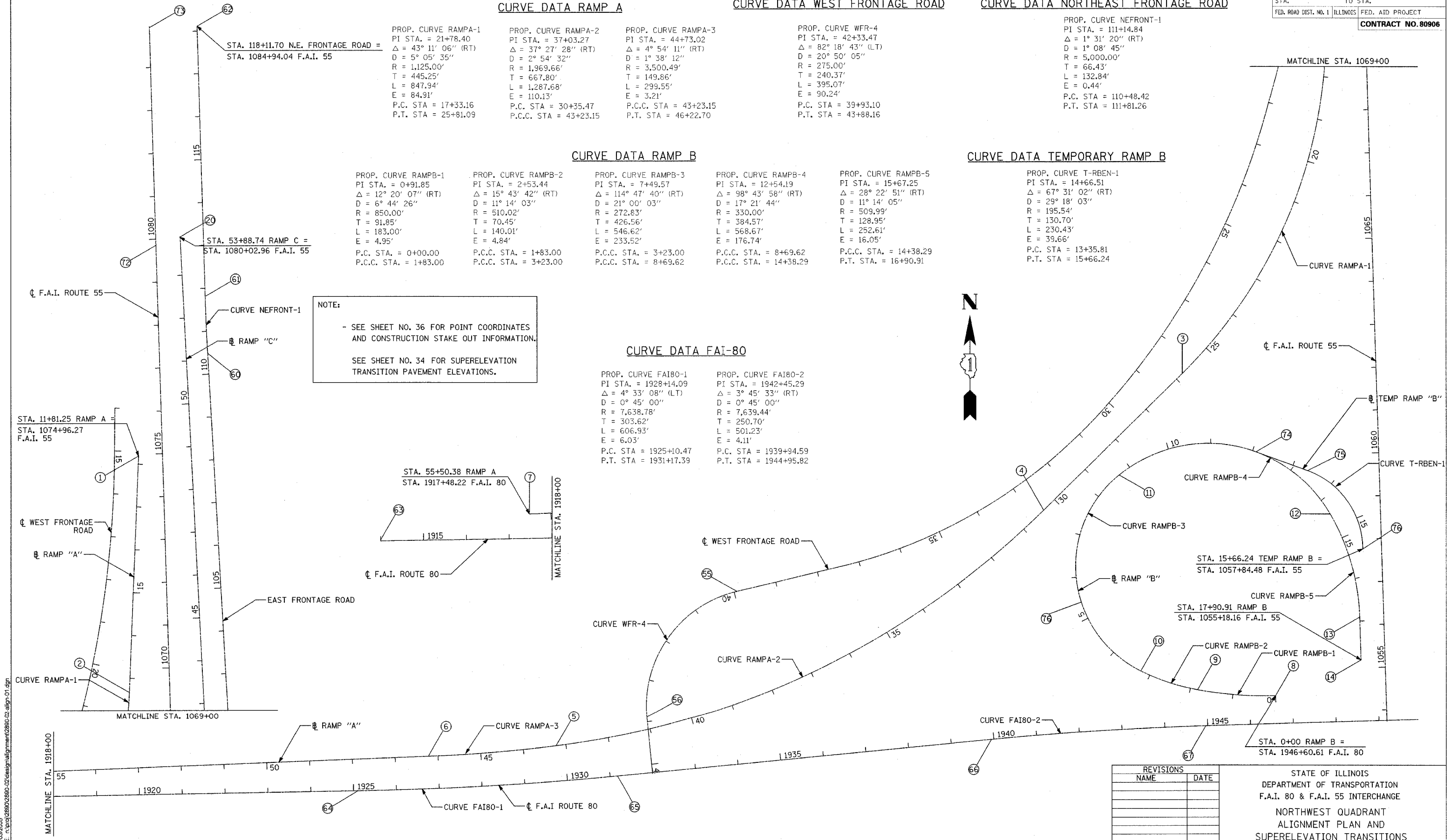

DATE: 01/03/2005
 FILENAME: n:\proj\28892886.dwg\design\alignment\2889.dwg\align.dwg

REVISIONS	
NAME	DATE

STATE OF ILLINOIS
 DEPARTMENT OF TRANSPORTATION
 F.A.I. 80 & F.A.I. 55 INTERCHANGE
 NORTHWEST QUADRANT
 ALIGNMENT PLAN AND
 SUPERELEVATION TRANSITIONS

SCALE: 1" = 100'
 DATE: JANUARY, 2005
 DRAWN BY: KMS
 CHECKED BY: MJL