

F.A.I. ROUTE	SECTION	COUNTY	TOTAL SHEETS	SHEET NO.
80-55	99-1(K, BY&AC-B)	WILL	497	31
STA.	TO STA.			
FED. ROAD DIST. NO. 1	ILLINOIS	FED. AID PROJECT		
CONTRACT NO. 80906				

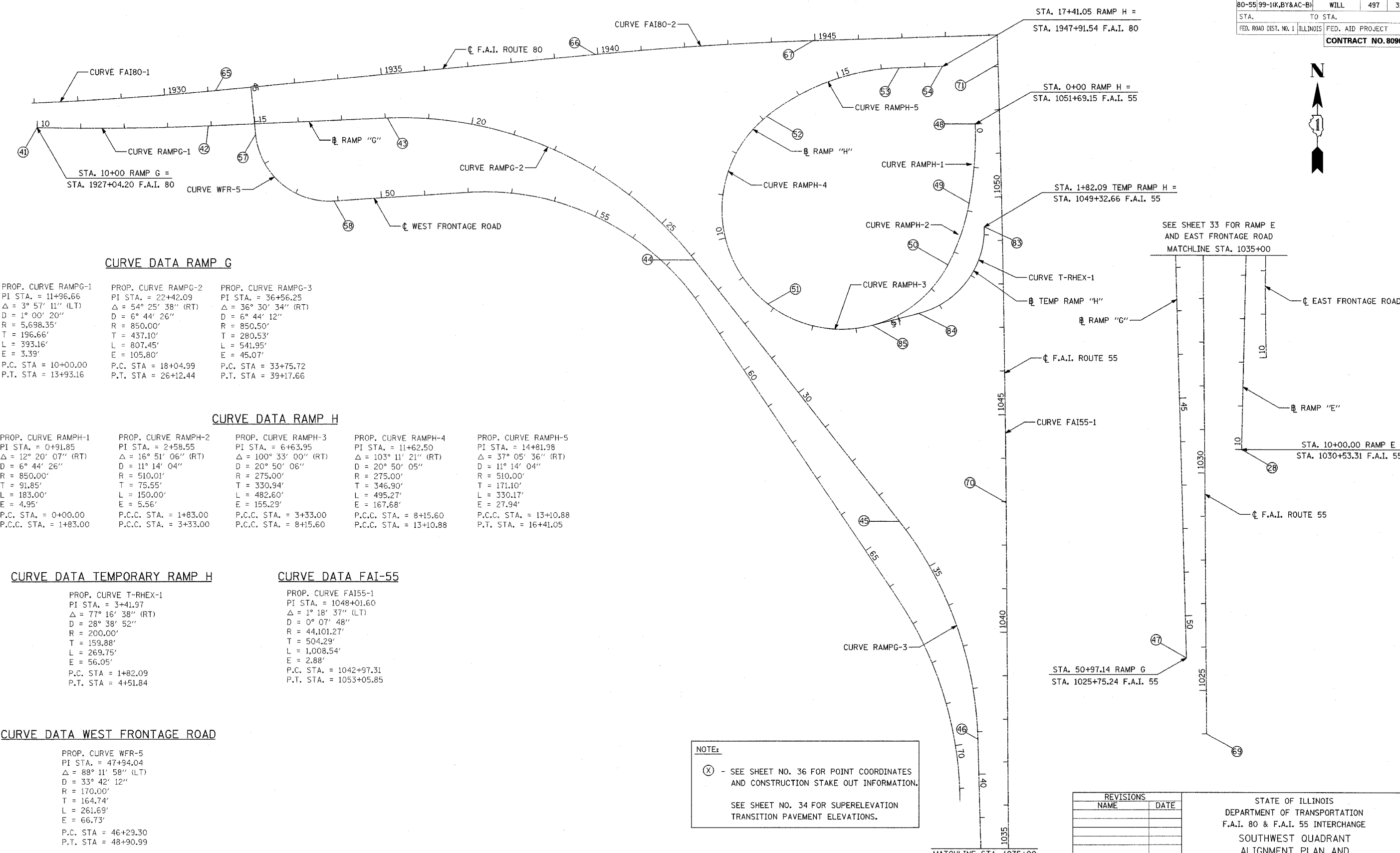

CURVE DATA RAMP G

PROP. CURVE RAMPG-1 PI STA. = 11+96.66 Δ = 3° 57' 11" (LT) D = 1° 00' 20" R = 5,698.35' T = 196.66' L = 393.16' E = 3.39' P.C. STA. = 10+00.00 P.T. STA. = 13+93.16	PROP. CURVE RAMPG-2 PI STA. = 22+42.09 Δ = 54° 25' 38" (RT) D = 6° 44' 26" R = 850.00' T = 437.10' L = 807.45' E = 105.80' P.C. STA. = 18+04.99 P.T. STA. = 26+12.44	PROP. CURVE RAMPG-3 PI STA. = 36+56.25 Δ = 36° 30' 34" (RT) D = 6° 44' 12" R = 850.50' T = 280.53' L = 541.95' E = 45.07' P.C. STA. = 33+75.72 P.T. STA. = 39+17.66
--	---	--

CURVE DATA RAMP H

PROP. CURVE RAMPH-1 PI STA. = 0+91.85 Δ = 12° 20' 07" (RT) D = 6° 44' 26" R = 850.00' T = 91.85' L = 183.00' E = 4.95' P.C. STA. = 0+00.00 P.C.C. STA. = 1+83.00	PROP. CURVE RAMPH-2 PI STA. = 2+58.55 Δ = 16° 51' 06" (RT) D = 11° 14' 04" R = 510.01' T = 75.55' L = 150.00' E = 5.56' P.C.C. STA. = 1+83.00 P.C.C. STA. = 3+33.00	PROP. CURVE RAMPH-3 PI STA. = 6+63.95 Δ = 100° 33' 00" (RT) D = 20° 50' 06" R = 275.00' T = 330.94' L = 482.60' E = 155.29' P.C.C. STA. = 3+33.00 P.C.C. STA. = 8+15.60	PROP. CURVE RAMPH-4 PI STA. = 11+62.50 Δ = 103° 11' 21" (RT) D = 20° 50' 05" R = 275.00' T = 346.90' L = 495.27' E = 167.68' P.C.C. STA. = 8+15.60 P.C.C. STA. = 13+10.88	PROP. CURVE RAMPH-5 PI STA. = 14+81.98 Δ = 37° 05' 36" (RT) D = 11° 14' 04" R = 510.00' T = 171.10' L = 330.17' E = 27.94' P.C.C. STA. = 13+10.88 P.T. STA. = 16+41.05
---	--	--	--	---

CURVE DATA TEMPORARY RAMP H

PROP. CURVE T-RHEX-1 PI STA. = 3+41.97 Δ = 77° 16' 38" (RT) D = 28° 38' 52" R = 200.00' T = 159.88' L = 269.75' E = 56.05' P.C. STA. = 1+82.09 P.T. STA. = 4+51.84

CURVE DATA FAI-55

PROP. CURVE FAI55-1 PI STA. = 1048+01.60 Δ = 1° 18' 37" (LT) D = 0° 07' 48" R = 44,101.27' T = 504.29' L = 1,008.54' E = 2.88' P.C. STA. = 1042+97.31 P.T. STA. = 1053+05.85

CURVE DATA WEST FRONTAGE ROAD

PROP. CURVE WFR-5 PI STA. = 47+94.04 Δ = 88° 11' 58" (LT) D = 33° 42' 12" R = 170.00' T = 164.74' L = 261.69' E = 66.73' P.C. STA. = 46+29.30 P.T. STA. = 48+90.99

NOTE:
 (X) - SEE SHEET NO. 36 FOR POINT COORDINATES AND CONSTRUCTION STAKE OUT INFORMATION.
 SEE SHEET NO. 34 FOR SUPERELEVATION TRANSITION PAVEMENT ELEVATIONS.

REVISIONS	
NAME	DATE

STATE OF ILLINOIS
 DEPARTMENT OF TRANSPORTATION
 F.A.I. 80 & F.A.I. 55 INTERCHANGE
 SOUTHWEST QUADRANT
 ALIGNMENT PLAN AND
 SUPERELEVATION TRANSITIONS
 SCALE: 1" = 100'
 DATE: JANUARY, 2005
 DRAWN BY: KMS
 CHECKED BY: MJL

DATE: 01/03/2005
 FILENAME: n:\proj\28902860-02\design\plan\2890-02-align-02.dgn