

F.A.I. ROUTE	SECTION	COUNTY	TOTAL SHEETS	SHEET NO.
80-55	99-1(K, BY&AC-B)	WILL	497	32
STA.	TO STA.			
FED. ROAD DIST. NO. 1 ILLINOIS FED. AID PROJECT				
CONTRACT NO. 80906				

CURVE DATA RAMP C

PROP. CURVE RAMPC-1
 PI STA. = 19+78.69
 $\Delta = 23^\circ 39' 01''$ (RT)
 $D = 6^\circ 44' 26''$
 $R = 850.00'$
 $T = 177.96'$
 $L = 350.86'$
 $E = 18.43'$
 P.C. STA. = 18+00.73
 P.T. STA. = 21+51.59

PROP. CURVE RAMPC-2
 PI STA. = 37+93.51
 $\Delta = 62^\circ 08' 06''$ (RT)
 $D = 6^\circ 24' 06''$
 $R = 895.00'$
 $T = 539.21'$
 $L = 970.59'$
 $E = 149.88'$
 P.C. STA. = 32+54.30
 P.T. STA. = 42+24.89

CURVE DATA RAMP D

PROP. CURVE RAMPD-1
 PI STA. = 0+91.86
 $\Delta = 12^\circ 20' 08''$ (RT)
 $D = 6^\circ 44' 26''$
 $R = 850.00'$
 $T = 91.86'$
 $L = 183.00'$
 $E = 4.95'$
 P.C. STA. = 0+00.00
 P.C.C. STA. = 1+83.00

PROP. CURVE RAMPD-2
 PI STA. = 2+58.52
 $\Delta = 16^\circ 51' 07''$ (RT)
 $D = 11^\circ 14' 19''$
 $R = 509.81'$
 $T = 75.52'$
 $L = 149.95'$
 $E = 5.56'$
 P.C.C. STA. = 1+83.00
 P.C.C. STA. = 3+32.95

PROP. CURVE RAMPD-3
 PI STA. = 6+40.80
 $\Delta = 95^\circ 12' 06''$ (RT)
 $D = 20^\circ 22' 56''$
 $R = 281.11'$
 $T = 307.86'$
 $L = 467.08'$
 $E = 135.78'$
 P.C.C. STA. = 3+32.95
 P.C.C. STA. = 8+00.03

PROP. CURVE RAMPD-4
 PI STA. = 11+78.98
 $\Delta = 106^\circ 52' 55''$ (RT)
 $D = 20^\circ 23' 19''$
 $R = 281.02'$
 $T = 378.96'$
 $L = 524.22'$
 $E = 190.76'$
 P.C.C. STA. = 8+00.03
 P.C.C. STA. = 13+24.25

PROP. CURVE RAMPD-5
 PI STA. = 15+03.21
 $\Delta = 38^\circ 44' 27''$ (RT)
 $D = 11^\circ 15' 21''$
 $R = 509.03'$
 $T = 178.96'$
 $L = 344.19'$
 $E = 30.54'$
 P.C.C. STA. = 13+24.25
 P.T. STA. = 16+68.43

CURVE DATA TEMPORARY RAMP D

PROP. CURVE T-RDEX-1
 PI STA. = 3+27.86
 $\Delta = 73^\circ 11' 52''$ (RT)
 $D = 28^\circ 38' 52''$
 $R = 200.00'$
 $T = 148.53'$
 $L = 255.51'$
 $E = 49.12'$
 P.C. STA. = 1+79.33
 P.T. STA. = 4+34.84

NOTE:
 (X) - SEE SHEET NO. 36 FOR POINT COORDINATES AND CONSTRUCTION STAKE OUT INFORMATION.
 SEE SHEET NO. 34 FOR SUPERELEVATION TRANSITION PAVEMENT ELEVATIONS.

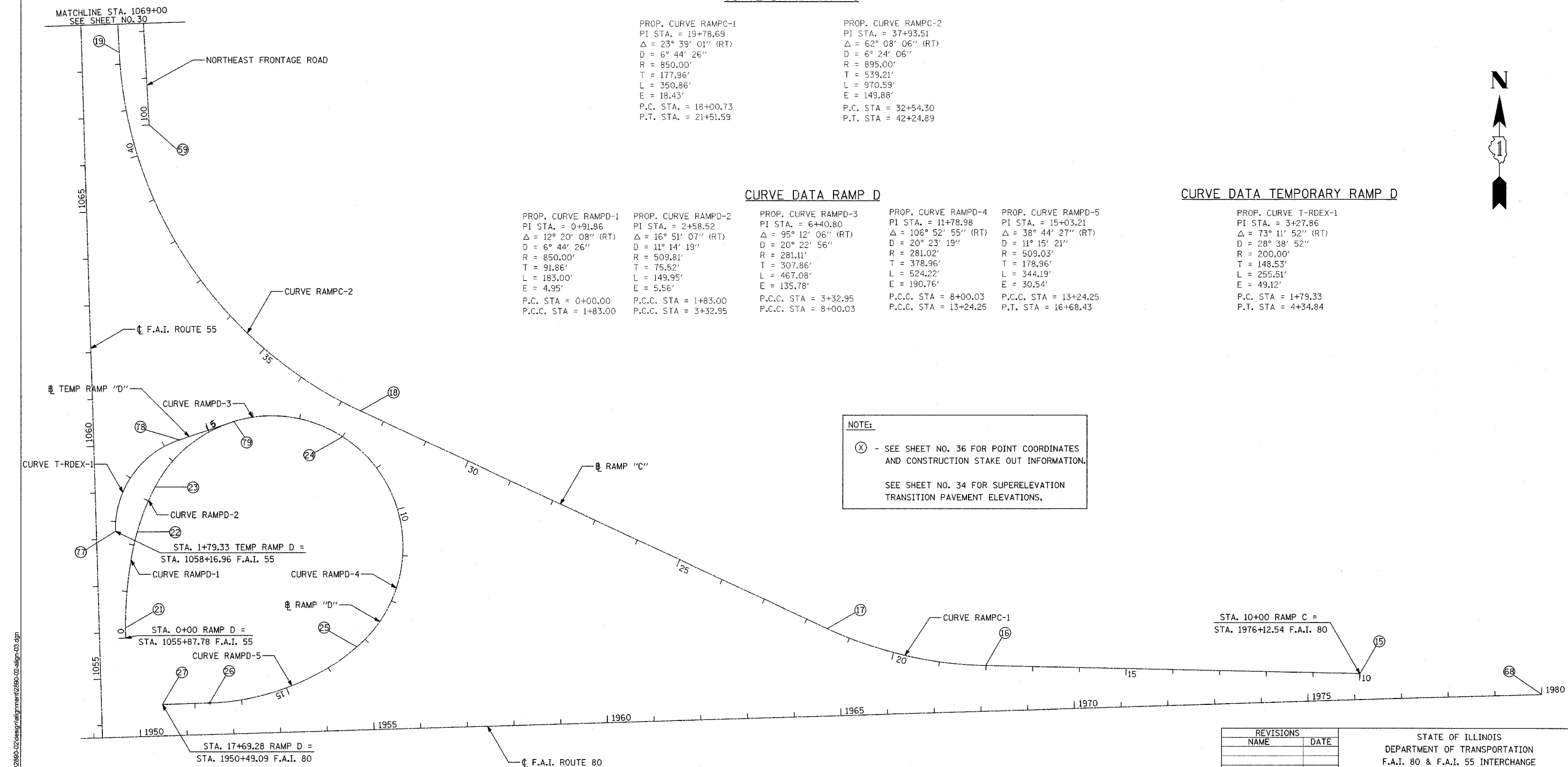

DATE: 01/03/2005
 FILENAME: n:\proj\28902860-02\design\alignment\2890-02-align-03.dgn

REVISIONS	
NAME	DATE

STATE OF ILLINOIS
 DEPARTMENT OF TRANSPORTATION
 F.A.I. 80 & F.A.I. 55 INTERCHANGE
 NORTHEAST QUADRANT
 ALIGNMENT PLAN AND
 SUPERELEVATION TRANSITIONS
 SCALE: 1" = 100'
 DATE: JANUARY, 2005
 DRAWN BY: KMS
 CHECKED BY: MJL