

F.A.I. ROUTE	SECTION	COUNTY	TOTAL SHEETS	SHEET NO.
80-55	99-1(K, BY&AC-B)	WILL	497	42
STA. 1964+50	TO STA. 1980+00			
FED. ROAD DIST. NO. 1	ILLINOIS	FED. AID PROJECT		
<b>CONTRACT NO. 80906</b>				

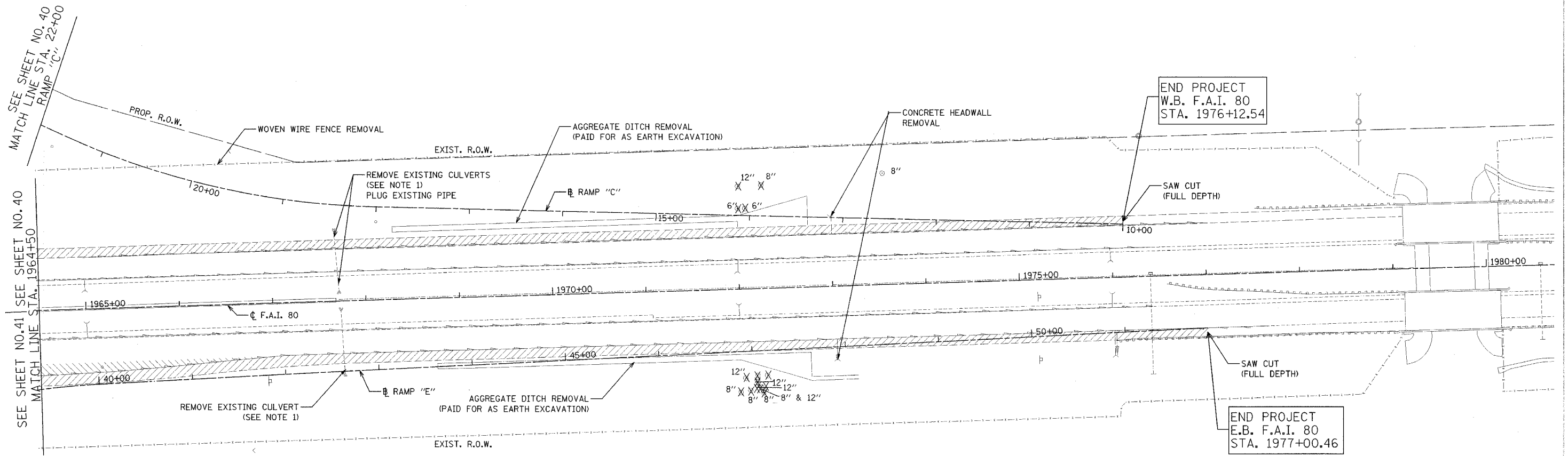

- LEGEND**
- BITUMINOUS SHOULDER REMOVAL
  - PAVEMENT REMOVAL
  - TREE REMOVAL

**NOTE:**  
 1. PARTIAL REMOVAL. SEE SCHEDULE FOR STATIONS AND LENGTH.



DATE: 01/19/2005  
 FILENAME: \\p103\2680\2680-02\design\removal\2680-02-removal-08.dgn

REVISIONS	
NAME	DATE

STATE OF ILLINOIS  
 DEPARTMENT OF TRANSPORTATION  
 F.A.I. 80 & F.A.I. 55 INTERCHANGE  
**EXISTING CONDITIONS, UTILITIES  
 & REMOVAL ITEMS**  
 F.A.I. 80, RAMPS "C" & "E"

SCALE: 1"=50'  
 DATE: JANUARY, 2005

DRAWN BY: BWS  
 CHECKED BY: MJL