

F.A. RTE.	SECTION	COUNTY	TOTAL SHEETS	SHEET NO.
80-5599-1(K, BY&AC-B)	WILL	ILLINOIS	497	67
STA. 38+00		TO STA. 50+97.13		RAMP "G"
FED. ROAD DIST. NO. ILLINOIS FED. AID PROJECT				
CONTRACT NO. 80906				

RAMP "G" PROFILE

ENTRANCE TERMINAL
SEE SHEET NO. 165 FOR
DETAILS AND ELEVATIONS

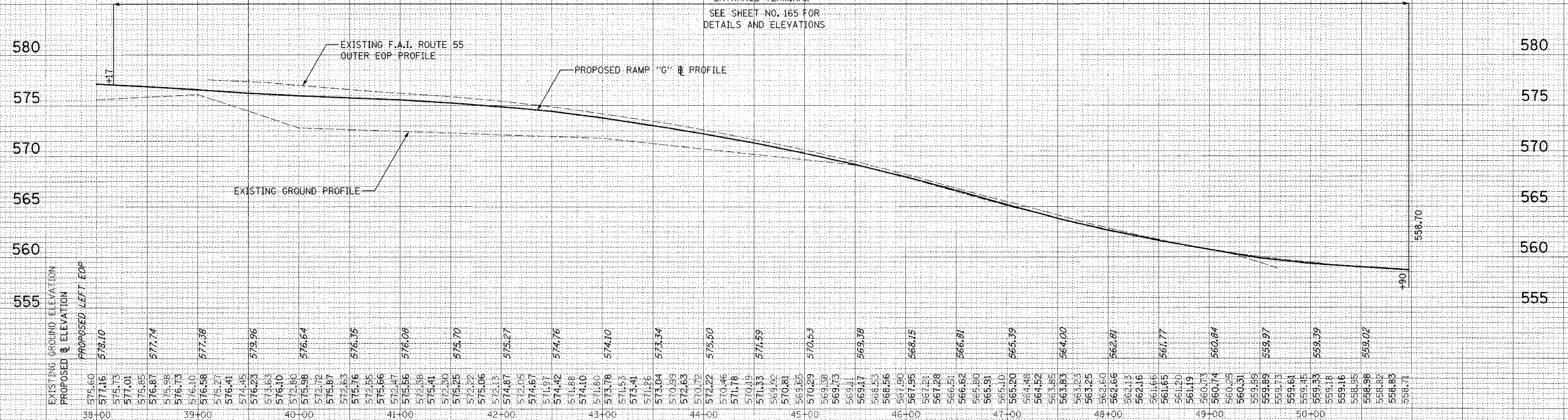

SCALE: 1" = 50' HORIZONTAL
1" = 5' VERTICAL

DATE: 01/03/2006
FILENAME: I:\proj\80906\80906.dwg