

F.A.I. ROUTE	SECTION	COUNTY	TOTAL SHEETS	SHEET NO.
80-55	99-1K, BY&AC-B1	WILL	497	81
STA. 1972+00		TO STA. 2143+00		
FED. ROAD DIST. NO. 1		ILLINOIS		FED. AID PROJECT
CONTRACT NO. 80906				



NOTES

1. RAISED PAVEMENT REFLECTOR LENS WHICH CONFLICT WITH TEMPORARY PAVEMENT MARKINGS SHALL BE REMOVED. THIS WORK SHALL BE INCLUDED IN THE COST OF THE CONTRACT UNIT PRICE FOR REPLACEMENT REFLECTORS.
2. SEE STATE STANDARD 701411 FOR APPLICABLE RAMP SIGNING AND BARRICADE PLACEMENT IN ADDITION TO THE TRAFFIC CONTROL ITEMS SHOWN ON THIS SHEET.

LEGEND

- 1 DRUM WITH STEADY BURNING LIGHT
- 2 PAVEMENT MARKING TAPE, TYPE III - (4 INCH), YELLOW
- 3 PAVEMENT MARKING TAPE, TYPE III - (4 INCH), WHITE
- 4 PAVEMENT MARKING TAPE, TYPE III - (5 INCH), WHITE
- 5 PAVEMENT MARKING TAPE, TYPE III - (8 INCH), WHITE
- 6 PAVEMENT MARKING TAPE, TYPE III - (12 INCH), WHITE
- 7 PAVEMENT MARKING REMOVAL (LINE)

- VERTICAL PANELS WITH STEADY BURNING MONO DIRECTIONAL LIGHTS
- WORK ZONE
- DIRECTION OF TRAFFIC
- CONSTRUCTION SIGN
- DIRECTIONAL BARRICADE
- TYPE III BARRICADE WITH ATTACHED SIGN PANEL
- PORTABLE CHANGEABLE MESSAGE SIGN
- DRUMS WITH STEADY BURNING MONO DIRECTIONAL LIGHTS

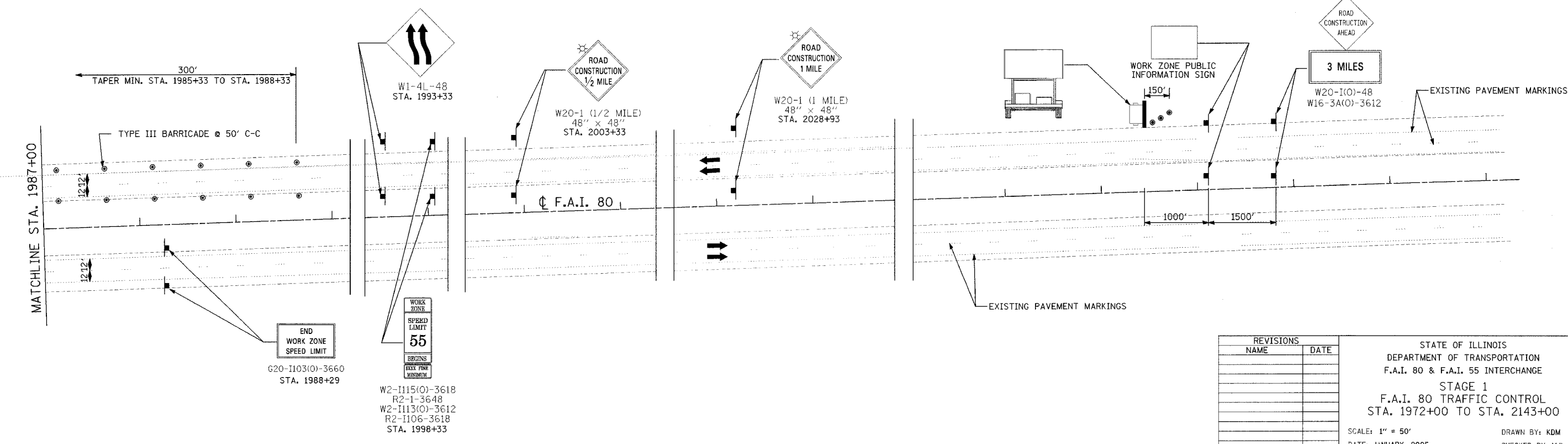
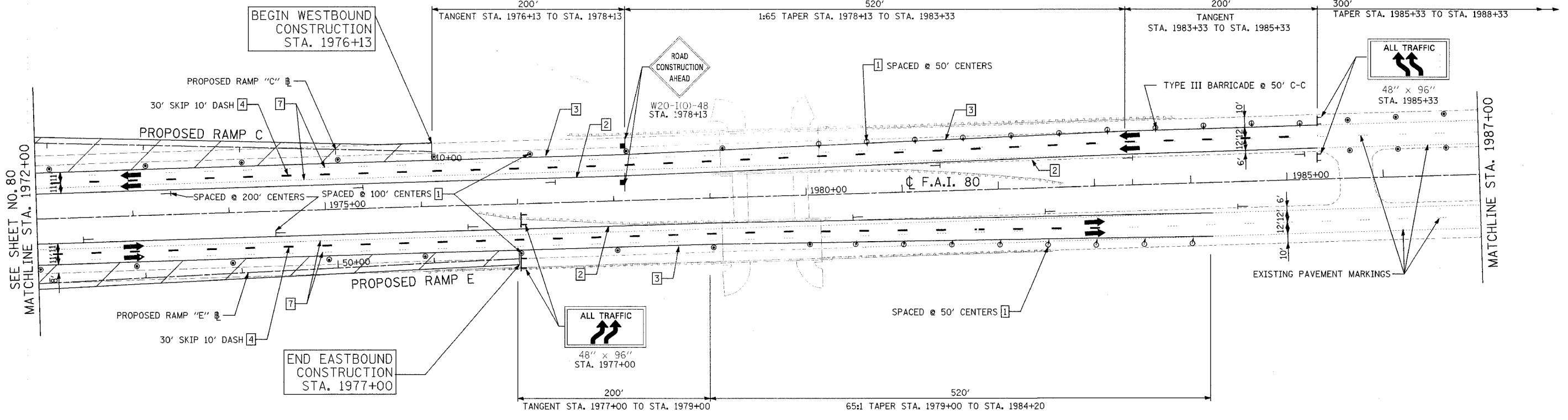

REVISIONS	
NAME	DATE

STATE OF ILLINOIS
DEPARTMENT OF TRANSPORTATION
F.A.I. 80 & F.A.I. 55 INTERCHANGE
STAGE 1
F.A.I. 80 TRAFFIC CONTROL
STA. 1972+00 TO STA. 2143+00

SCALE: 1" = 50'
DATE: JANUARY, 2005

DRAWN BY: KDM
CHECKED BY: MJL

DATE: 01/03/2005
FILENAME: n:\proj\28902890-02\design\mch\180stage 1\2890-mch-80-stage1-05.dgn