

F.A.I. ROUTE	SECTION	COUNTY	TOTAL SHEETS	SHEET NO.
80-55	99-1K, BY&AC-B)	WILL	497	87
STA. 1761+10 TO STA. 1925+50		FED. ROAD DIST. NO. 1 ILLINOIS FED. AID PROJECT		
CONTRACT NO. 80906				



- LEGEND**
- 1 DRUM WITH STEADY BURNING LIGHT
 - 2 PAVEMENT MARKING TAPE, TYPE III - (4 INCH), YELLOW
 - 3 PAVEMENT MARKING TAPE, TYPE III - (4 INCH), WHITE
 - 4 PAVEMENT MARKING TAPE, TYPE III - (5 INCH), WHITE
 - 5 PAVEMENT MARKING TAPE, TYPE III - (8 INCH), WHITE
 - 6 PAVEMENT MARKING TAPE, TYPE III - (12 INCH), WHITE
 - 7 PAVEMENT MARKING REMOVAL (LINE)

- VERTICAL PANELS WITH STEADY BURNING MONO DIRECTIONAL LIGHTS
- DIRECTIONAL BARRICADE
- DRUMS WITH STEADY BURNING MONO DIRECTIONAL LIGHTS
- DIRECTION OF TRAFFIC
- CONSTRUCTION SIGN
- TYPE III BARRICADE WITH ATTACHED SIGN PANEL
- PORTABLE CHANGEABLE MESSAGE SIGN
- WORK ZONE

- NOTES**
1. RAISED PAVEMENT REFLECTOR LENS WHICH CONFLICT WITH TEMPORARY PAVEMENT MARKINGS SHALL BE REMOVED. THIS WORK SHALL BE INCLUDED IN THE COST TO THE CONTRACT UNIT PRICE FOR REPLACEMENT REFLECTORS.

SIGN LEGEND

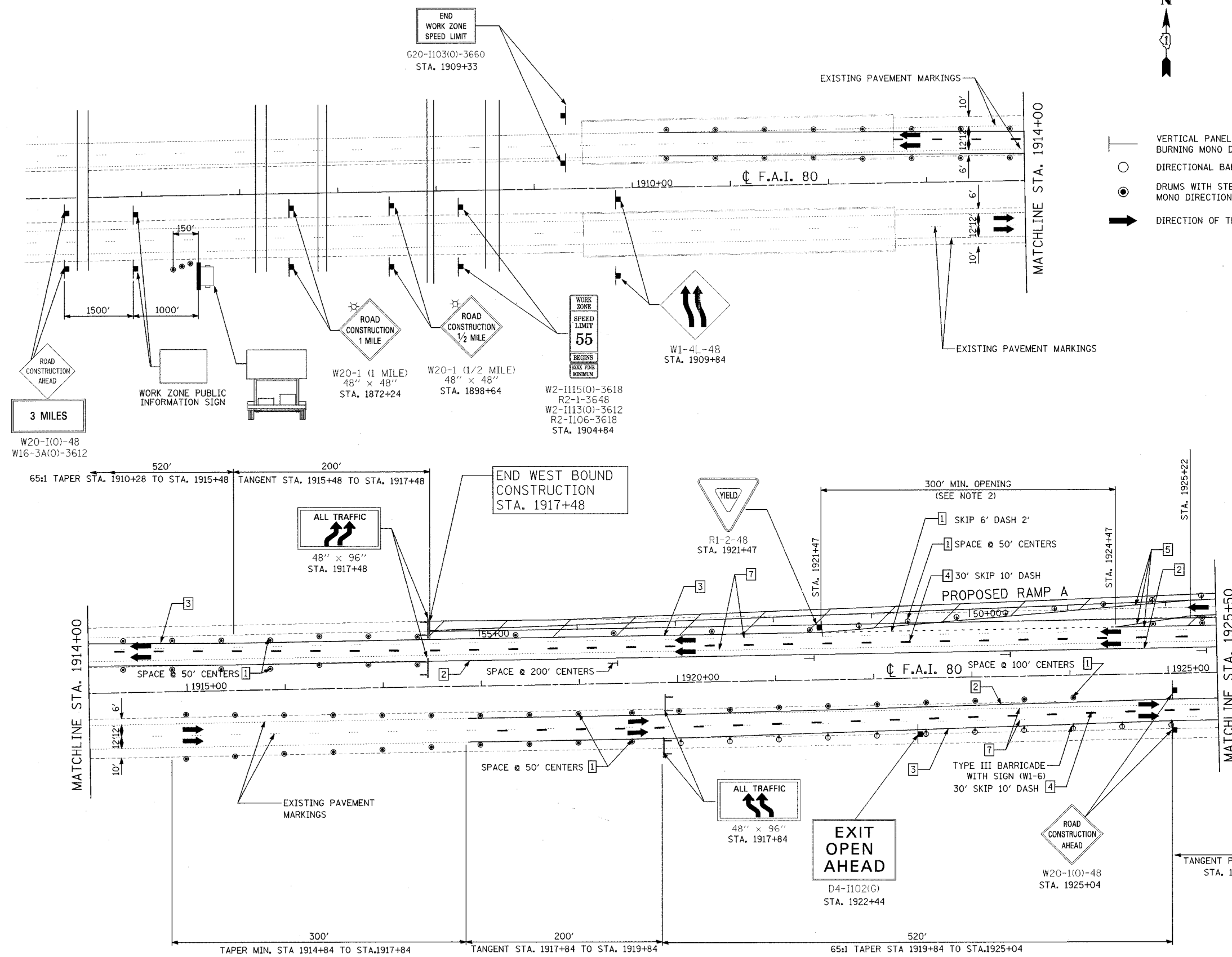

REVISIONS	
NAME	DATE

STATE OF ILLINOIS
DEPARTMENT OF TRANSPORTATION
F.A.I. 80 & F.A.I. 55 INTERCHANGE
STAGE 3
F.A.I. 80 TRAFFIC CONTROL
STA. 1761+10 TO STA. 1925+50

SCALE: 1" = 50'
DATE: JANUARY, 2005

DRAWN BY: KDM
CHECKED BY: MJL

DATE: 01/02/2005
FILENAME: r:\proj\2890\cadd\02\design\mofair\80stage 1\2890-mb-80-stage1-1.dgn