

F.A.I. ROUTE	SECTION	COUNTY	TOTAL SHEETS	SHEET NO.
80-55 99-1(K,BY&AC-B)	WILL		497	150
STA. 1061+00 TO STA. 1069+00				
FED. ROAD DIST. NO. 1 ILLINOIS		FED. AID PROJECT		
CONTRACT NO. 80906				

SEE SHEET NO.151
MATCH LINE STA. 1069+00

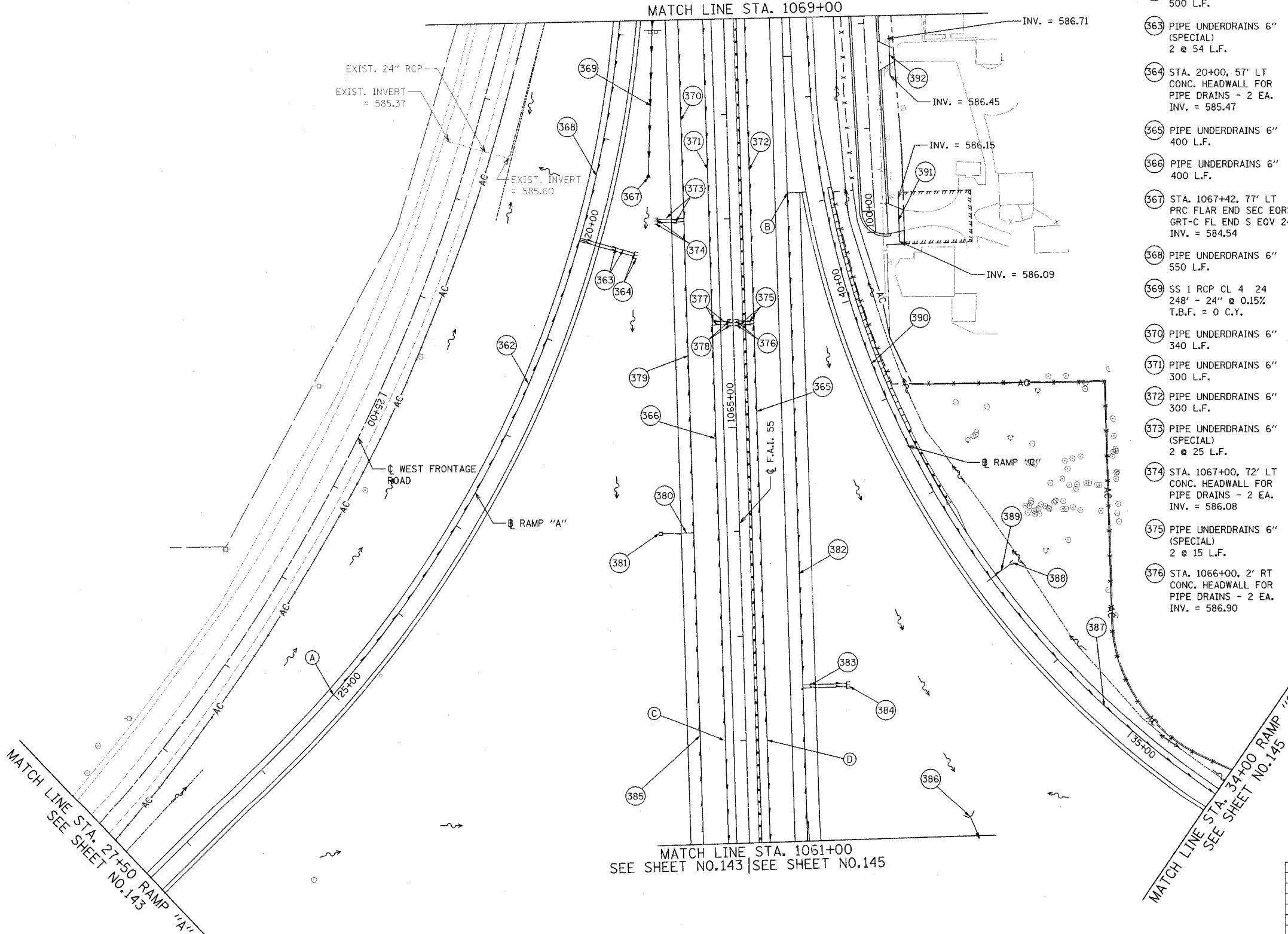

- (362) PIPE UNDERDRAINS 6" 500 L.F.
- (363) PIPE UNDERDRAINS 6" (SPECIAL) 2 @ 54 L.F.
- (364) STA. 20+00, 57' LT CONC. HEADWALL FOR PIPE DRAINS - 2 EA. INV. = 585.47
- (365) PIPE UNDERDRAINS 6" 400 L.F.
- (366) PIPE UNDERDRAINS 6" 400 L.F.
- (367) STA. 1067+42, 77' LT PRC FLAR END SEC EQRS 24 GRT-C FL END S EQV 24 INV. = 584.54
- (368) PIPE UNDERDRAINS 6" 550 L.F.
- (369) SS 1 RCP CL 4 24 248' - 24" @ 0.15% T.B.F. = 0 C.Y.
- (370) PIPE UNDERDRAINS 6" 340 L.F.
- (371) PIPE UNDERDRAINS 6" 300 L.F.
- (372) PIPE UNDERDRAINS 6" 300 L.F.
- (373) PIPE UNDERDRAINS 6" (SPECIAL) 2 @ 25 L.F.
- (374) STA. 1067+00, 72' LT CONC. HEADWALL FOR PIPE DRAINS - 2 EA. INV. = 586.08
- (375) PIPE UNDERDRAINS 6" (SPECIAL) 2 @ 15 L.F.
- (376) STA. 1066+00, 2' RT CONC. HEADWALL FOR PIPE DRAINS - 2 EA. INV. = 586.90
- (377) PIPE UNDERDRAINS 6" (SPECIAL) 2 @ 15 L.F.
- (378) STA. 1066+00, 2' LT CONC. HEADWALL FOR PIPE DRAINS - 2 EA. INV. = 586.95
- (379) PIPE UNDERDRAINS 6" 300 L.F.
- (380) PIPE UNDERDRAINS 6" (SPECIAL) 30 L.F.
- (381) STA. 1064+00, 74' LT CONC. HEADWALL FOR PIPE DRAINS - 1 EA. INV. = 586.30
- (382) PIPE UNDERDRAINS 6" 473 L.F.
- (383) PIPE UNDERDRAINS 6" (SPECIAL) 2 @ 42 L.F.
- (384) STA. 1062+50, 101' RT CONC. HEADWALL FOR PIPE DRAINS - 2 EA. INV. = 585.69
- (385) PIPE UNDERDRAINS 6" 355 L.F.
- (386) STA. 5+09, 101' LT CIP END SEC 24 INV. = 581.95
- (387) PIPE UNDERDRAINS 6" 355 L.F.
- (388) STA. 37+00, 27' RT CONC. HEADWALL FOR PIPE DRAINS - 1 EA. INV. = 587.13
- (389) PIPE UNDERDRAINS 6" (SPECIAL) 24 L.F.
- (390) PIPE UNDERDRAINS 6" 600 L.F.
- (391) P CUL CL A1 12 42' - 12" @ 0.14% T.B.F. = 7 C.Y.
- (392) P CUL CL A1 12 38' - 12" @ 0.68% T.B.F. = 6 C.Y.

- (A) BEGIN UNDERDRAIN STA. 25+00 INV. = 588.51
- (B) BEGIN UNDERDRAIN STA. 1067+23, 56' RT INV. = 587.54
- (C) BEGIN UNDERDRAIN STA. 1062+00, 20' LT INV. = 588.02
- (D) BEGIN UNDERDRAIN STA. 1062+00, 20' RT INV. = 588.25

LEGEND

- EXISTING DITCH LINE
- - - PROPOSED DITCH LINE
- ~> PROPOSED FLOW DIRECTION
- AGGREGATE DITCH
- EXISTING STORM SEWER
- - - EXISTING PIPE CULVERT
- PROPOSED STORM SEWER OR PIPE CULVERT
- EXISTING PIPE UNDERDRAIN
- PROPOSED PIPE UNDERDRAIN

REVISIONS	
NAME	DATE

STATE OF ILLINOIS
DEPARTMENT OF TRANSPORTATION
F.A.I. 80 & F.A.I. 55 INTERCHANGE

**PROPOSED DRAINAGE PLAN
F.A.I. 55, RAMPS "A" & "C"**

SCALE: 1" = 50'
DATE: JANUARY, 2005

DRAWN BY: KMS
CHECKED BY: MJL

DATE: 01/03/2005
FILENAME: n:\proj\2880\2880-C02\design\drainage\2880-drainage-09.dgn