

F.A.I. ROUTE	SECTION	COUNTY	TOTAL SHEETS	SHEET NO.
80-55 99-1(K,BY&AC-B)	WILL		497	151
STA. 1069+00 TO STA. 1084+94.01				
FED. ROAD DIST. NO. 1 ILLINOIS		FED. AID PROJECT		
<b>CONTRACT NO. 80906</b>				

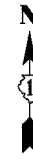

- 393 STA. 1070+00, 58' LT MH TA, 5' DIA., TIF OL FLAT SLAB TOP  
T/F = 589.20  
INV. = 585.04 (S)  
INV. = 585.14 (E)
- 394 STA. 1069+00, 2' LT CONC. HEADWALL FOR PIPE DRAINS - 1 EA.  
INV. = 586.10
- 395 PIPE UNDERDRAINS 6" (SPECIAL)  
15 L.F.
- 396 PIPE UNDERDRAINS 6" (SPECIAL)  
15 L.F.
- 397 STA. 1069+00, 2' LT CONC. HEADWALL FOR PIPE DRAINS - 1 EA.  
INV. = 586.30
- 398 PIPE UNDERDRAINS 6" (SPECIAL)  
18 L.F.
- 399 STA. 43+00, 21' RT CONC. HEADWALL FOR PIPE DRAINS - 1 EA.  
INV. = 586.18
- 400 STA. 43+83, 27' RT PRC FLAR END SEC 30 GRT-C FL END SEC 30  
INV. = 584.85
- 401 P CUL CL A1 30  
40' - 30" @ 0.13%  
T.B.F. = 3 C.Y.
- 402 STA. 43+83, 81' RT PRC FLAR END SEC 30 GRT-C FL END SEC 30  
INV. = 584.80
- 403 PIPE UNDERDRAINS 6"  
400 L.F.
- 404 PIPE UNDERDRAINS 6"  
400 L.F.
- 405 PIPE UNDERDRAINS 6"  
400 L.F.
- 406 PIPE UNDERDRAINS 6" (SPECIAL)  
17 L.F.
- 407 STA. 14+50, 20' RT CONC. HEADWALL FOR PIPE DRAINS - 1 EA.  
INV. = 586.67
- 408 PIPE UNDERDRAINS 6" (SPECIAL)  
14 L.F.
- 409 STA. 1073+00, 3' LT CONC. HEADWALL FOR PIPE DRAINS - 1 EA.  
INV. = 586.93
- 410 STA. 1073+00, 2' RT CONC. HEADWALL FOR PIPE DRAINS - 1 EA.  
INV. = 587.09
- 411 PIPE UNDERDRAINS 6" (SPECIAL)  
14 L.F.
- 412 STA. 47+00, 18' RT CONC. HEADWALL FOR PIPE DRAINS - 1 EA.  
INV. = 586.98
- 413 PIPE UNDERDRAINS 6" (SPECIAL)  
15 L.F.

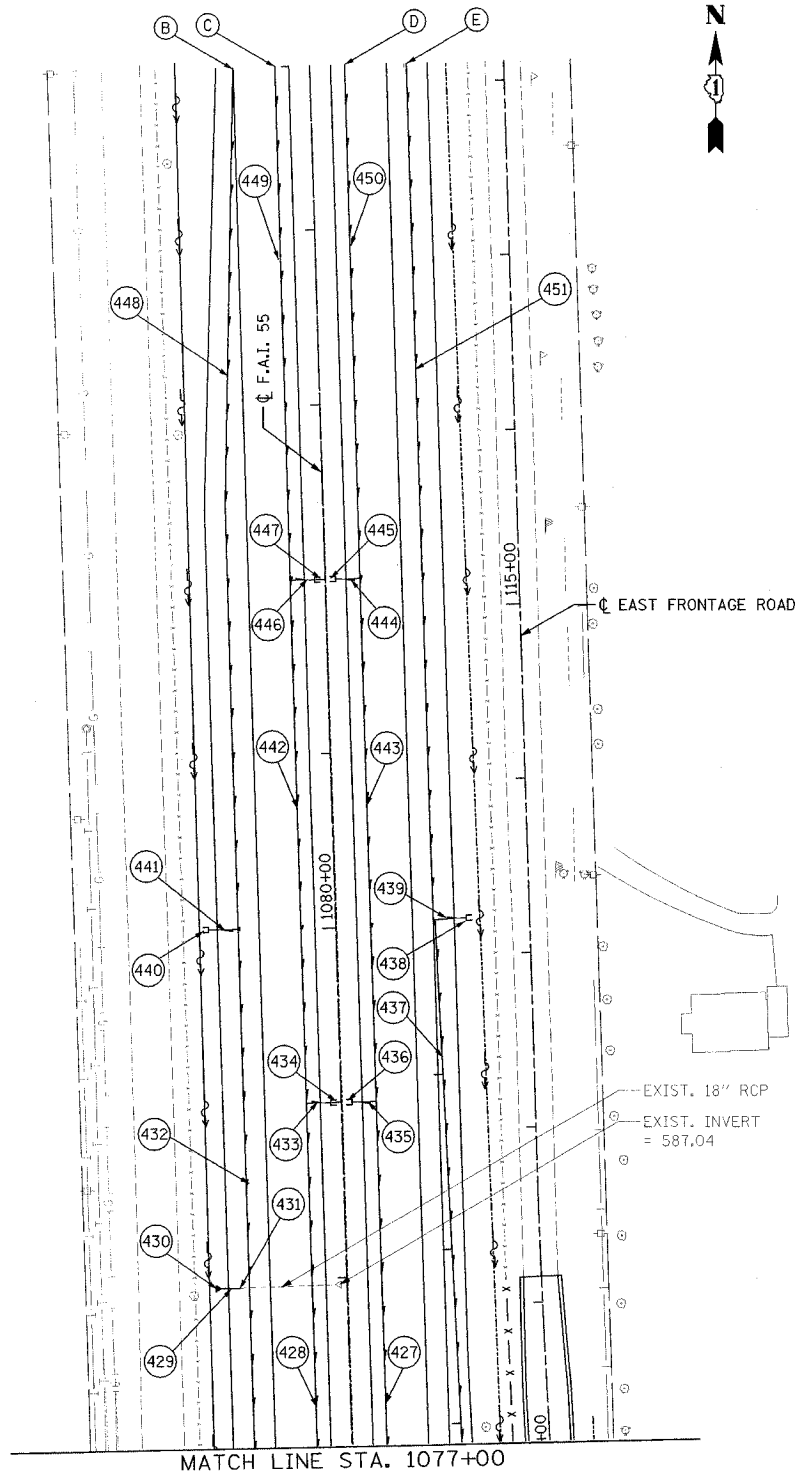
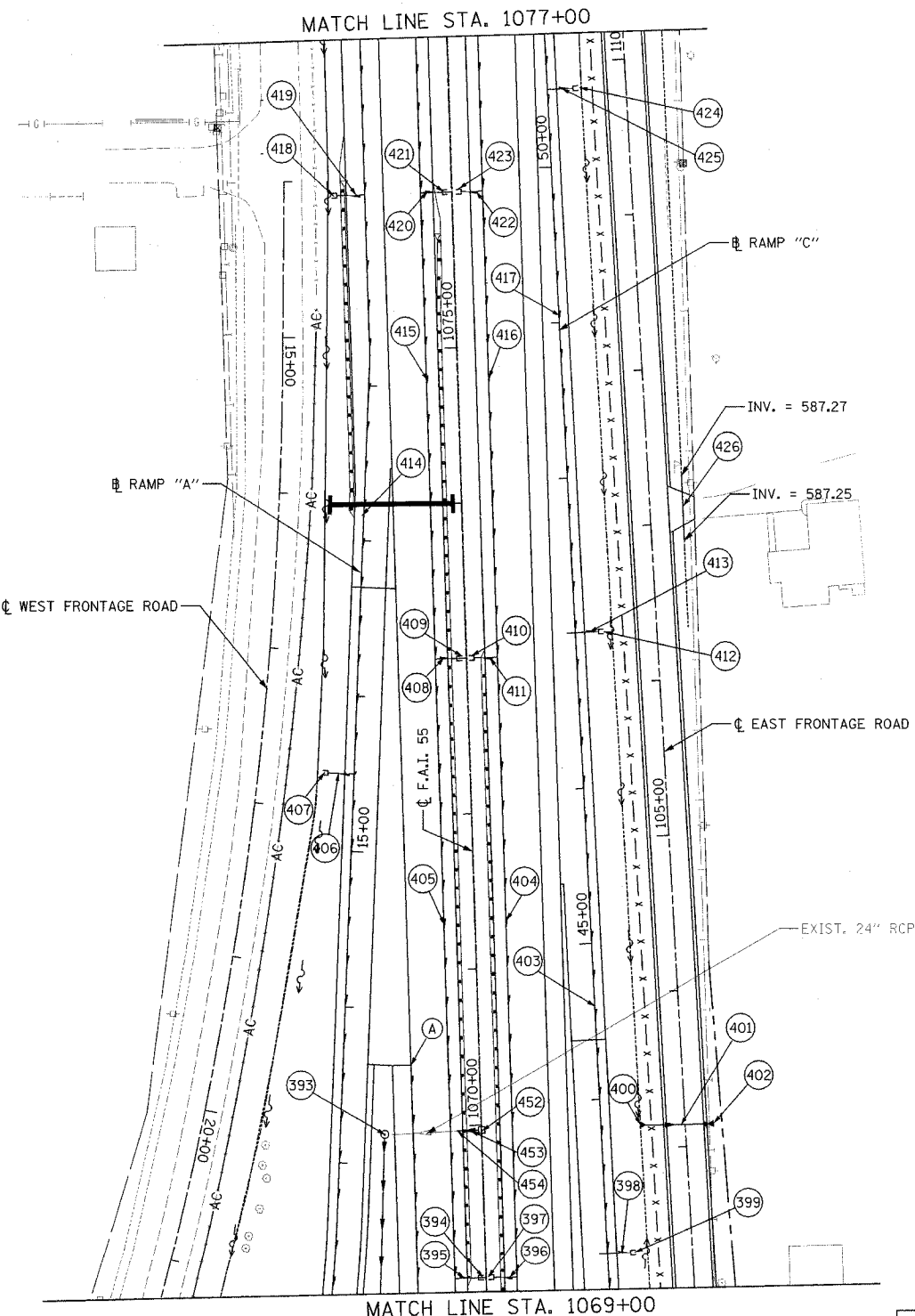

- 414 PIPE UNDERDRAINS 6"  
373 L.F.
- 415 PIPE UNDERDRAINS 6"  
300 L.F.
- 416 PIPE UNDERDRAINS 6"  
300 L.F.
- 417 PIPE UNDERDRAINS 6"  
350 L.F.
- 418 STA. 1076+00, 77' LT CONC. HEADWALL FOR PIPE DRAINS - 1 EA.  
INV. = 587.90
- 419 PIPE UNDERDRAINS 6" (SPECIAL)  
18 L.F.
- 420 PIPE UNDERDRAINS 6" (SPECIAL)  
14 L.F.
- 421 STA. 1076+00, 3' LT CONC. HEADWALL FOR PIPE DRAINS - 1 EA.  
INV. = 587.25
- 422 PIPE UNDERDRAINS 6" (SPECIAL)  
14 L.F.
- 423 STA. 1076+00, 3' RT CONC. HEADWALL FOR PIPE DRAINS - 1 EA.  
INV. = 587.24
- 424 STA. 50+50, 19' RT CONC. HEADWALL FOR PIPE DRAINS - 1 EA.  
INV. = 587.52
- 425 PIPE UNDERDRAINS 6" (SPECIAL)  
16 L.F.
- 426 P CUL CL A1 30  
42' - 30" @ 0.10%  
T.B.F. = 7 C.Y.
- 427 PIPE UNDERDRAINS 6"  
300 L.F.
- 428 PIPE UNDERDRAINS 6"  
300 L.F.
- 429 P CUL CL A1 18  
18' - 18" @ 0.6%  
T.B.F. = 2 C.Y.
- 430 STA. 1077+96, 77' LT PRC FLAR END SEC 18  
INV. = 586.61
- 431 STA. 1077+96, 59' LT CONCRETE COLLAR
- 432 PIPE UNDERDRAINS 6"  
400 L.F.
- 433 PIPE UNDERDRAINS 6" (SPECIAL)  
14 L.F.
- 434 STA. 1079+00, 3' LT CONC. HEADWALL FOR PIPE DRAINS - 1 EA.  
INV. = 587.56
- 435 PIPE UNDERDRAINS 6" (SPECIAL)  
14 L.F.
- 436 STA. 1079+00, 3' RT CONC. HEADWALL FOR PIPE DRAINS - 1 EA.  
INV. = 587.73
- 437 PIPE UNDERDRAINS 6"  
339 L.F.
- 438 STA. 53+67, 21' RT CONC. HEADWALL FOR PIPE DRAINS - 1 EA.  
INV. = 587.95
- 439 PIPE UNDERDRAINS 6" (SPECIAL)  
18 L.F.
- 440 STA. 1080+00, 76' LT CONC. HEADWALL FOR PIPE DRAINS - 1 EA.  
INV. = 587.35
- 441 PIPE UNDERDRAINS 6" (SPECIAL)  
17 L.F.
- 442 PIPE UNDERDRAINS 6" (SPECIAL)  
300 L.F.
- 443 PIPE UNDERDRAINS 6"  
300 L.F.
- 444 PIPE UNDERDRAINS 6" (SPECIAL)  
14 L.F.
- 445 STA. 1082+00, 3' RT CONC. HEADWALL FOR PIPE DRAINS - 1 EA.  
INV. = 588.03
- 446 PIPE UNDERDRAINS 6" (SPECIAL)  
14 L.F.
- 447 STA. 1082+00, 3' LT CONC. HEADWALL FOR PIPE DRAINS - 1 EA.  
INV. = 587.95
- 448 PIPE UNDERDRAINS 6"  
494 L.F.
- 449 PIPE UNDERDRAINS 6"  
294 L.F.
- 450 PIPE UNDERDRAINS 6"  
294 L.F.
- 451 PIPE UNDERDRAINS 6"  
494 L.F.
- 452 STA. 1069+97, 16' LT CONCRETE COLLAR
- 453 P CUL CL A1 24  
14' - 24" @ 1.0%  
T.B.F. = 3 C.Y.
- 454 STA. 1069+97 FLUSH INLET BOX FOR MEDIAN  
INV. = 585.24

- (A) BEGIN UNDERDRAIN STA. 1070+40, 44' LT  
INV. = 587.32
- (B) BEGIN UNDERDRAIN STA. 1084+94, 44' LT  
INV. = 588.90
- (C) BEGIN UNDERDRAIN STA. 1084+94, 20' LT  
INV. = 589.00
- (D) BEGIN UNDERDRAIN STA. 1084+94, 20' RT  
INV. = 589.55
- (E) BEGIN UNDERDRAIN STA. 1084+94, 44' RT  
INV. = 589.40

LEGEND	
--- EXISTING DITCH LINE	--- EXISTING STORM SEWER
- - - PROPOSED DITCH LINE	- - - EXISTING PIPE CULVERT
~ ~ ~ PROPOSED FLOW DIRECTION	--- PROPOSED STORM SEWER OR PIPE CULVERT
--- AGGREGATE DITCH	--- EXISTING PIPE UNDERDRAIN
	--- PROPOSED PIPE UNDERDRAIN

REVISIONS	
NAME	DATE

STATE OF ILLINOIS  
DEPARTMENT OF TRANSPORTATION  
F.A.I. 80 & F.A.I. 55 INTERCHANGE

**PROPOSED DRAINAGE PLAN**  
F.A.I. 55, RAMPS "A" & "C"

SCALE: 1" = 50'  
DATE: JANUARY, 2005

DRAWN BY: KMS  
CHECKED BY: MJL

DATE: 01/03/2005  
FILENAME: n:\proj\2880\2880.dwg