

F.A.I. ROUTE	SECTION	COUNTY	TOTAL SHEETS	SHEET NO.
80-55 99-1(K,BY&AC-B)	WILL		497	157
STA. 1941+63		TO STA. 1948+12		
FED. ROAD DIST. NO. 1		ILLINOIS FED. AID PROJECT		
CONTRACT NO. 80906				

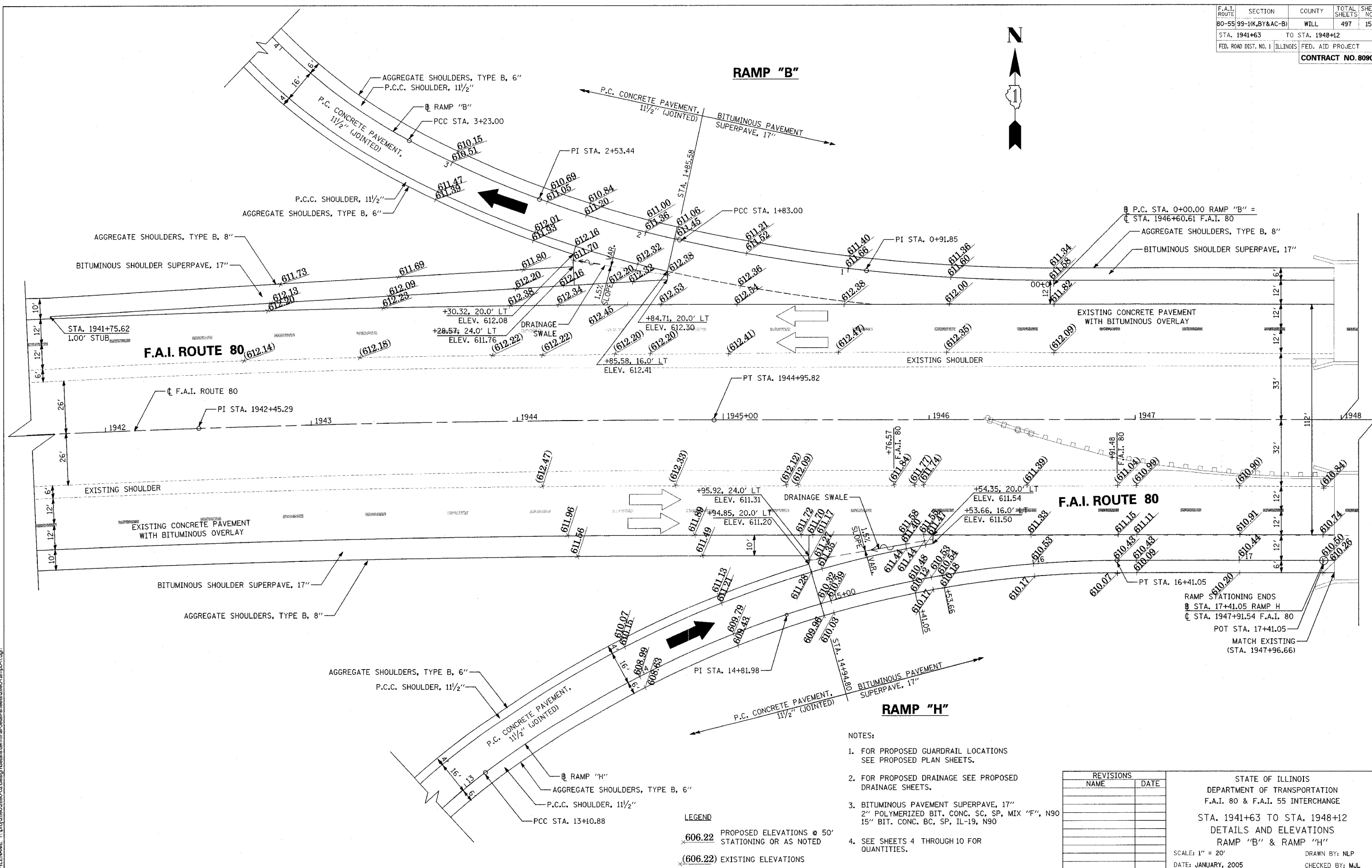

- NOTES:
1. FOR PROPOSED GUARDRAIL LOCATIONS SEE PROPOSED PLAN SHEETS.
 2. FOR PROPOSED DRAINAGE SEE PROPOSED DRAINAGE SHEETS.
 3. BITUMINOUS PAVEMENT SUPERPAVE, 17"
2" POLYMERIZED BIT. CONC. SC, SP, MIX "F", N90
15" BIT. CONC. BC, SP, IL-19, N90
 4. SEE SHEETS 4 THROUGH 10 FOR QUANTITIES.

LEGEND
 606.22 PROPOSED ELEVATIONS @ 50' STATIONING OR AS NOTED
 (606.22) EXISTING ELEVATIONS

REVISIONS	
NAME	DATE

STATE OF ILLINOIS
 DEPARTMENT OF TRANSPORTATION
 F.A.I. 80 & F.A.I. 55 INTERCHANGE
 STA. 1941+63 TO STA. 1948+12
 DETAILS AND ELEVATIONS
 RAMP "B" & RAMP "H"

SCALE: 1" = 20'
 DATE: JANUARY, 2005

DRAWN BY: NLP
 CHECKED BY: MJL

DATE: 01/03/2005
 FILENAME: n:\proj\28803880-02\design\details\terminal\sheet\2880-rampb-h.dgn