

F.A.I. ROUTE	SECTION	COUNTY	TOTAL SHEETS	SHEET NO.
80-55 99-1K, BY&AC-BI	WILL		497	184
STA. 1934+00	TO STA. 1949+25			
FED. ROAD DIST. NO. 1	ILLINOIS	FED. AID PROJECT		

CONTRACT NO. 80906



SEE SHEET NO. 191
MATCH LINE STA. 1061+00

- 30, T-QUERCUS MACR 1-3/4
- 20, T-JUGLANS NIGRA 2
- 20, T-QUERCUS ELLIP 1-3/4
- 30, T-ACERX FREM AB 2
- 20, T-CELTIS OC WC 2

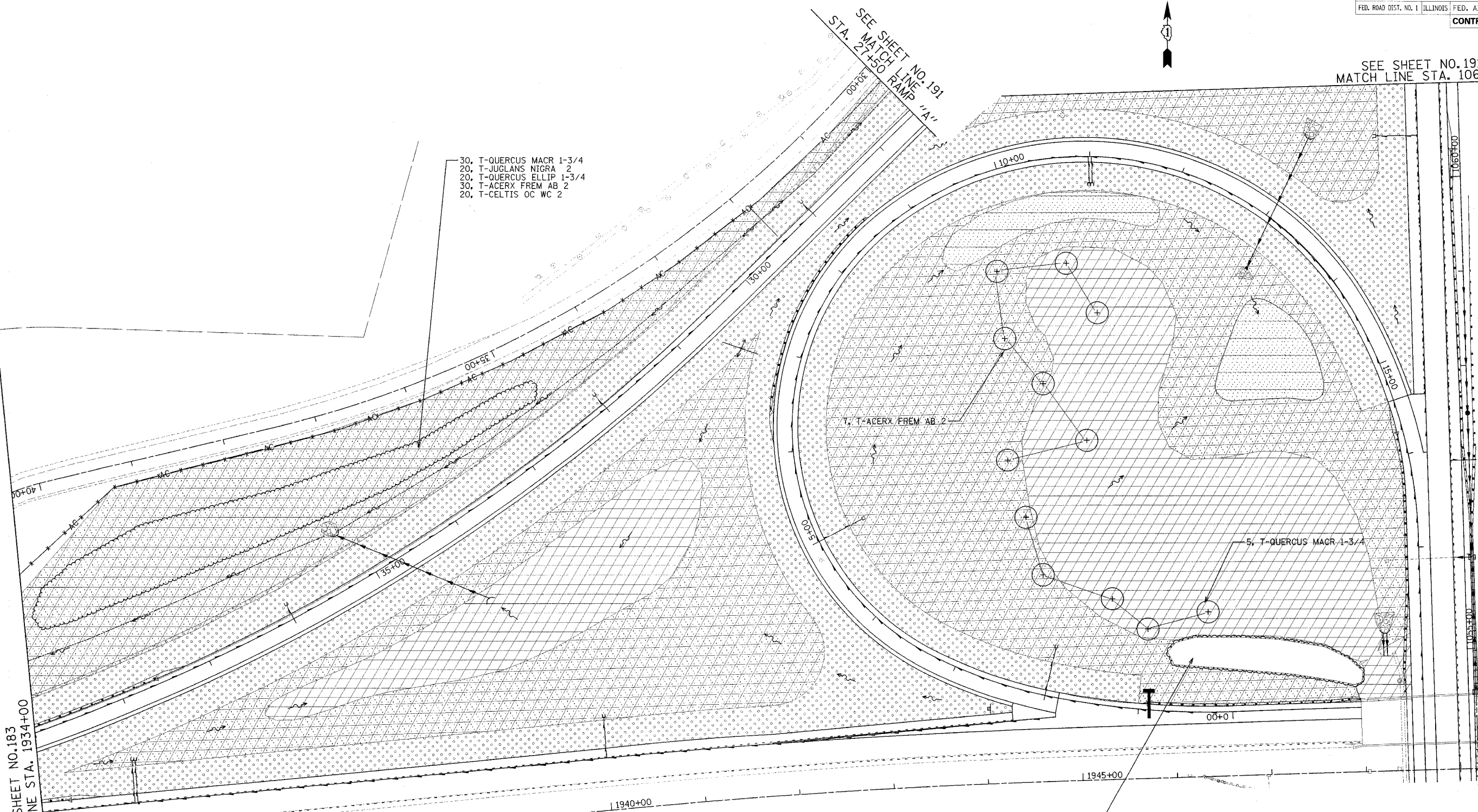

SEE SHEET NO. 183
MATCH LINE STA. 1934+00

SEE SHEET NO. 191
MATCH LINE RAMP "A"
STA. 27+50

400 S-RHUS TYPHINA 2'BR
3' STAGGERED CENTERS

REVISIONS	
NAME	DATE

STATE OF ILLINOIS
DEPARTMENT OF TRANSPORTATION
F.A.I. 80 & F.A.I. 55 INTERCHANGE
LANDSCAPING PLAN
F.A.I. 80, F.A.I. 55,
RAMPS "A" & "B"

SCALE: 1" = 50'
DATE: JANUARY, 2005
DRAWN BY: KDM
CHECKED BY: MJL

DATE: 01/02/2005
FILENAME: \\p03\26903865-02\design\landscaping\2690_landscapn-02.dgn