

F.A.I. ROUTE	SECTION	COUNTY	TOTAL SHEETS	SHEET NO.
80-55-99-1(K,BY&AC-B)	WILL		497	193
STA. 1916+00	TO STA. 1934+00			
FED. ROAD DIST. NO. 1 ILLINOIS		FED. AID PROJECT		
CONTRACT NO. 80906				

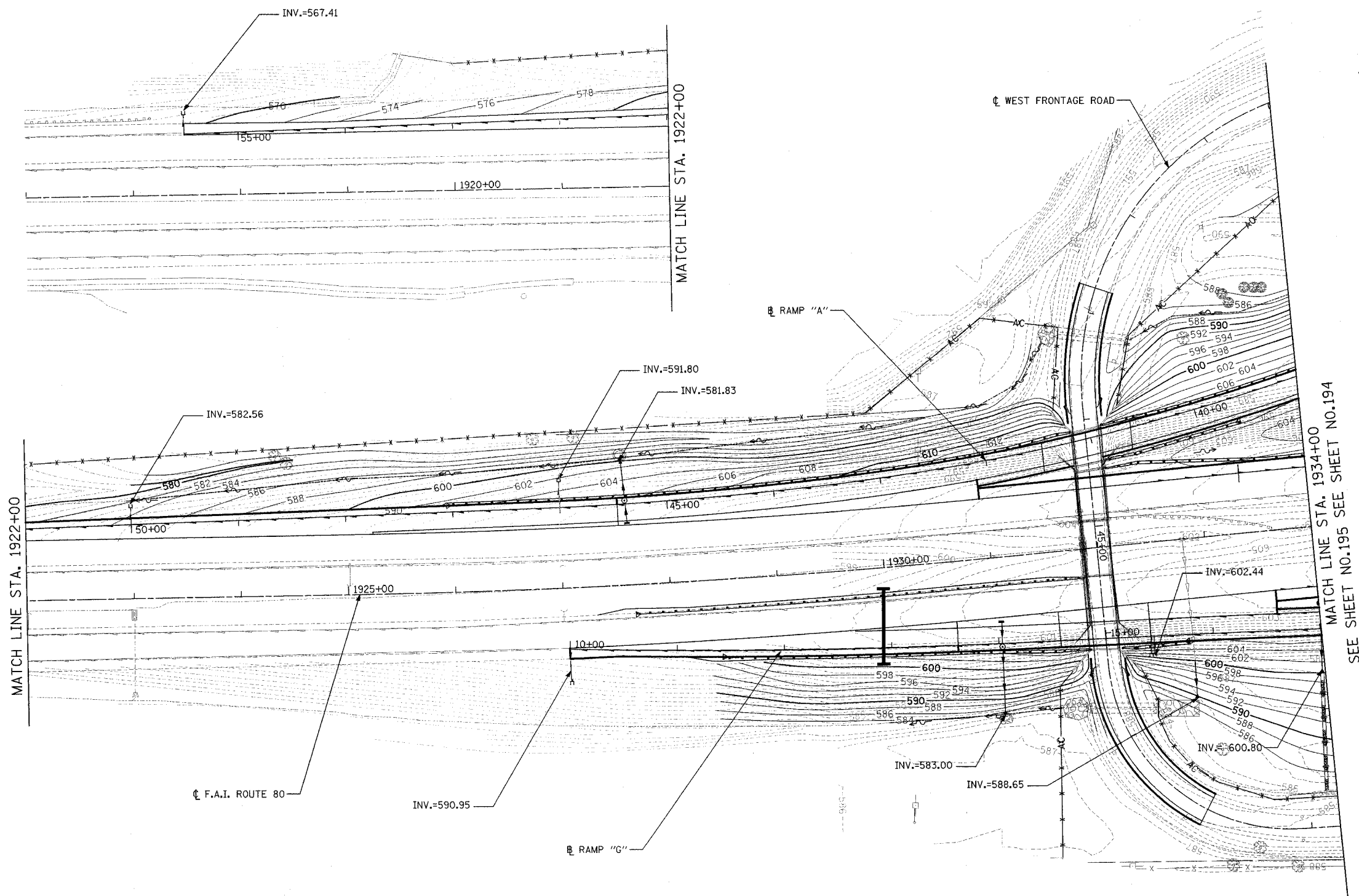

DATE: 01/03/2005
FILENAME: n:\proj\2880\2880-02\civil\grading\2880-02.dgn

REVISIONS	
NAME	DATE

STATE OF ILLINOIS
DEPARTMENT OF TRANSPORTATION
F.A.I. 80 & F.A.I. 55 INTERCHANGE

**NW AND SW GRADING PLAN
F.A.I. 80, RAMPS "A" & "G"**

SCALE: 1" = 50'
DATE: JANUARY, 2005

DRAWN BY: KMS, DMW
CHECKED BY: MJL