

F.A.I. ROUTE	SECTION	COUNTY	TOTAL SHEETS	SHEET NO.
80-55	99-1(K,B,Y&AC-B)	WILL	497	197
STA. 1949+25 TO STA. 1964+50		FED. ROAD DIST. NO. 1 ILLINOIS FED. AID PROJECT		
CONTRACT NO. 80906				

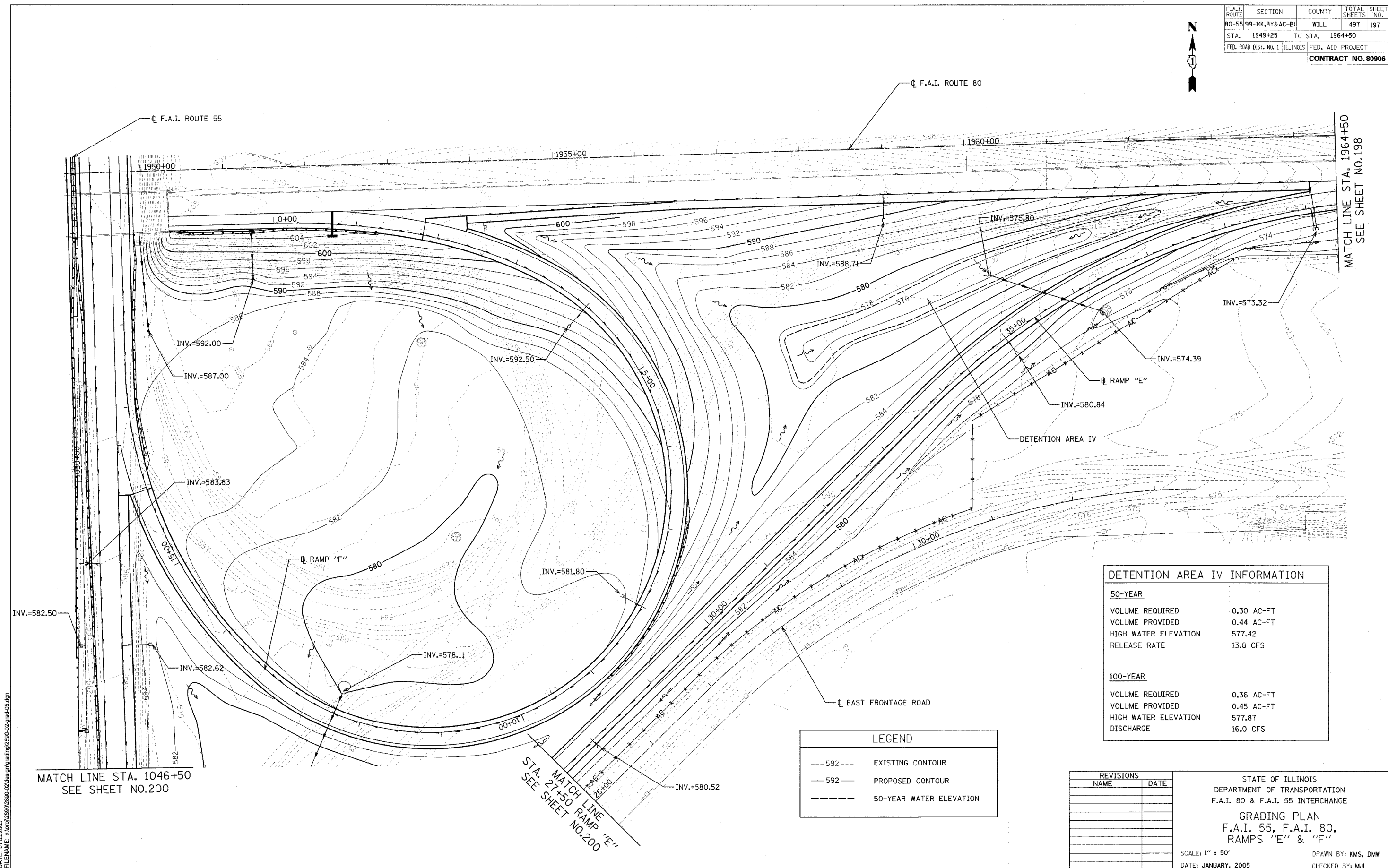

MATCH LINE STA. 1964+50
SEE SHEET NO.198

MATCH LINE STA. 1046+50
SEE SHEET NO.200

MATCH LINE STA. 27+50 RAMP 'E'
SEE SHEET NO.200

DETENTION AREA IV INFORMATION	
50-YEAR	
VOLUME REQUIRED	0.30 AC-FT
VOLUME PROVIDED	0.44 AC-FT
HIGH WATER ELEVATION	577.42
RELEASE RATE	13.8 CFS
100-YEAR	
VOLUME REQUIRED	0.36 AC-FT
VOLUME PROVIDED	0.45 AC-FT
HIGH WATER ELEVATION	577.87
DISCHARGE	16.0 CFS

LEGEND	
--- 592 ---	EXISTING CONTOUR
— 592 —	PROPOSED CONTOUR
-----	50-YEAR WATER ELEVATION

REVISIONS	
NAME	DATE

STATE OF ILLINOIS
DEPARTMENT OF TRANSPORTATION
F.A.I. 80 & F.A.I. 55 INTERCHANGE

GRADING PLAN
F.A.I. 55, F.A.I. 80,
RAMPS 'E' & 'F'

SCALE: 1" = 50'
DATE: JANUARY, 2005

DRAWN BY: KMS, DMW
CHECKED BY: MJL

DATE: 01/03/2005
FILENAME: n:\proj\2890\2890_02\design\grading\2890_02_grad.dwg