

F.A.I. ROUTE	SECTION	COUNTY	TOTAL SHEETS	SHEET NO.
80-55	99-1(K, BY&AC-B)	WILL	497	205J
STA.	TO STA.			
FED. ROAD DIST. NO. 1	ILLINOIS	FED. AID PROJECT		
CONTRACT NO. 80906				

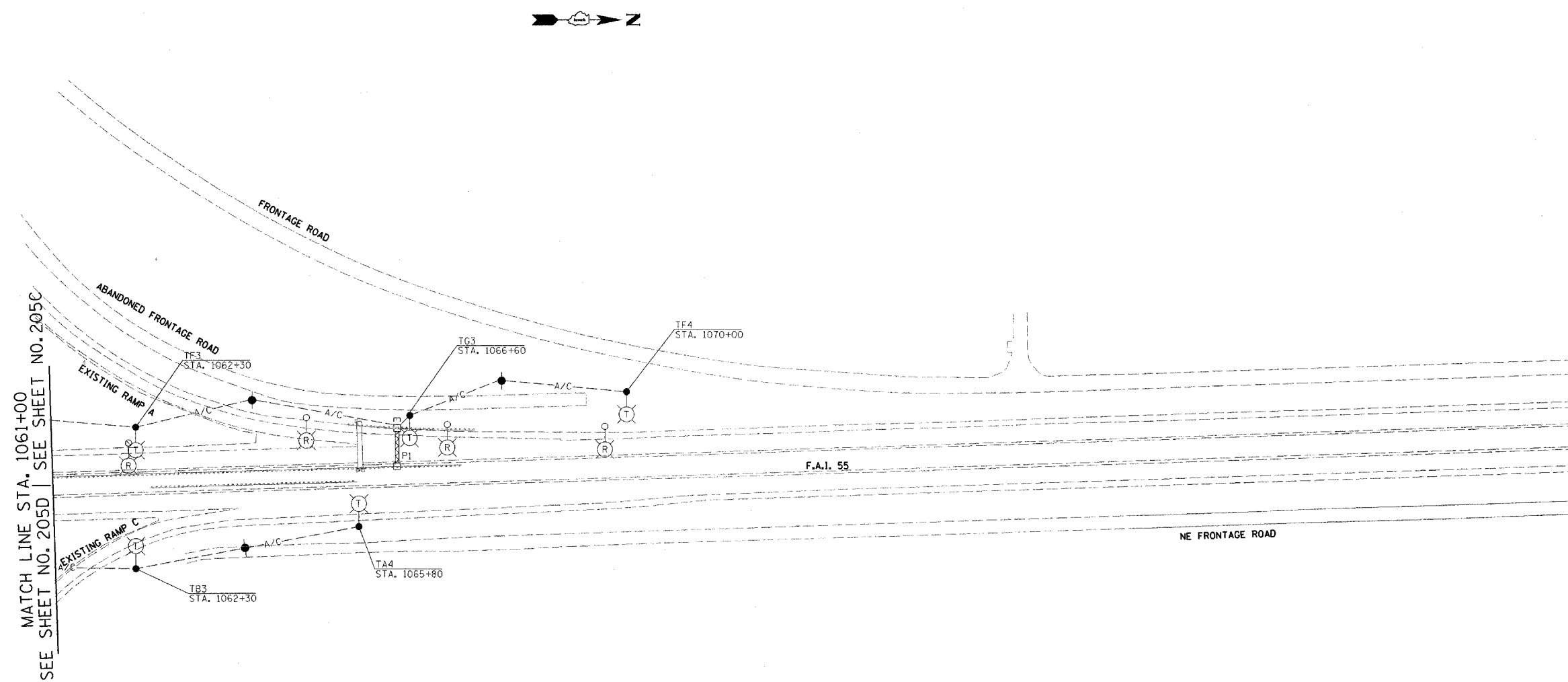

MATCH LINE STA. 1061+00
SEE SHEET NO. 205D | SEE SHEET NO. 205C

NOTE:
ALL TEMPORARY POLES SHALL BE 30' FROM EXISTING
EDGE OF PAVEMENT UNLESS OTHERWISE NOTED

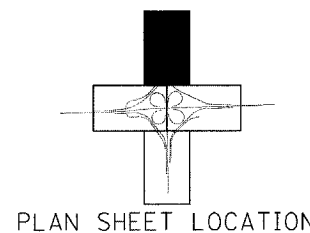

PLAN SHEET LOCATION

REVISIONS	
NAME	DATE

STATE OF ILLINOIS
DEPARTMENT OF TRANSPORTATION
F.A.I. 80 & F.A.I. 55 INTERCHANGE
TEMPORARY LIGHTING PLAN
PRE-STAGE

SCALE: 1" = 100'
DATE: JANUARY, 2005

DRAWN BY: JMV
CHECKED BY: AC