

RAMP "C" PROFILE

P.A. NO.	SECTION	COUNTY	TOTAL SHEETS	SHEET NO.
55.80	X	WILL	497	327
STA 10+00	TO STA 38+00		RAMP "C"	
FED. ROAD DIST. NO. 7 ILLINOIS FEDERAL AID PROJECT				
BY RAC-B				
CONTRACT NO. 80996				

DATE: 01/03/06 FILENAME: c:\p0285028502\desig\detail\soils\soilsheet7.dgn SOILS PROFILES PLOTTED BY: O'BRIEN & ASSOCIATES, INC.

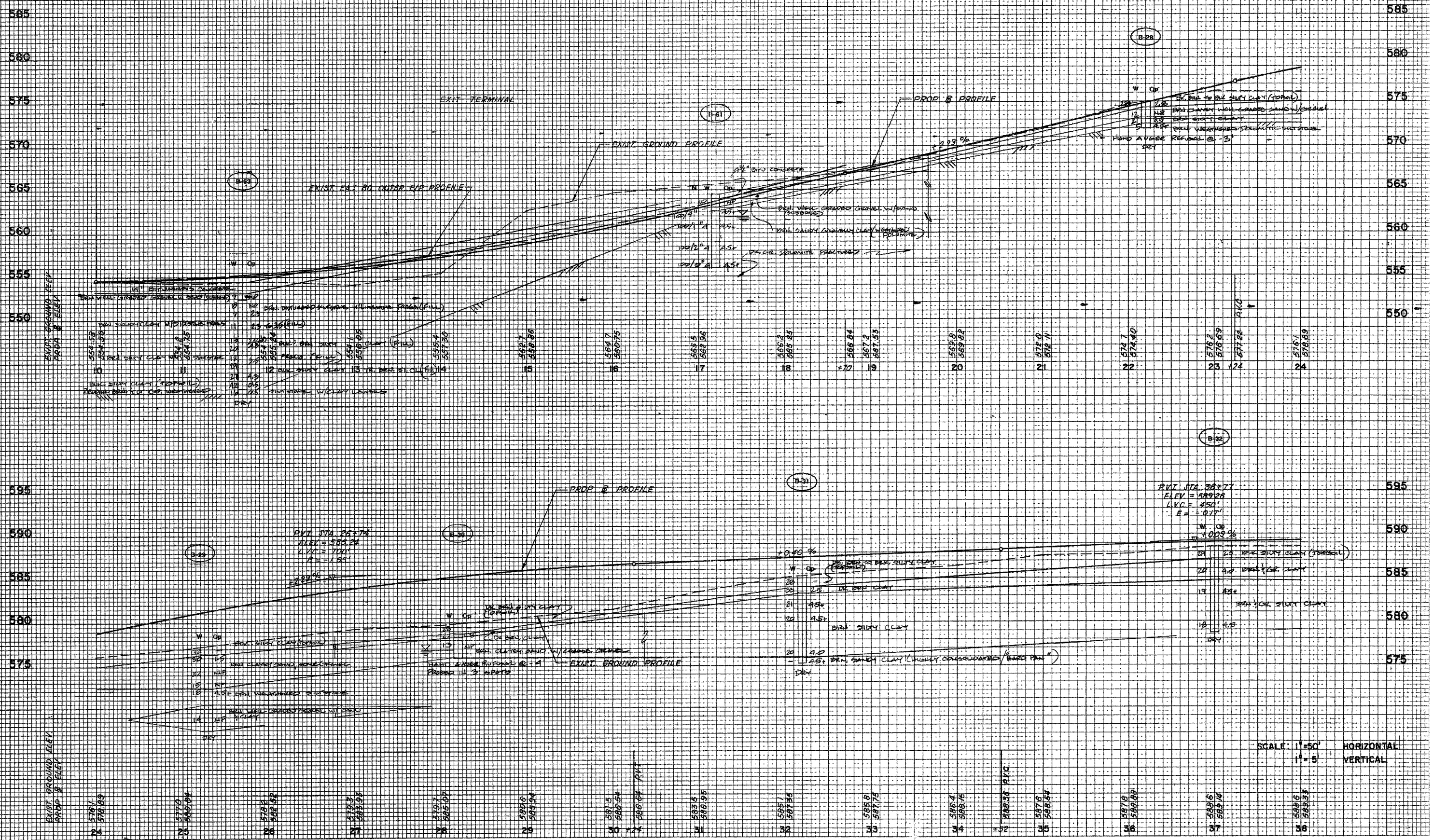

SCALE: 1"=50' HORIZONTAL
1"=5' VERTICAL