

PLAN

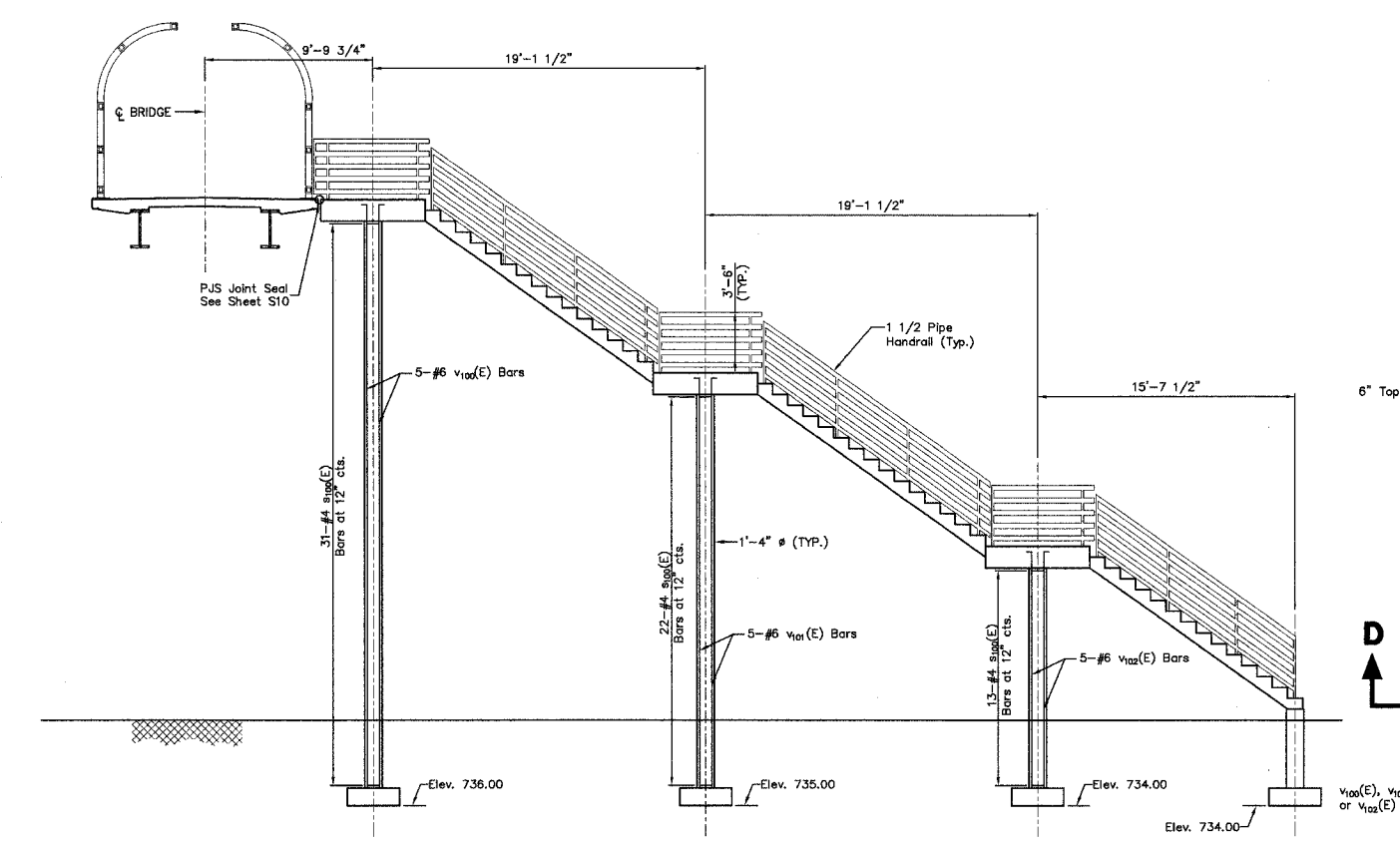

ELEVATION

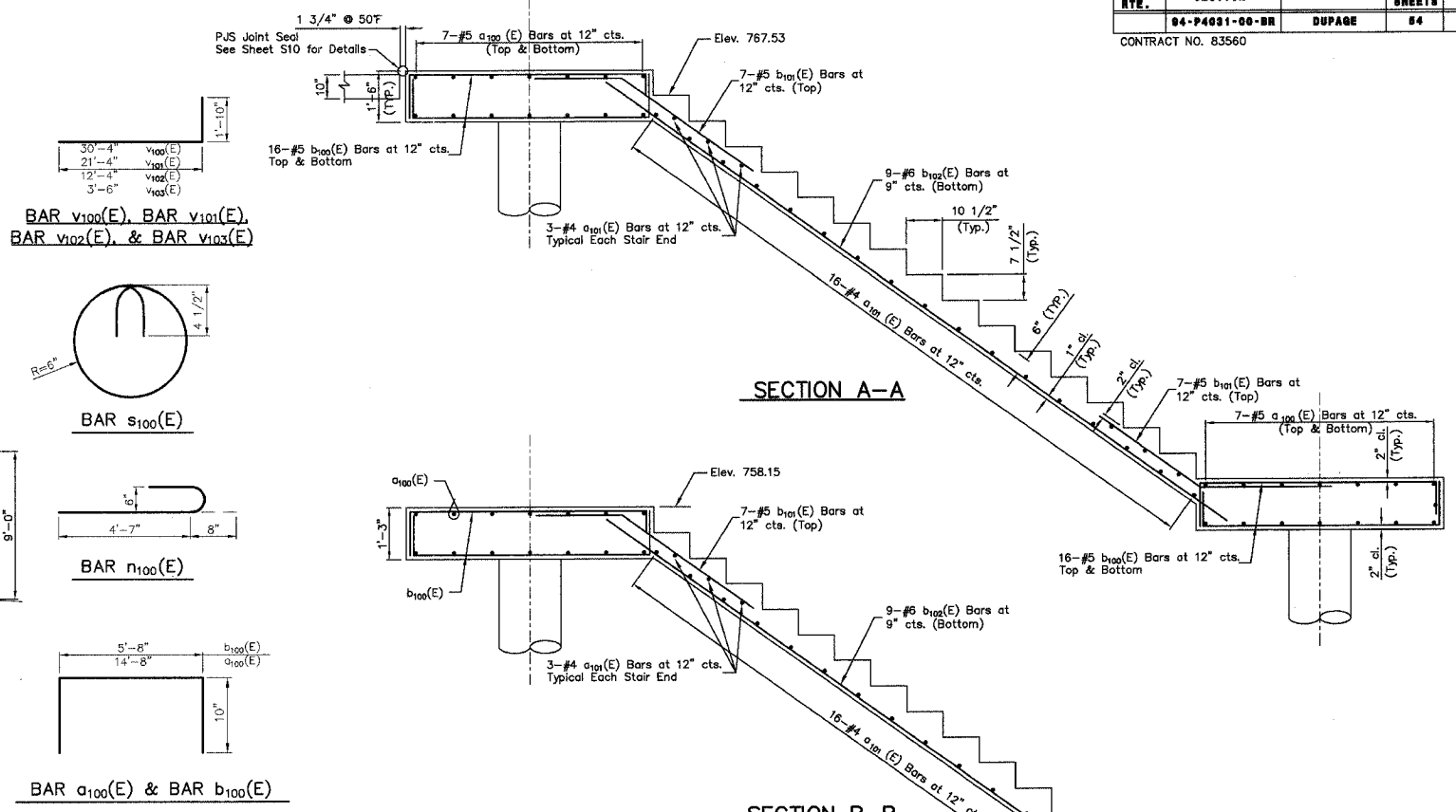

SECTION A-A

SECTION B-B

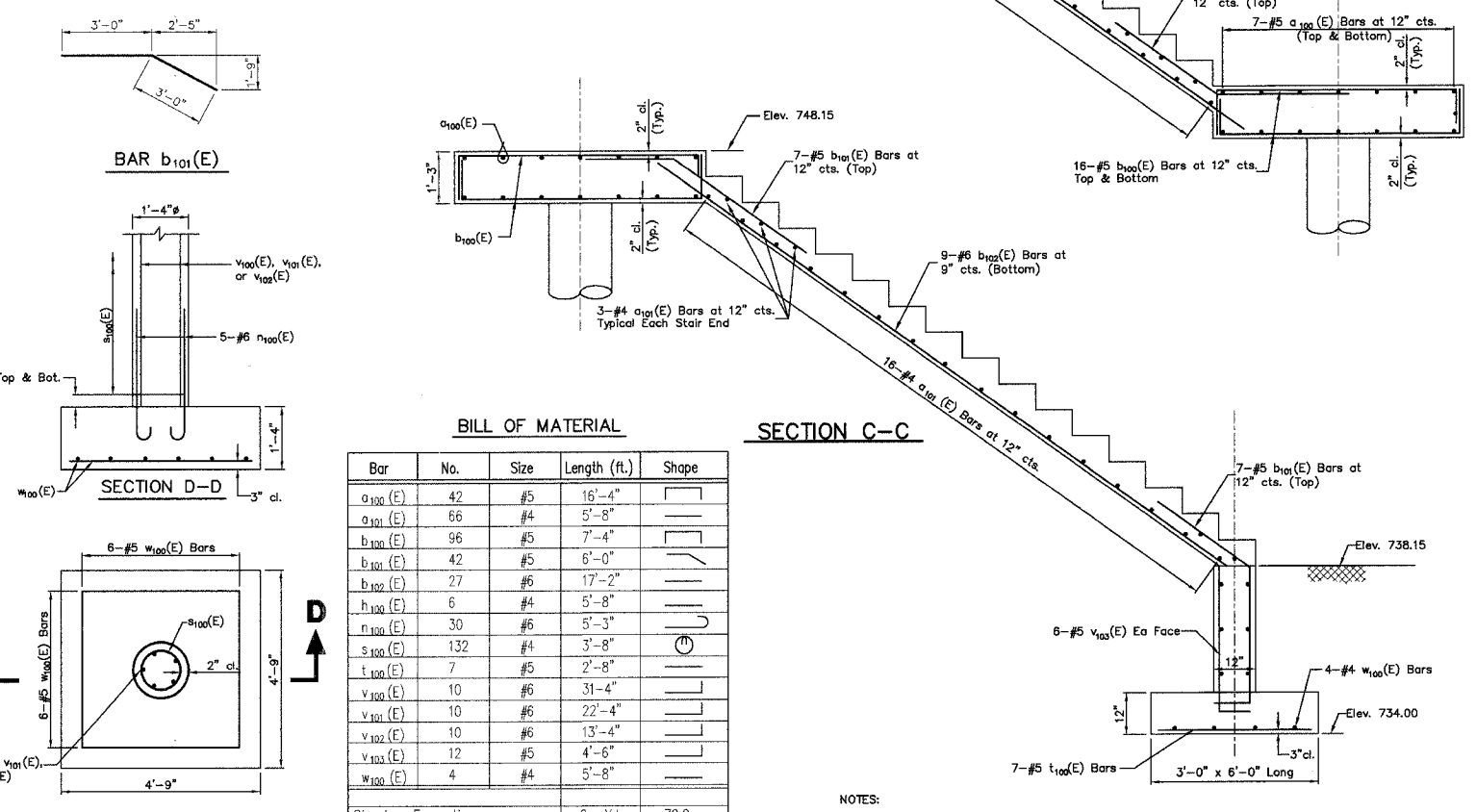

SECTION C-C

COLUMN FOOTING PLAN

BILL OF MATERIAL

| Bar | No. | Size | Length (ft.) | Shape |
|----------------------|-----|------|--------------|-------|
| a ₁₀₀ (E) | 42 | #5 | 16'-4" | □ |
| a ₁₀₁ (E) | 66 | #4 | 5'-8" | — |
| b ₁₀₀ (E) | 96 | #5 | 7'-4" | — |
| b ₁₀₁ (E) | 42 | #5 | 6'-0" | — |
| b ₁₀₂ (E) | 27 | #6 | 17'-2" | — |
| h ₁₀₀ (E) | 6 | #4 | 5'-8" | — |
| n ₁₀₀ (E) | 30 | #6 | 5'-3" | — |
| s ₁₀₀ (E) | 132 | #4 | 3'-8" | ○ |
| t ₁₀₀ (E) | 7 | #5 | 2'-8" | — |
| v ₁₀₀ (E) | 10 | #6 | 31'-4" | — |
| v ₁₀₁ (E) | 10 | #6 | 22'-4" | — |
| v ₁₀₂ (E) | 10 | #6 | 13'-4" | — |
| v ₁₀₃ (E) | 12 | #5 | 4'-6" | — |
| w ₁₀₀ (E) | 4 | #4 | 5'-8" | — |

NOTES:

- Pipe handrail shall be furnished, erected and painted as specified in Section 510 "Pipe Handrail" of the Standard Specifications.
- Maximum design soil pressure under footings = 2000 psf

PREPARED FOR:
WHEATON PARK DISTRICT
 666 S. MAIN STREET
 WHEATON, ILLINOIS 60187

PREPARED BY:
CEMCON, Ltd.
 Consulting Engineers, Land Surveyors & Planners
 2280 White Oak Circle, Suite 100
 Aurora, Illinois 60504-9675
 Ph: 630.862.2100 Fax: 630.862.2199
 E-Mail: cadd@cemcon.com Website: www.cemcon.com

REVISIONS

| NO. | DATE | DESCRIPTION | NO. | DATE | DESCRIPTION |
|-----|------|-------------|-----|------|-------------|
| | | | | | |
| | | | | | |
| | | | | | |

STAIR DETAILS
PEDESTRIAN/BICYCLE BRIDGE OVER UNION PACIFIC RAILROAD

| | | | | |
|----------------------|---------------|------------------|-------------------|--------------------|
| FILE NAME: STAIR_DET | DSGN. BY: MMH | JOB NO.: 551.007 | FLD. BK./PG.: --- | SHEET NO. 32 of 54 |
| DISC. NUMBER: 551007 | DRN. BY: RDS | DATE: 04-26-04 | SCALE: 1" = --- | |