

B.M. - 60d Spike in PP 34' Rt.
Sta. 10+94, Elev. = 198.55

B.M. - 60d Spike in PP 34' Rt.
Sta. 9+04, Elev. = 200.00

CO. RTE	ROAD DISTRICT	COUNTY	TOTAL SHEETS	SHEET NO.
CR 22	N/A	Lee	17	3
SECTION: 03-00284-00-BR				

TRAFFIC BARRIER TERMINAL TYPE 5A

LOCATION	EACH
LT STA. 10+27.5 TO LT STA. 10+40.75	1
RT STA. 10+27.5 TO RT STA. 10+40.75	1
LT STA. 9+72.5 TO LT STA. 9+59.25	1
RT STA. 9+72.5 TO RT STA. 9+59.25	1
TOTAL 4 EACH	

TRAFFIC BARRIER TERMINAL TYPE 1 SPECIAL (TANGENT)

LOCATION	EACH
LT STA. 12+03.25 TO LT STA. 12+53.25	1
RT STA. 7+96.75 TO RT STA. 7+46.75	1
LT STA. 8+84.25 TO LT STA. 8+34.25	1
RT STA. 11+15.75 TO RT STA. 11+65.75	1
TOTAL 4 EACH	

STEEL PLATE BEAM GUARD RAIL TYPE "A"

LOCATION	FOOT
LT STA. 10+40.75 TO LT STA. 12+03.25	162.5
RT STA. 9+59.25 TO RT STA. 7+96.75	162.5
LT STA. 10+40.75 TO LT STA. 11+15.75	75.0
RT STA. 9+59.25 TO RT STA. 8+84.25	75.0
TOTAL 475 FOOT	

UTILITIES

GAS: NICOR
(630) 983-8676
NAPEVILLE, ILLINOIS

ELECTRIC: COMMONWEALTH EDISON COMPANY
(800) 334-7861
ROCKFORD, ILLINOIS

TELEPHONE: GALLATIN RIVER COMMUNICATIONS
(815) 288-0034
DIXON, ILLINOIS

THE LOCATIONS OF UTILITY FACILITIES AS SHOWN ON THESE PLANS ARE AN ESTIMATE AND NOT INTENDED AS FIELD LOCATIONS FOR CONSTRUCTION. THE CONTRACTOR IS RESPONSIBLE FOR CONTACTING ALL UTILITIES PRIOR TO CONSTRUCTION AND CALLING J.U.L.L.E. AT 800-882-0123 FOR CONFIRMATION OF EXISTING UTILITY LOCATIONS.

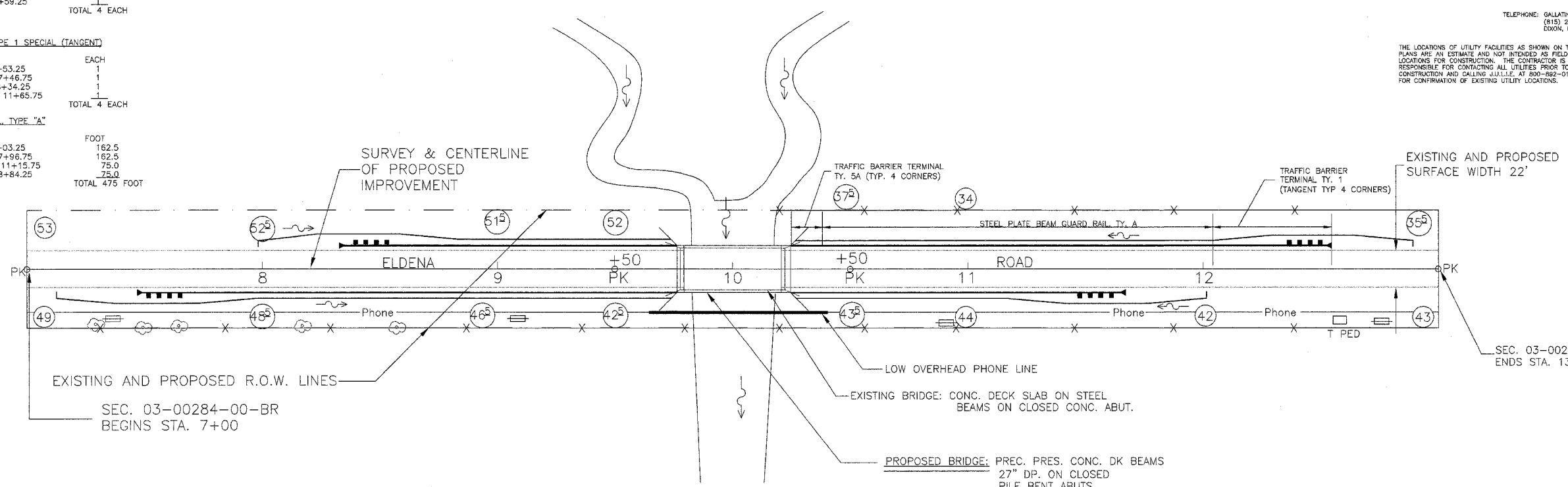

SCALES:
1" = 25' HOR
1" = 10' VER

SEC. 03-00284-00-BR
BEGINS STA. 7+00

SEC. 03-00284-00-BR
ENDS STA. 13+00

