

RTE.	SECTION	COUNTY	TOTAL SHEETS	SHEET NO.
FA180	150-2/HBR	LA SALLE	460	90
STA.	TO STA.			
FED. ROAD DIST. NO.	ILLINOIS FED. AID PROJECT			

CONTRACT NO. 86603

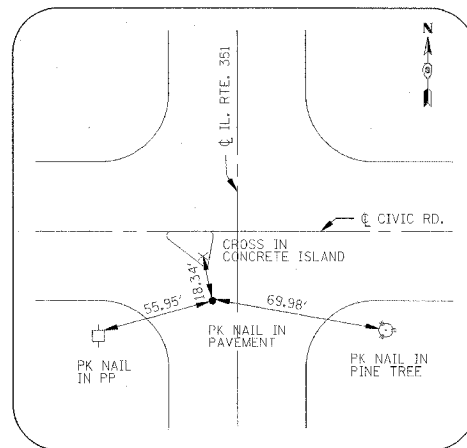

CONTROL POINT #500

PK NAIL IN PAVEMENT
STA. 45+45.71, 16.89' LT.
N. 48,305.71 E. 65,717.57

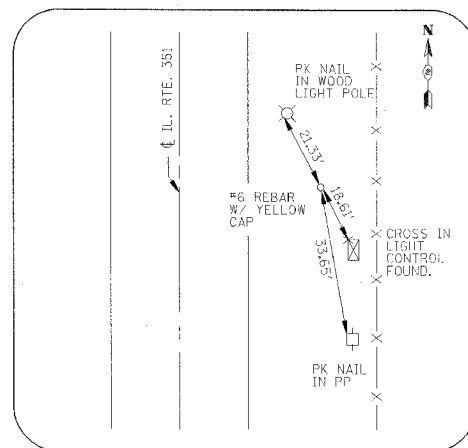

CONTROL POINT #501

#6 REBAR WITH YELLOW CAP
STA. 52+66.80, 72.77' RT.
N. 49,031.23 E. 65,757.87

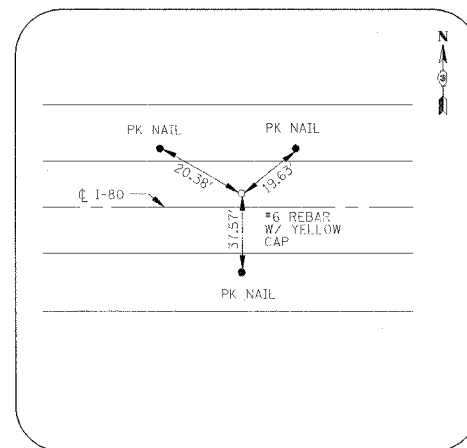

CONTROL POINT #505

#6 REBAR WITH YELLOW CAP
STA. 642+43.22, 13.47' LT.
N. 49,673.49 E. 64,285.93

CONTROL POINT COORDINATES		
POINT	NORTHING	EASTING
500	48305.71	65717.57
501	49031.23	65757.87
505	49673.49	64285.93

RAMP E COORDINATES		
POINT	NORTHING	EASTING
P.O.T.	50049.78	67478.83
P.C.1	50093.58	66681.78
P.I.1	50105.12	66471.86
P.T.1	50223.54	66298.14
P.C.2	50406.71	66031.21
P.I.2	50463.24	65948.28
P.T.2	50475.09	65848.63

RAMP F COORDINATES		
POINT	NORTHING	EASTING
P.C.1	50439.26	65844.36
P.I.1	50373.02	66401.45
P.T.1	50104.68	65908.78
P.C.2	50104.68	65908.78
P.I.2	50068.70	65842.72
P.T.2	50066.81	65767.51
P.C.3	50066.81	65767.51
P.I.3	50057.27	65534.47
P.T.3	50019.11	65304.38
P.C.4	50019.11	65304.38
P.I.4	49909.16	64551.56
P.T.4	49523.02	63896.03
P.C.5	49523.02	63896.03
P.I.5	49365.72	63639.63
P.T.5	49170.72	63410.61

RAMP G COORDINATES		
POINT	NORTHING	EASTING
P.O.T.	48920.04	65721.15
P.C.1	49377.37	65705.04
P.I.1	49631.50	65696.10
P.T.1	49780.12	65902.43
P.C.2	49780.12	65902.43
P.I.2	49920.44	66097.24
P.T.2	49925.35	66337.27
P.O.T.	49951.87	67632.57

ROUTE 351 COORDINATES		
POINT	NORTHING	EASTING
P.O.T.	47346.68	65800.23
P.I.	48344.28	65730.89
P.I.	48560.61	65717.81
P.C.1	49353.22	65663.28
P.I.1	49501.57	65653.08
P.T.1	49646.71	65620.70
P.C.2	49921.46	65559.41
P.I.2	50040.03	65532.96
P.T.2	50160.73	65546.78
P.C.3	50160.73	65546.78
P.I.3	50341.24	65567.45
P.T.3	50432.14	65724.76
P.C.4	50432.14	65724.76
P.I.4	50464.91	65781.46
P.T.4	50457.18	65846.49

I-80 COORDINATES		
POINT	NORTHING	EASTING
P.O.T.	48358.04	62673.92
P.C.	48782.13	63068.49
P.I.	49999.24	64200.84
P.T.	50000.02	65863.24
P.O.T.	50001.03	67999.90

RAMP H COORDINATES		
POINT	NORTHING	EASTING
P.C.1	49519.58	64113.57
P.I.1	49648.34	64410.00
P.T.1	49735.79	64721.13
P.C.2	49774.01	64858.88
P.I.2	49832.02	65065.27
P.T.2	49775.16	65271.98
P.C.3	49775.16	65271.98
P.I.3	49688.82	65585.84
P.T.3	49365.00	65619.05
P.O.T	48909.77	65665.72

REVISIONS NAME	DATE

ILLINOIS DEPARTMENT OF TRANSPORTATION

COORDINATE TABLES AND TIES

F.A.I. 80 AT ILLINOIS ROUTE 351

SCALE: NONE
DATE: 09/04

DRAWN BY: JDK
CHECKED BY: MTD