

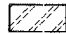



RTE.	SECTION	COUNTY	TOTAL SHEETS	SHEET NO.
FA180	150-21HBR	LA SALLE	440	54
STA.	TO STA.			
FED. ROAD DIST. NO.	ILLINOIS FED. AID PROJECT			

**CONTRACT NO. 86603**

**LEGEND**

-  PAVEMENT REMOVAL
-  PAVED SHOULDER REMOVAL
-  BITUMINOUS CONCRETE PAVEMENT (FULL DEPTH), SUPERPAVE, 16"
-  BITUMINOUS SHOULDERS, SUPERPAVE, 8" OR 12 1/2"
-  AGGREGATE SHOULDERS, TYPE B
-  SUB-BASE GRANULAR MATERIAL, TYPE A, 12"

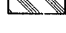
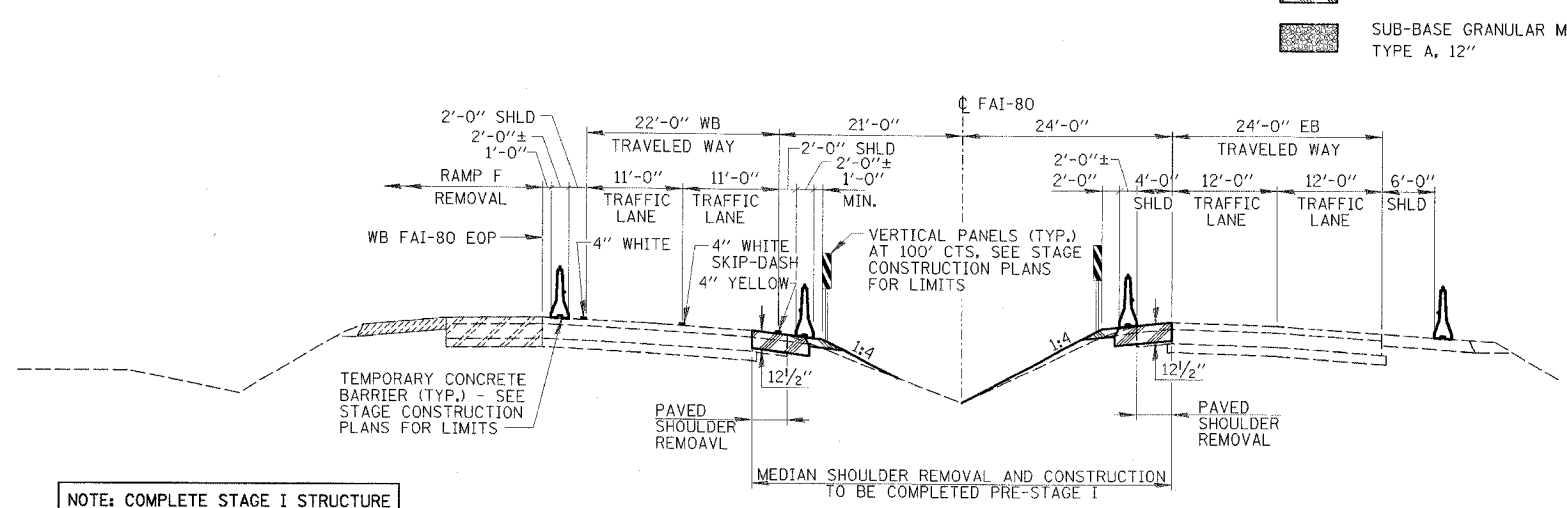

NOTE: COMPLETE STAGE I STRUCTURE REMOVAL AND CONSTRUCTION IN THIS STAGE. SEE STRUCTURE PLANS FOR DETAILS.

**FAI-80 & RAMP F  
STAGE I REMOVAL/CONSTRUCTION**

- ① RAMP F CONSTRUCTION ADJACENT TO FAI-80 MAY COMMENCE IN STAGE I AS SOON AS REMOVAL OPERATIONS ALLOW AND MUST BE COMPLETED PRIOR TO TEMPORARY CONCRETE BARRIER REMOVAL.
- ② & VARIES (SEE CROSS SECTIONS).
- ③ VARIES. SEE PROFILE SHEETS AND RAMP TERMINAL ELEVATIONS SHEETS FOR DETAILS.

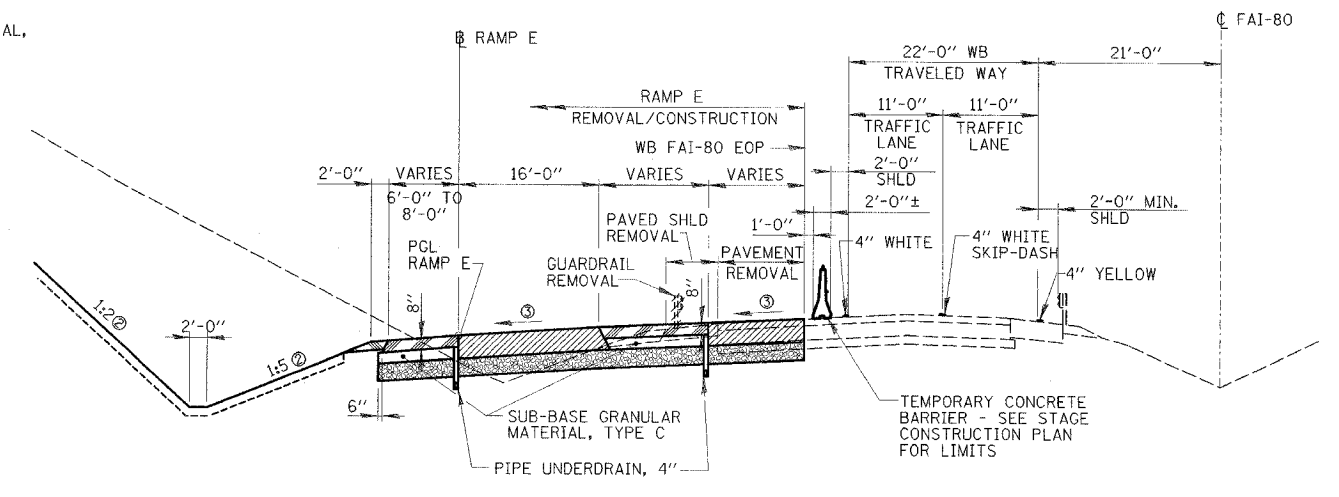

**FAI-80 & RAMP E  
STAGES IIIa AND IIIb REMOVAL/CONSTRUCTION**

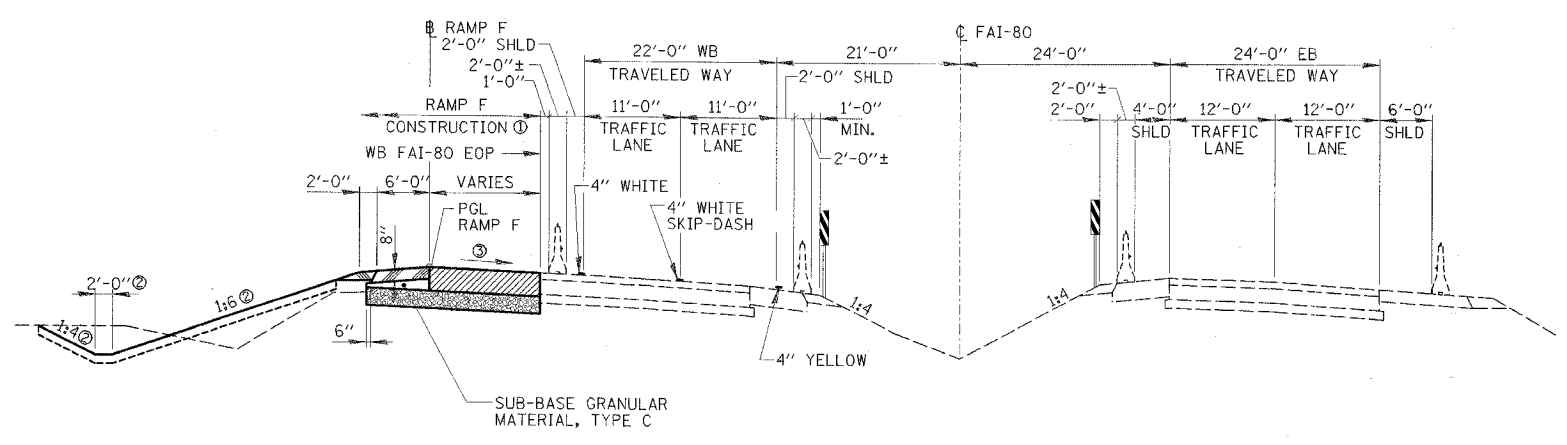

NOTE: COMPLETE STAGE II STRUCTURE REMOVAL AND CONSTRUCTION IN THIS STAGE. SEE STRUCTURE PLANS FOR DETAILS. COMPLETE INERTIAL BARRIER INSTALLATIONS BEFORE REMOVING TEMPORARY CONCRETE BARRIER.

**FAI-80 & RAMP F  
STAGE II REMOVAL/CONSTRUCTION**

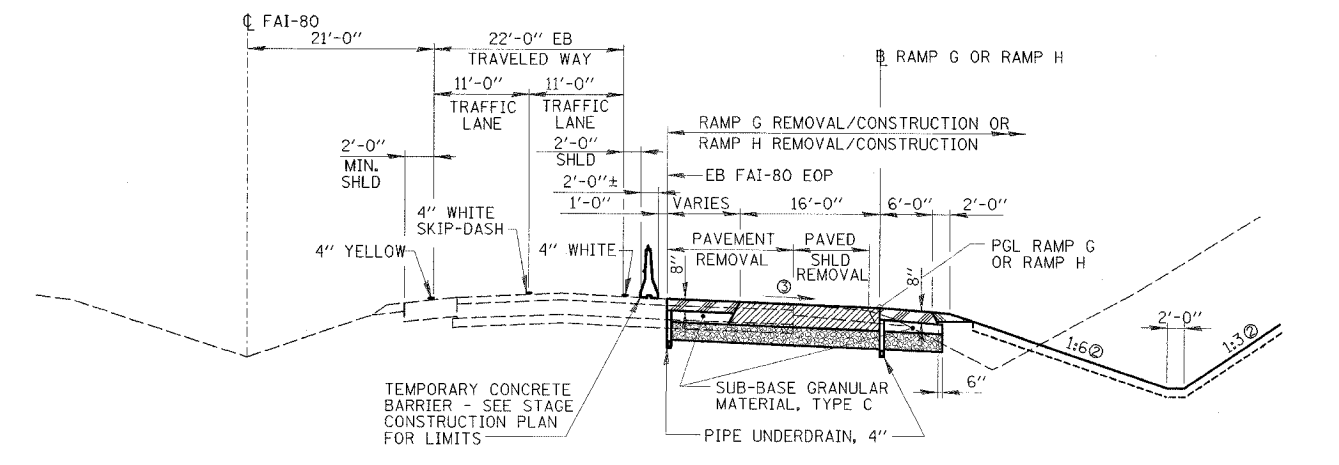

**FAI-80 & RAMPS G & H  
STAGES IVa, IVb, Va, AND Vb  
REMOVAL/CONSTRUCTION**

REVISIONS	NAME

ILLINOIS DEPARTMENT OF TRANSPORTATION  
**STAGE CONSTRUCTION SECTIONS**  
 F.A.I. 80 AT ILLINOIS ROUTE 351  
 F.A.I. 80  
 SCALE: NONE  
 DATE: 09/04  
 DRAWN BY: DWH  
 CHECKED BY: MTD