

RTE.	SECTION	COUNTY	TOTAL SHEETS	SHEET NO.
FA180	150-2HBR	LA SALLE	460	74
STA. 260+50		TO STA. 60+70		
FED. ROAD DIST. NO.		ILLINOIS	FED. AID PROJECT	

CONTRACT NO. 86603

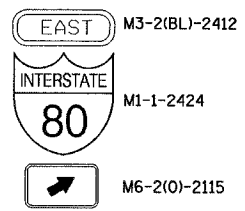
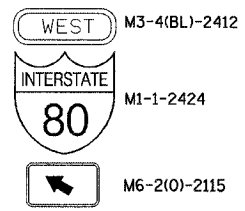
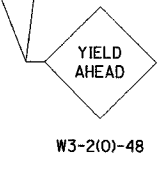
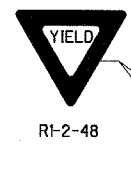
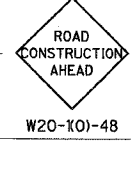
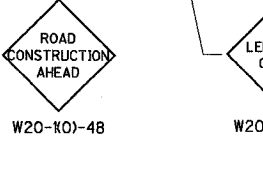
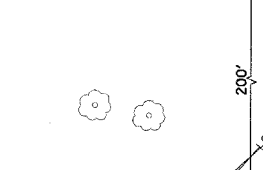
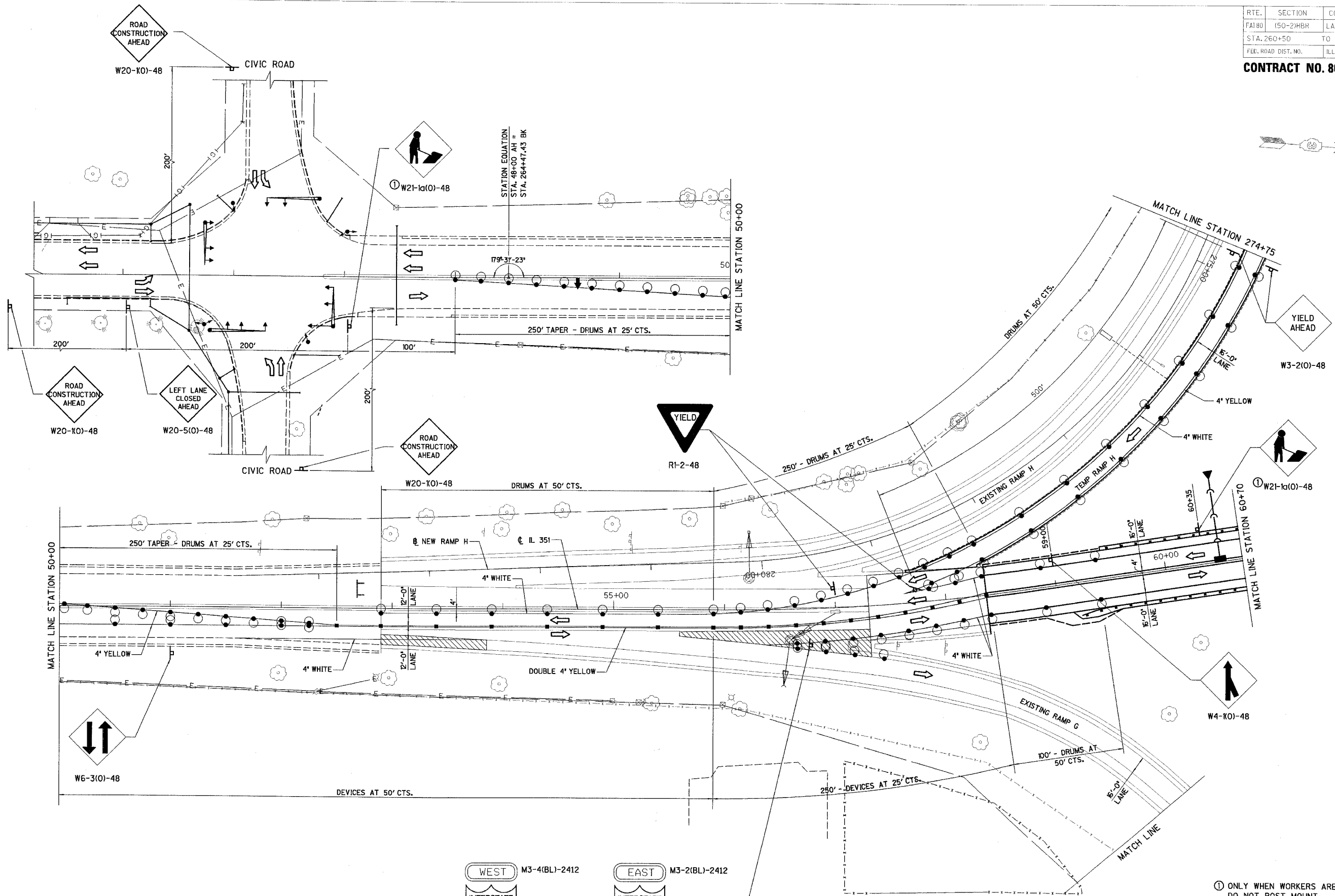

① ONLY WHEN WORKERS ARE PRESENT. DO NOT POST MOUNT.

ILLINOIS DEPARTMENT OF TRANSPORTATION
STAGE IVa CONSTRUCTION PLAN
 F.A.I. 80 AT ILLINOIS ROUTE 351
 STATION 260+50 TO STATION 60+70
 DATE: 09/04
 DRAWN BY: MES
 CHECKED BY: VTD

REVISIONS	NAME	DATE

