

FOR INTERSECTION
DETAILS SEE
SHEET 25

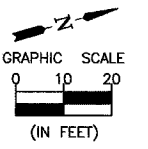

PIPE CULVERT, CLASS D, TYPE 1 15" 32 FOOT
US 27' LT. STA. 29+01.3, ELEV. 541.31
DS 27' LT. STA. 28+65.3, ELEV. 540.92
END SECTIONS 15" 2 EA.
TRENCH BACKFILL 3 CU. YD.

- BITUMINOUS SURFACE REMOVAL 1 1/2"

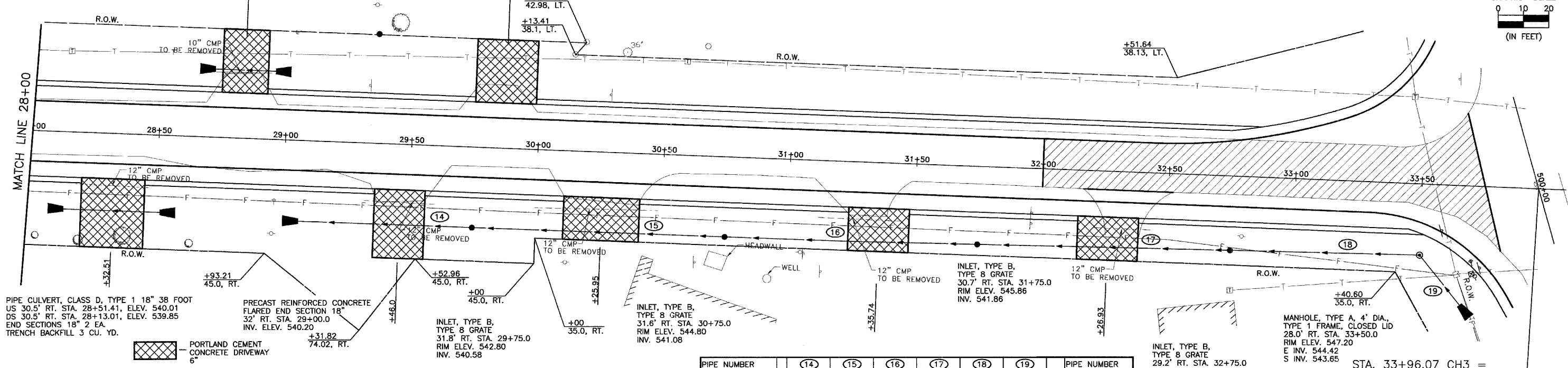

PIPE CULVERT, CLASS D, TYPE 1 18" 38 FOOT
US 30.5' RT. STA. 28+51.41, ELEV. 540.01
DS 30.5' RT. STA. 28+13.01, ELEV. 539.85
END SECTIONS 18" 2 EA.
TRENCH BACKFILL 3 CU. YD.

PRECAST REINFORCED CONCRETE
FLARED END SECTION 18"
32' RT. STA. 29+00.0
INV. ELEV. 540.20

INLET, TYPE B,
TYPE 8 GRATE
31.8' RT. STA. 29+75.0
RIM ELEV. 542.80
INV. 540.58

INLET, TYPE B,
TYPE 8 GRATE
31.6' RT. STA. 30+75.0
RIM ELEV. 544.80
INV. 541.08

INLET, TYPE B,
TYPE 8 GRATE
30.7' RT. STA. 31+75.0
RIM ELEV. 545.86
INV. 541.86

INLET, TYPE B,
TYPE 8 GRATE
29.2' RT. STA. 32+75.0
RIM ELEV. 546.76
INV. 542.88

MANHOLE, TYPE A, 4' DIA.,
TYPE 1 FRAME, CLOSED LID
28.0' RT. STA. 33+50.0
RIM ELEV. 547.20
E INV. 544.42
S INV. 543.65

STA. 33+96.07 CH3 =
STA. 500+00 N 42nd ROAD

PRECAST REINFORCED CONCRETE
FLARED END SECTION 18"
56.24' RT. STA. 33+74.47
INV. ELEV. 545.52

B.M. # 4 ELEV. 549.36
CHISELED "X" ON S.W. BOLT OF
WESTERN SAND GRAVEL SIGN AT
ENTRANCE TO PIT.

PIPE NUMBER	14	15	16	17	18	19	PIPE NUMBER
SIZE	18	18	18	18	18	18	SIZE
LENGTH	69'	100'	100'	100'	75'	31.4'	LENGTH
CLASS	A	A	A	A	A	A	CLASS
TYPE	1	1	1	1	1	1	TYPE
% SLOPE	0.50	0.50	0.78	1.02	1.02	3.5	% SLOPE
TRENCH BACKFILL	3	8	9	8	--	--	TRENCH BACKFILL

B.M. # 6 ELEV. 543.48
NAIL SET IN 4TH POWER POLE
NORTH OF RIVER, EAST SIDE OF ROAD
STA. 31+05.07, 36.35' RT.

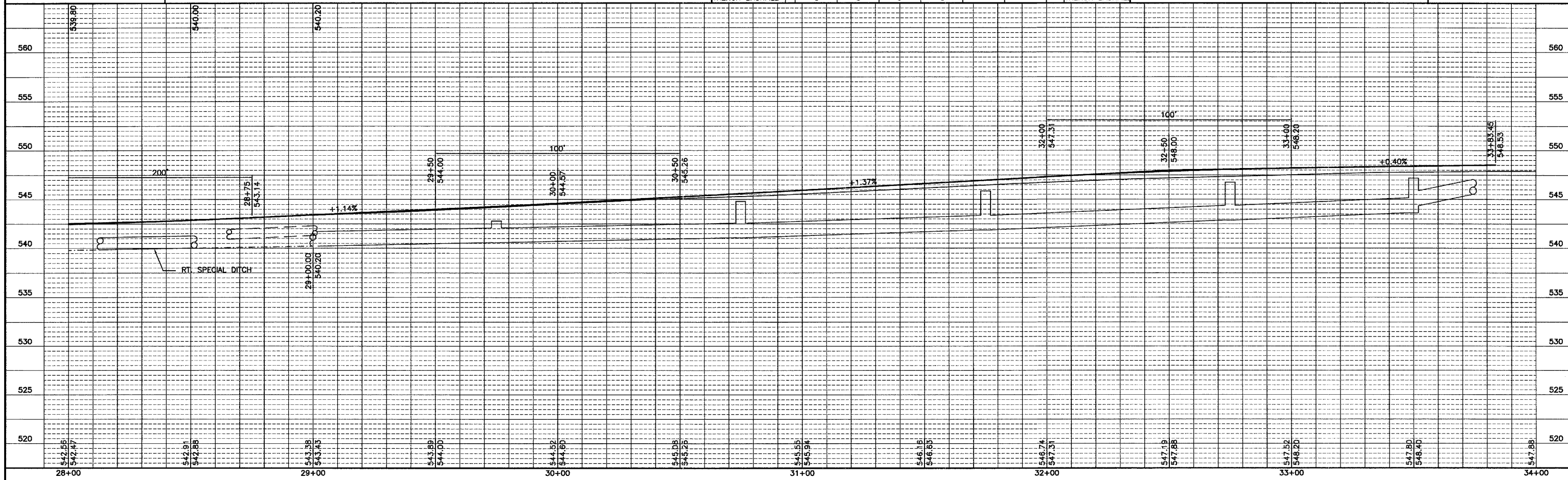

DRAWN BY: ARR
CHECKED BY: JKC

11174-01/FINAL/
CAD/DWG: 28-34R
XREF/FIN/TOPO

REVISIONS
DATE BY
3/08/04 NET

CHAMLIN ASSOCIATES
PERU MORRIS
ILLINOIS

FAS 259/COUNTY HIGHWAY 3 OVER FOX RIVER
SECTION 98-00545-00-BR
LASALLE COUNTY

PLAN AND PROFILE
STA. 28+00.00 TO 34+00.00

SCALE: AS NOTED
FILE NO.: 11174.01Y-1
SHEET 14
OF 79