

STEEL PLATE BEAM GUARDRAIL, TYPE A - 63000000

STATION	STATION	LENGTH
RT OUT 449+27.00	TO 450+89.50	162.5
RT MED 448+54.50	TO 450+79.50	225.0
TOTAL = 387.5 FEET		

TRAFFIC BARRIER TERMINAL TYPE 1, SPECIAL (FLARED) - 63100169

STATION	STATION	EACH
RT OUT 448+77.00	TO 449+27.00	1
RT MED 448+04.50	TO 450+79.50	1
TOTAL = 2 EACH		

TRAFFIC BARRIER TERMINAL, TYPE 2 - 63100045

STATION	STATION	EACH
RT OUT 450+89.50	TO 451+02.75	1
RT MED 450+79.50	TO 450+92.75	1
TOTAL = 2 EACH		

F.A.I. RTE.	SECTION	COUNTY	TOTAL SHEETS	SHEET NO.
72		MACON	135	28
STA.	TO STA.			

FED. ROAD DIST. NO. ILLINOIS FED. AID PROJECT  
 (58-62,58-62-1,58-63)RS  
 CONTRACT NO. 90879  
 \*\* STA. 240+00 TO STA. 270+00 (F.A.I. 72 WB)  
 STA. 440+00 TO STA. 470+00 (F.A.I. 72 EB)  
 1"=100'

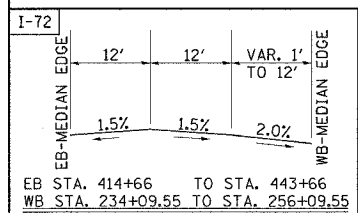
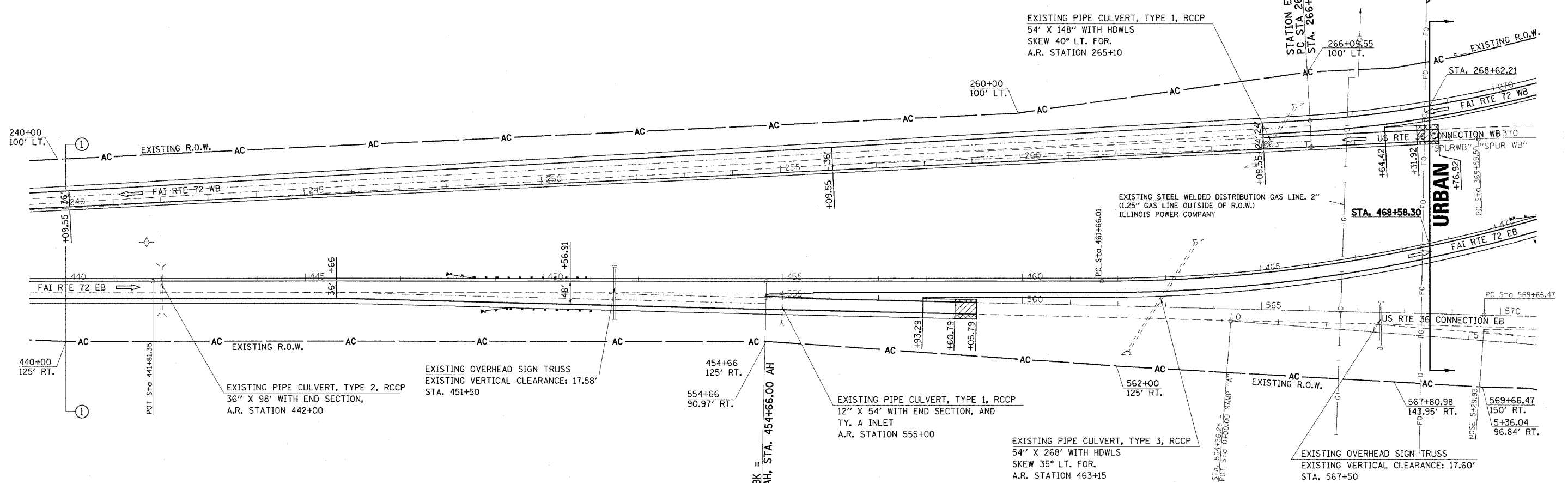
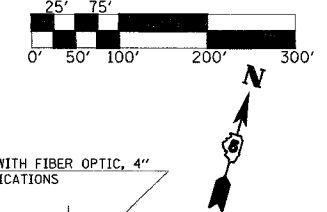

TYPICAL CROSS-SECTIONS

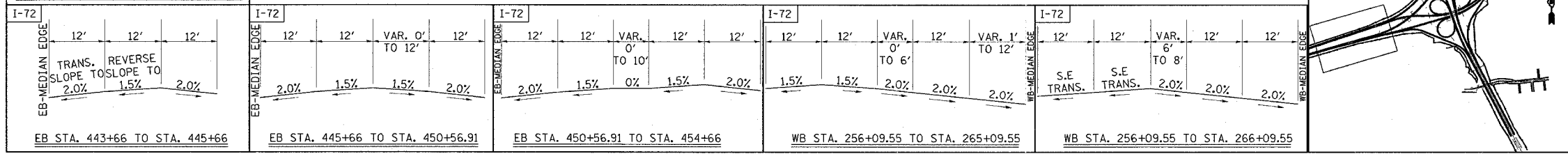

SEC. 14, T. 16 N., R. 1 E., 3RD P.M.

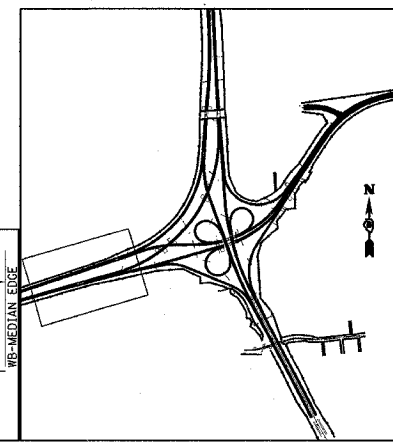

LEGEND

	BITUMINOUS SURFACE REMOVAL-BUTT JOINT
	P.C.C. SURFACE REMOVAL-BUTT JOINT

PLAN NOTE

UPON COMPLETION OF THE PROJECT, THE VERTICAL CLEARANCE OF ALL AFFECTED OVERHEAD SIGN TRUSSES SHALL BE VERIFIED AND REPORTED TO THE BUREAU OF OPERATIONS

REVISIONS

NAME	DATE

ILLINOIS DEPARTMENT OF TRANSPORTATION

SCALE: \_\_\_\_\_ DATE \_\_\_\_\_ DRAWN BY \_\_\_\_\_ CHECKED BY \_\_\_\_\_

STA. 440+00 TO 470+00