

**TRAFFIC BARRIER TERMINAL, TYPE 2 - 63100045**

STATION	STATION	EACH
LT OUT 324+51.28	TO 324+65.65	1
LT MED 324+56.28	TO 324+70.50	1
		TOTAL = 2 EACH

**GUARDRAIL REMOVAL - 63200310**

STATION	STATION	LENGTH
RT OUT 532+93.26	TO 533+93.26	100.0
RT MED 532+23.18	TO 533+93.26	175.0
LT OUT 536+00.50	TO 537+00.50	100.0
LT MED 536+00.50	TO 537+70.58	175.0
		TOTAL = 550.0 FEET

**STEEL PLATE BEAM GUARDRAIL, TYPE A - 63000000**

STATION	STATION	LENGTH
RT OUT 531+74.51	TO 533+62.01	187.5
RT MED 531+99.51	TO 533+62.01	162.5
LT OUT 324+65.50	TO 530+13.95	187.5
LT MED 324+70.50	TO 530+81.45	250.0
LT OUT 536+31.75	TO 538+19.25	187.5
LT MED 536+31.75	TO 537+94.25	162.5
		TOTAL = 1137.5 FEET

F.A.I. RTE.	SECTION	COUNTY	TOTAL SHEETS	SHEET NO.
72		MACON	135	31
STA. TO STA.		FED. ROAD DIST. NO. ILLINOIS FED. AID PROJECT		
CONTRACT NO. 00475				
* (58-62-58-62-1-58-63)RS				
** STA. 312+00 TO STA. 545+00 (F.A.I. 72 WB)				
STA. 516+00 TO STA. 545+00 (F.A.I. 72 EB)				

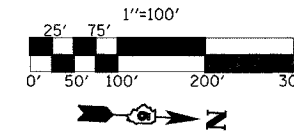

**TRAFFIC BARRIER TERMINAL, TYPE 6 - 63100085**

STATION	STATION	EACH
RT OUT 533+62.01	TO 533+95.16	1
RT MED 533+62.01	TO 533+95.16	1
LT OUT 535+98.60	TO 536+31.75	1
LT MED 535+98.60	TO 536+31.75	1
		TOTAL = 4 EACH

**TRAFFIC BARRIER TERMINAL, TYPE 1, SPECIAL (FLARED) - 63100169**

STATION	STATION	EACH
RT OUT 531+24.51	TO 531+74.51	1
RT MED 531+49.51	TO 531+99.51	1
LT OUT 530+13.95	TO 530+63.95	1
LT MED 530+81.45	TO 531+31.45	1
LT OUT 538+19.25	TO 538+69.25	1
LT MED 537+94.25	TO 538+44.25	1
		TOTAL = 6 EACH

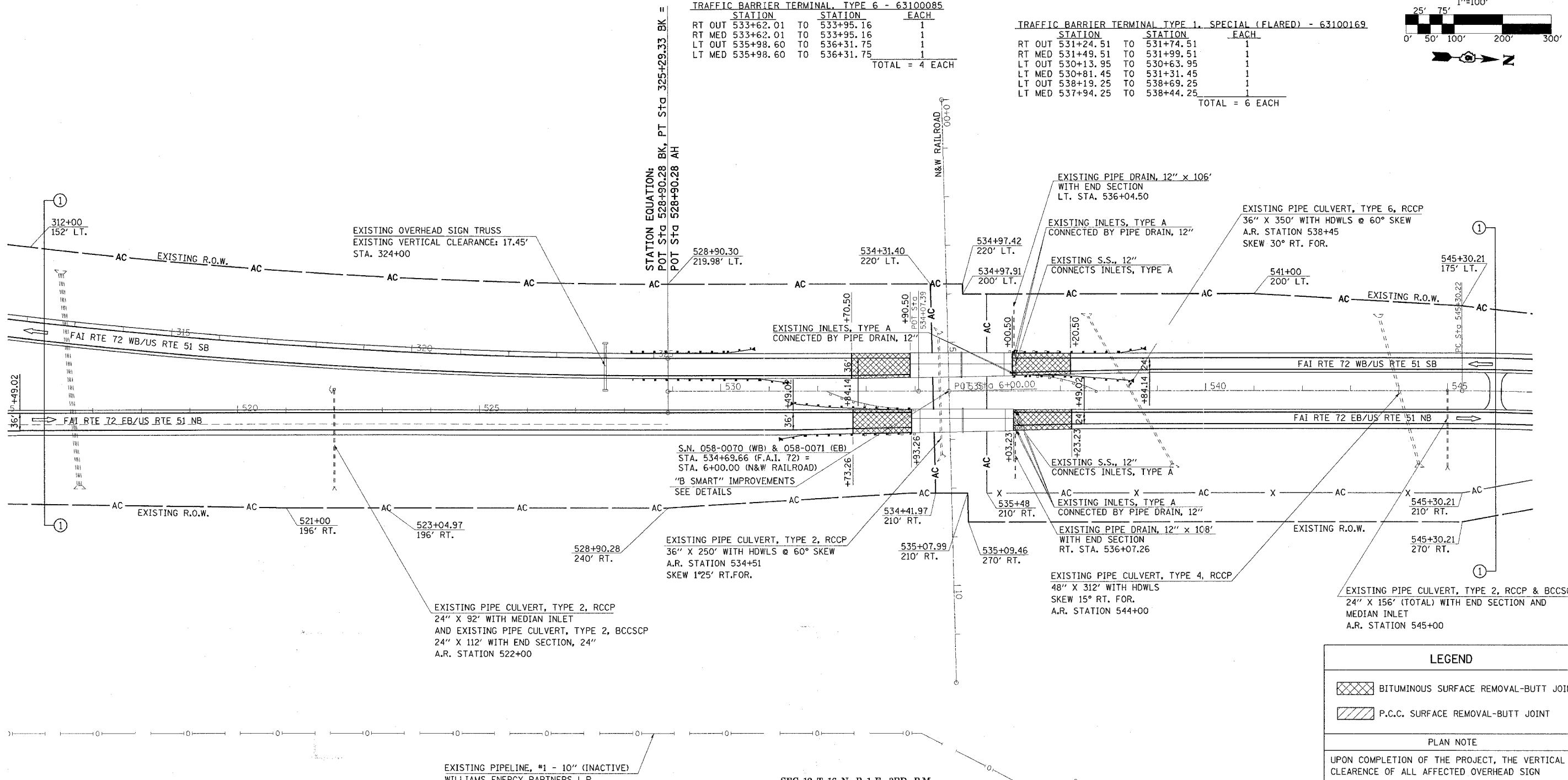

EXISTING PIPELINE, #1 - 10" (INACTIVE)  
WILLIAMS ENERGY PARTNERS L.P.  
SEC. 12, T. 16 N., R. 1 E., 3RD P.M.

**TYPICAL CROSS-SECTIONS**

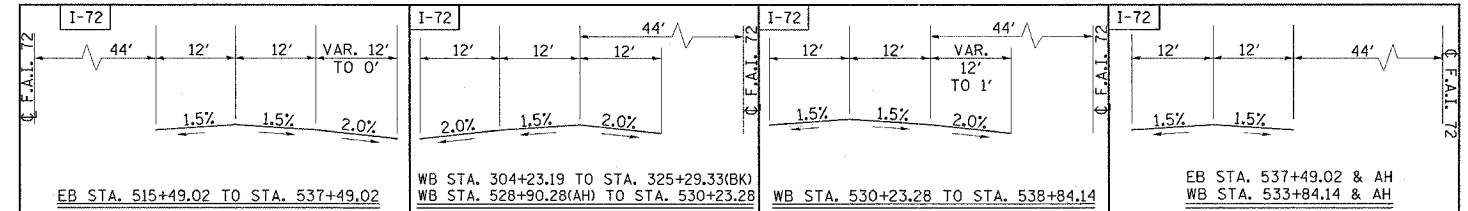

**LEGEND**

	BITUMINOUS SURFACE REMOVAL-BUTT JOINT
	P.C.C. SURFACE REMOVAL-BUTT JOINT

**PLAN NOTE**

UPON COMPLETION OF THE PROJECT, THE VERTICAL CLEARANCE OF ALL AFFECTED OVERHEAD SIGN TRUSSES SHALL BE VERIFIED AND REPORTED TO THE BUREAU OF OPERATIONS

**REVISIONS**

NAME	DATE

**ILLINOIS DEPARTMENT OF TRANSPORTATION**

SCALE: \_\_\_\_\_ DATE \_\_\_\_\_ DRAWN BY \_\_\_\_\_ CHECKED BY \_\_\_\_\_

**STA. 516+00 TO 546+00**