

F.A.I. RTE.	SECTION	COUNTY	TOTAL SHEETS	SHEET NO.
72		MACON	135	42
STA.	847+00 TO STA. 861+36.6			
FED. ROAD DIST. NO.	ILLINOIS FED. AID PROJECT			
• (58-62,58-62-1,58-63)RS				
CONTRACT NO. 90879				
1"=100'				

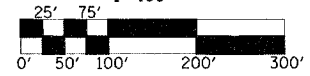

SECTION (58-62,58-62-1,58-63)RS  
ENDS STA. 861+36.68

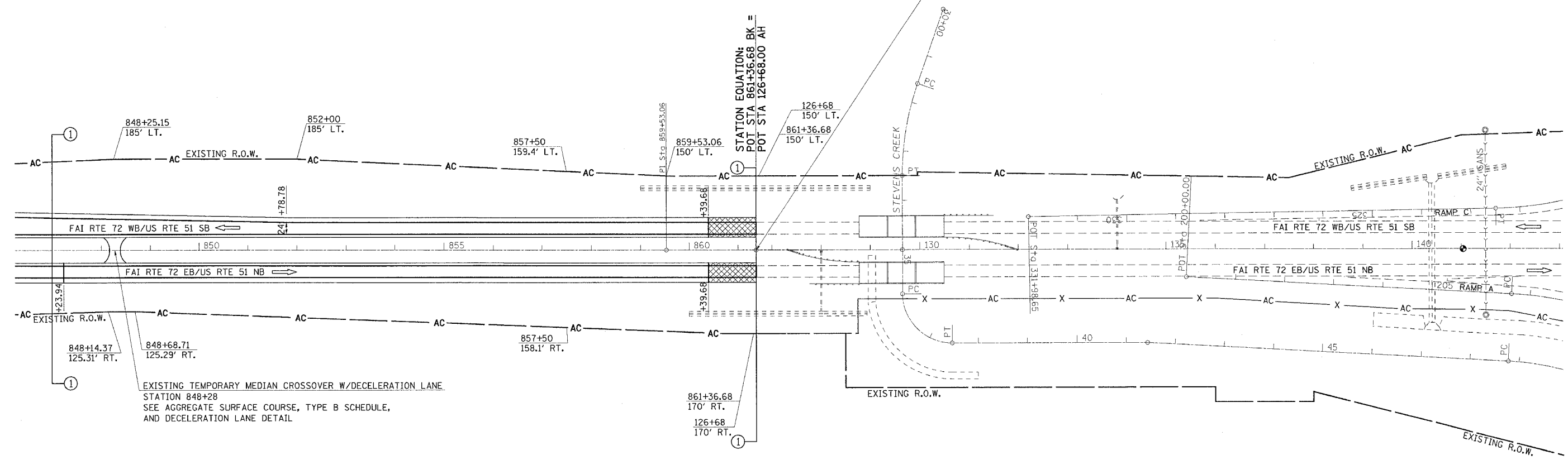

EXISTING TEMPORARY MEDIAN CROSSOVER W/DECELERATION LANE  
STATION 848+28  
SEE AGGREGATE SURFACE COURSE, TYPE B SCHEDULE,  
AND DECELERATION LANE DETAIL

LEGEND	
	BITUMINOUS SURFACE REMOVAL-BUTT JOINT
	P.C.C. SURFACE REMOVAL-BUTT JOINT

REVISIONS	
NAME	DATE

ILLINOIS DEPARTMENT OF TRANSPORTATION

SCALE: \_\_\_\_\_ DRAWN BY \_\_\_\_\_  
 DATE \_\_\_\_\_ CHECKED BY \_\_\_\_\_

SEC. 22, T. 17 N., R. 2 E., 3RD P.M.

STA. 847+00 TO 861+36.68