

DETAIL OF MEDIAN CROSS-OVER RECONSTRUCTION WITH DECELERATION LANES STA. 300+17

STA. 546+00
STA. 847+50

TYPICAL

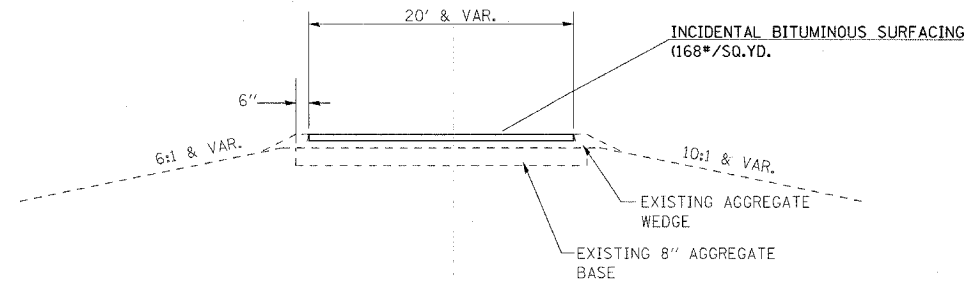

PLAN

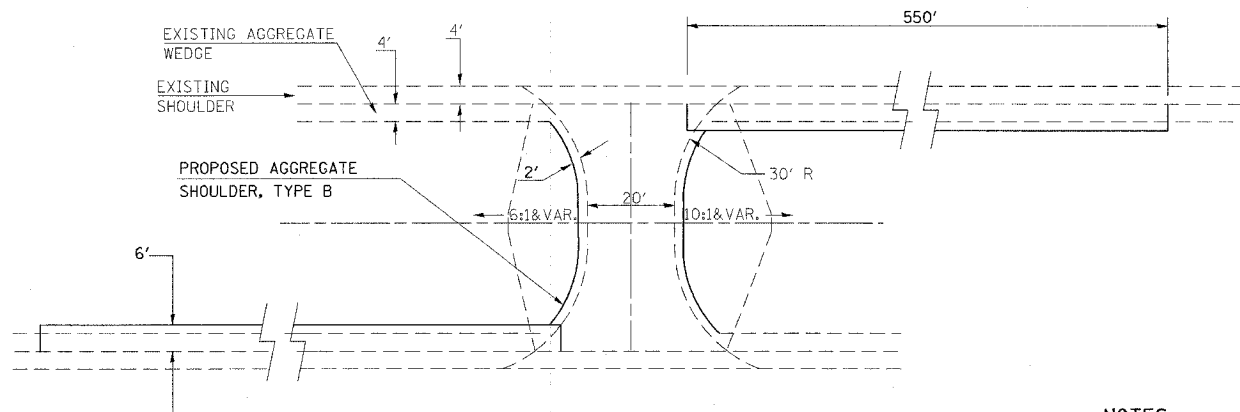

NOTES

- 1.) OMIT RUMBLE STRIPS ON SHOULDERS WITHIN THE LIMITS OF THE WIDENING AND MEDIAN CROSSOVER.
- 2.) REMOVAL OF EXISTING AGGREGATE SHOULDERS IS INCIDENTAL TO THE COST OF PROPOSED 8" BITUMINOUS CONCRETE BASE COURSE.

PROFILE

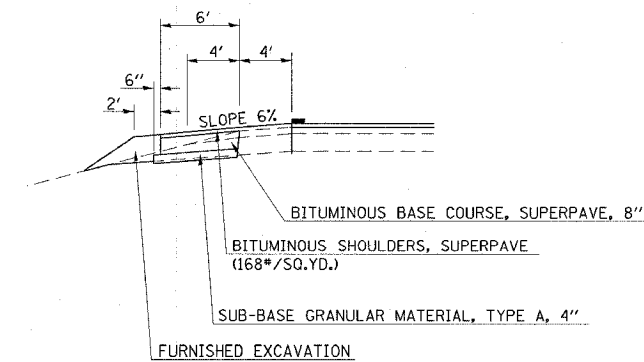
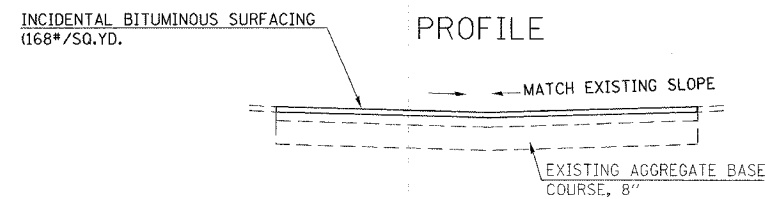

SECTION B-B

F.A.I. RTE.	SECTION	COUNTY	TOTAL SHEETS	SHEET NO.
72		MACON	135	116

• (58-62,58-62-1,58-63)RS
CONTRACT NO. 90879

I-72 FLOWLINE DETAIL UNDER STRUCTURES

STATION	TO	STATION
EB 631+23		EB 631+89
EB 706+10.5		EB 706+65.5
EB 894+68		EB 895+00
WB 2835+78		WB 2836+10
WB 707+62.5		WB 708+17.5
IL 121 909+63		911+57

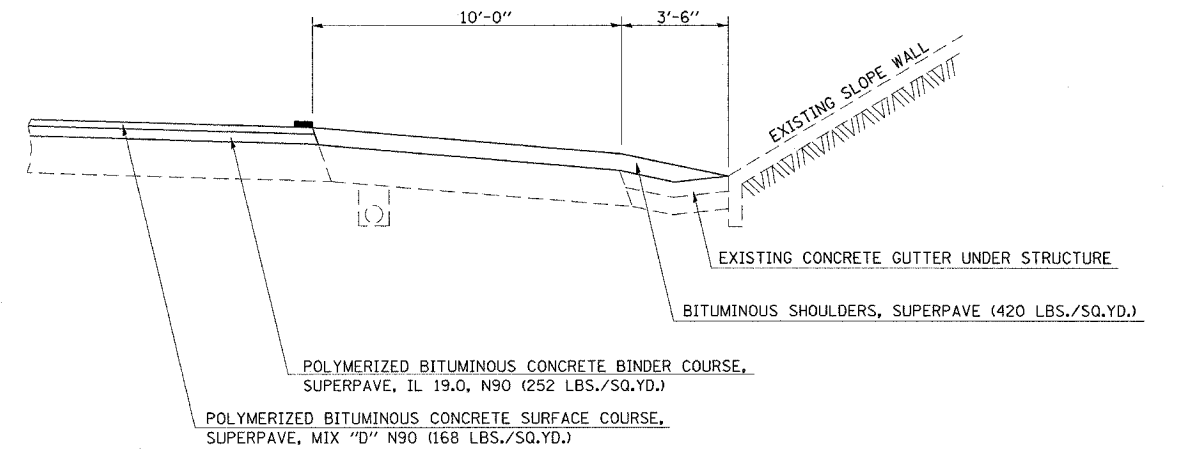

PAVEMENT PATCHING (PARTIAL DEPTH)

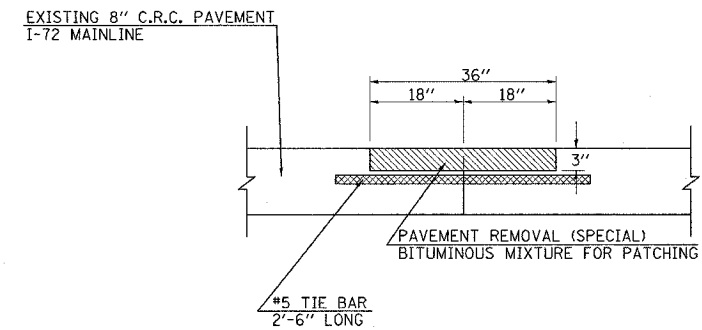

REMOVAL OF LOOSE MATERIAL BY COMPRESSED AIR

PAVEMENT REMOVAL SPECIAL

GENERAL NOTE

THE WORK REQUIRED TO CONSTRUCT THE PARTIAL DEPTH PATCH SHALL BE IN ACCORDANCE WITH AND PAID FOR AS SPECIFIED IN THE SPECIAL PROVISIONS ENTITLED "PAVEMENT PATCHING (PARTIAL DEPTH)"