

CONTRACT # 91260

ROUTE NO.	SECTION	COUNTY	TOTAL SHEETS	SHEET NO.
T.R. 408	98-02117-00-BR	SHELBY	14	4
ROAD DISTRICT	ILLINOIS	BIG SPRING		

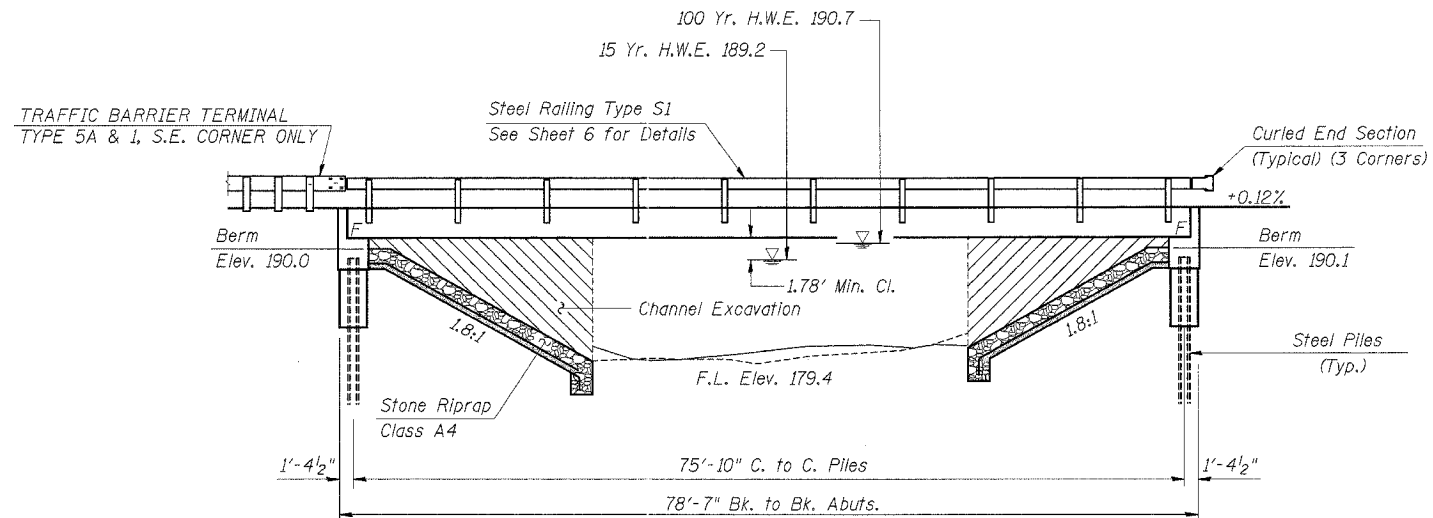

ELEVATION

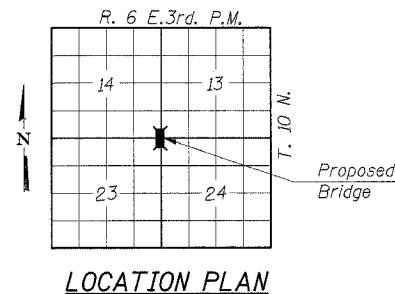

LOCATION PLAN

GENERAL NOTES

See Proposal for Boring data.  
 Reinforcement bars shall conform to the requirements of AASHTO M-31, M-42 or M-53, Grade 60.  
 Layout of slope protection system may be varied in the field to suit ground conditions as directed by the Engineer.  
 The Contractor shall drive 1 steel test pile in a permanent location at each abutment as directed by the engineer before ordering the remainder of the piles.

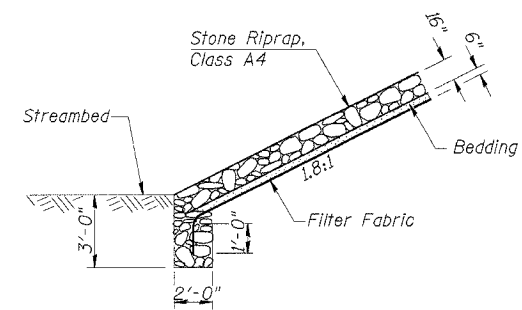

SECTION A-A RIPRAP PLACEMENT DETAIL

COPPERAS CREEK  
 BUILT 200\_ BY  
 BIG SPRING ROAD DISTRICT  
 SHELBY COUNTY  
 SEC. 98-02117-00-BR  
 F.A. PROJ. BROS-173(117)  
 STR. NO. 087-3510 LOADING HS20

LETTERING FOR NAME PLATE  
 See Std. 515001

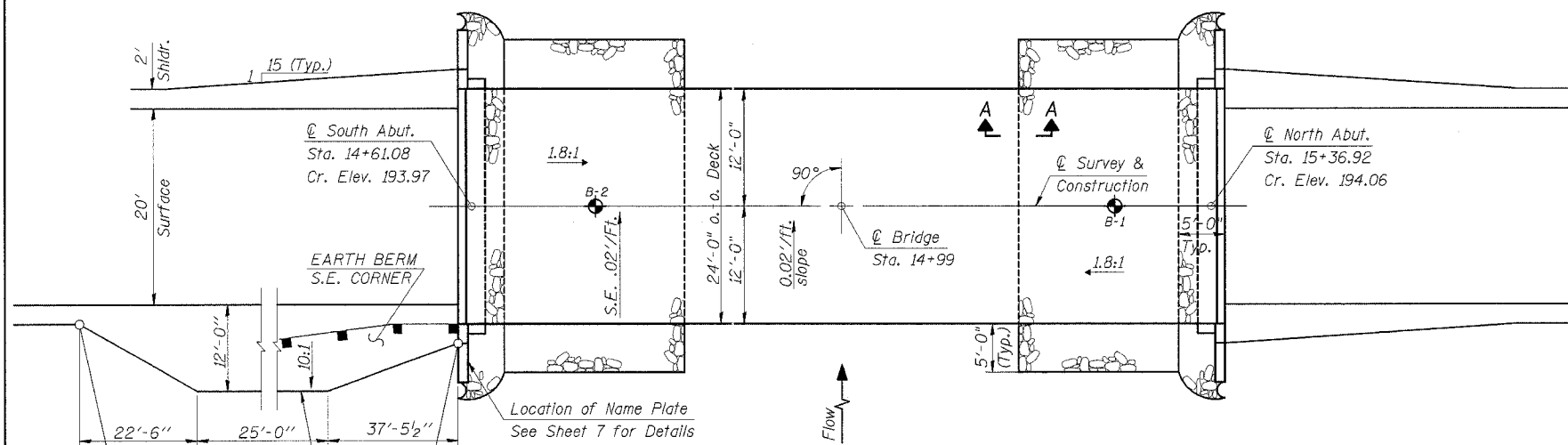

PLAN

TOTAL BILL OF MATERIAL

ITEM	UNIT	SUPER	SUB	TOTAL
Precast Prestressed Concrete Deck Beams (33" Depth)	Sq. Ft.	1,848		1,848
Concrete Structures Reinforcement Bars	Cu. Yd.		24.8	24.8
Steel Railing, Type S1	Pound	3,300		3,300
Name Plates	Foot	154		154
Steel Pile HP10x42	Each		1	1
Test Pile Steel HP10x42	Foot		212	212
Stone Riprap, Class A4	Each		2	2
Filter Fabric For Use with Riprap	Ton		154	154
Concrete Encasement	Sq. Yd.		191	191
	Cu. Yd.		5.4	5.4

WATERWAY INFORMATION

Drainage Area	9.19 Sq. Mi.
Existing Opening (15 Yr.)	304 Sq. Ft.
Required Opening (15 Yr.)	458 Sq. Ft.
Proposed Opening (15 Yr.)	458 Sq. Ft.
Design Discharge (15 Yr.)	1,609 C.F.S.
Created Head (15 Yr.)	0.0 Ft.
100 Year Discharge	2,564 C.F.S.
100 Yr. Created Head	0.2 Ft.

DESIGN STRESSES

$f'_c = 5,000$  p.s.i. (Prestressed Beams)  
 $f_{ci} = 4,950$  p.s.i. (Prestressed Beams)  
 $f'_c = 1,400$  p.s.i. (Concrete)  
 $f'_s = 270,000$  p.s.i. (Prestressed Strands)  
 $f_{si} = 189,000$  p.s.i. (Prestressed Strands)  
 $f_s = 24,000$  p.s.i. (Reinf. Bars -- Field Units)  
 $f_y = 60,000$  p.s.i. (Reinf. Bars -- Field Units)  
 $n = 9$  (Concrete)  
 LOADING HS20-44  
 Design Specifications: 1996 AASHTO & Interims  
 50#/Sq. Ft. Included in dead load for future wearing surface.

"I certify that to the best of my knowledge, information and belief, this bridge design is structurally adequate for the design loading shown on the plans. The design is an economical one for the style of structure and complies with requirements of the current 'AASHTO Standard Specifications for Highway Bridges'."

Fred J. Stone, Jr. (112-103)  
 ILLINOIS STRUCTURAL NO. 2934 (Expires 11/30/04)

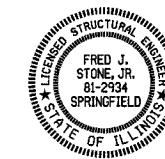

GENERAL PLAN & ELEVATION

SECTION 98-02117-00-BR  
 BIG SPRING ROAD DISTRICT  
 SHELBY COUNTY  
 STATION 14+99

4440 ASH GROVE  
 SPRINGFIELD, IL 62707  
 (217) 793-8800  
 oasinc@tamvid.com

OZYURT AND STONE, INC.  
 CONSULTING ENGINEERS

JOB NO.: 9834  
 FILE: GPE.DGN  
 DATE: 12-01-03

DESIGNED	S.F.M.
CHECKED	M.E.B.
DRAWN	D.E.G.
CHECKED	F.J.S.