

T.R.	SECTION	COUNTY	TOTAL SHEETS	SHEET NO.
235	93-02109-00-BR	CHRISTIAN	18	1
STA.		TO STA.		
FED. ROAD DIST. NO.		ILLINOIS FED. AID PROJECT		

STATE OF ILLINOIS DEPARTMENT OF TRANSPORTATION PLANS FOR PROPOSED BRIDGE REPLACEMENT AND REHABILITATION PROGRAM

**TOWNSHIP ROAD 235
SECTION 93-02109-00-BR
BEAR CREEK ROAD DISTRICT
STRUCTURE NO. 011-3400
PROJECT NO. BR-0S-021 (145)
CHRISTIAN COUNTY
JOB NUMBER C-96-248-95**

INDEX OF SHEETS	
SHEET NO.	DESCRIPTION
1	COVER SHEET
2	SUMMARY OF QUANTITIES, GENERAL NOTES TYPICAL SECTIONS ENTRANCE DETAILS
3-4	SOIL EROSION & SEDIMENT CONTROL PLAN
5	PLAN AND PROFILE
6-8	CROSS SECTIONS
9-18	BRIDGE PLANS

IDOT HIGHWAY STANDARDS	
000001-04	STANDARD SYMBOLS, ABBREVIATIONS AND PATTERNS
280001-02	TEMPORARY EROSION CONTROL SYSTEMS
515001-02	NAME PLATE FOR BRIDGESTRAFFIC CONTROL DEVICES
702001-05	TYPICAL APPLICATION OF TRAFFIC CONTROL DEVICES
BLR 21-6	FOR CONSTRUCTION ON RURAL LOCAL HIGHWAYS

UTILITY CONTACTS	
ILLINOIS CONSOLIDATED TELEPHONE CO. MR. BRIAN MORGAN 121 SOUTH 17th STREET MATTON, ILLINOIS 61938 217-234-5971	
SHELBY ELECTRIC COOPERATIVE MR. JIM MATLOCK P.O. BOX 560 SHELBYVILLE, ILLINOIS 62565 217-774-3986	



SCALES	
PLAN	0 50 100
PROFILE HORIZ.	0 50 100
PROFILE VERT.	0 5 10
CROSS SECTIONS HORIZ.	0 10 20
CROSS SECTIONS VERT.	0 5 10

FULL SIZE PLANS HAVE BEEN PREPARED USING STANDARD ENGINEERING SCALES, REDUCED SIZED PLANS WILL NOT CONFORM TO STANDARD SCALES. WHEN MAKING MEASUREMENTS ON REDUCED PLANS, THE ABOVE SCALES MAY BE USED.

APPROVED	8/23	20 04
	<i>Joseph Steinhilber</i>	HIGHWAY COMMISSIONER
PASSED	8/23	20 04
	<i>Chris D. Frey</i>	COUNTY ENGINEER
PASSED	9-10	20 04
	<i>William E. Martens</i>	DISTRICT ENGINEER OF LOCAL ROADS & STREETS
PASSED	Sept 13	20 04
	<i>W. R. Frey</i>	DISTRICT ENGINEER OF CONSTRUCTION
APPROVED	SEP. 15	20 04
	<i>Christ H. Reed</i>	DISTRICT ENGINEER

THE STATE OF ILLINOIS DEPARTMENT OF TRANSPORTATION

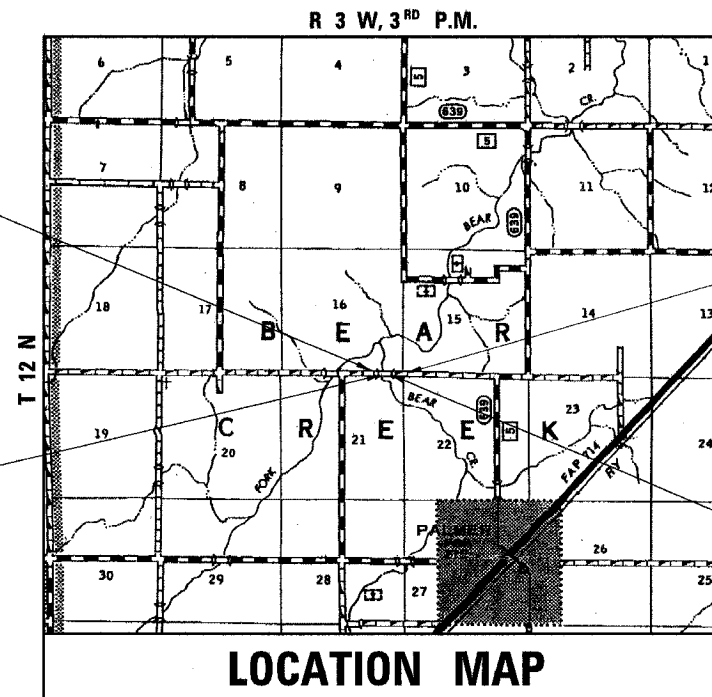

APPROXIMATE SCALE: 0 1 2 MILES
NET LENGTH OF PROJECT = 600.00 FEET 0.114 MILES
HIGHWAY CLASSIFICATION = LOCAL ROAD
CURRENT ADT <150

EXISTING STRUCTURE NO. 011-3186
1 - SPAN STEEL PONY TRUSS WITH CONCRETE DECK. CLOSED CONCRETE WINGWALLS AND ABUTMENTS. 16'-0" WIDTH, 74'-0" BK TO BK OF ABUTMENTS.

STA. 6 + 25.42 - SPECIAL BRIDGE DESIGN
4 - SPAN 27" P.C.C. DECK BEAMS ON PILE BENT ABUTMENTS AND PIERS. 194'-10" BK TO BK OF ABUTMENTS, 24'-0" CLEAR WIDTH, 15° SKEW LT. STRUCTURE NO. 011-3400

BEGIN IMPROVEMENT
STA. 3 + 00

END IMPROVEMENT
STA. 9 + 00

INTERNATIONAL ENGINEERING CONSULTANTS, INC.
ie consultants
6420 SOUTH SIXTH STREET
SPRINGFIELD, ILLINOIS 62707
TEL. (217) 529-8027
FAX (217) 529-4543
IESPRINGFIELD@IE-CONSULTANTS.COM
WWW.IE-CONSULTANTS.COM

CONTRACT NO. 93385



DAVID BOOHER, ILLINOIS P.E. 062-043769
EXPIRES 11/30/2005

8-19-04
DATE

CALL **J.U.L.I.E.** (JOINT UTILITY LOCATION INFORMATION FOR EXCAVATORS)
48 Hours (2 working days) Before You Dig.
TOLL FREE: 1 (800) 892-0123