

F.A.P. RTE.	SECTION	COUNTY	TOTAL SHEETS	SHEET NO.
328	5R, Y, RS-1	CLAY	376	44
STA. 1125+00		TO STA. 1140+00		
FED. ROAD DIST. NO.	ILLINOIS	FED. AID PROJECT		
CONTRACT No 94367				

FAP RTE 328 (US45)
 PI Sta. 1126+99.09
 $\Delta = 0^\circ 39' 59''$ (RT)
 $D = 0^\circ 04' 27''$
 $T = 448.73'$
 $R = 77,174.40'$
 $L = 897.45'$
 $E = 1.30'$
 PC Sta. 1122+50.36
 PT Sta. 1131+47.81
 SE RATE= NONE

STA 1127+96.78
 74 LF 15" PIPE CULV
 CLASS D TYPE 2
 2-END SEC 15"

DETOUR 2
 PI Sta. 15+70.06
 $\Delta = 0^\circ 39' 56''$ (RT)
 $D = 0^\circ 04' 27''$
 $T = 448.47'$
 $R = 77,223.61'$
 $L = 896.93'$
 $E = 1.30'$
 PC Sta. 11+21.59
 PT Sta. 20+18.52
 SE RATE= NONE

DETOUR 2
 PI Sta. 23+22.19
 $\Delta = 0^\circ 38' 30''$ (LT)
 $D = 0^\circ 08' 12''$
 $T = 234.72'$
 $R = 41,912.40'$
 $L = 469.43'$
 $E = 0.66'$
 PC Sta. 20+87.47
 PT Sta. 25+56.91
 SE RATE= NONE

DETOUR 2
 PI Sta. 26+21.98
 $\Delta = 11^\circ 52' 47''$ (RT)
 $D = 9^\circ 10' 02''$
 $T = 65.03'$
 $R = 625.00'$
 $L = 129.59'$
 $E = 3.37'$
 PC Sta. 25+56.95
 PT Sta. 26+86.54
 SE RATE= 8.00%
 SE ATTAINED:
 STA. 24+05.89 TO 26+16.89
 STA. 26+26.59 TO 27+29.42

DETOUR 2
 PI Sta. 28+55.96
 $\Delta = 12^\circ 23' 51''$ (LT)
 $D = 7^\circ 15' 09''$
 $T = 85.80'$
 $R = 790.00'$
 $L = 170.94'$
 $E = 4.65'$
 PC Sta. 27+70.16
 PT Sta. 29+41.10
 SE RATE= N/A

STA 1140+15.61
 50 LF 18"
 PIPE CULVERT
 CLASS D TYPE 1
 2-END SEC 18"

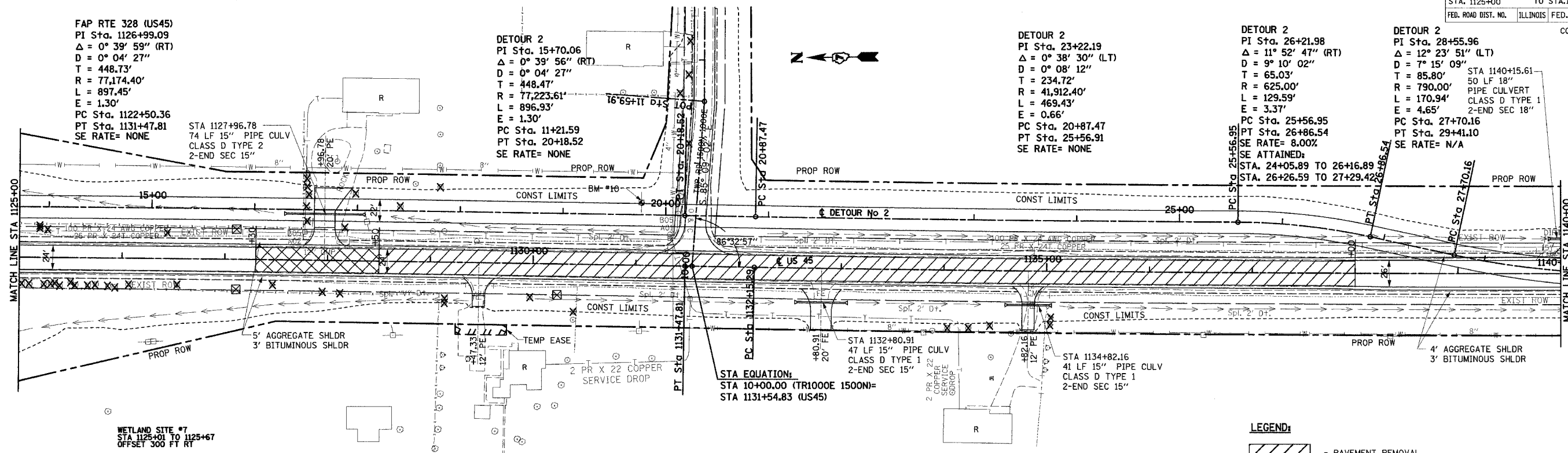

WETLAND SITE #7
 STA 1125+01 TO 1125+67
 OFFSET 300 FT RT

STA EQUATION:
 STA 10+00.00 (TR1000E 1500N)=
 STA 1131+54.83 (US45)

BM #10 STA 1131+05.00, 60.70' LT.
 RR SPIKE IN POWER POLE N.E.
 QUAD. INTERSECTION TWP RD 1000E/1500N
 EL 501.86

LEGEND:

- PAVEMENT REMOVAL
- PAVEMENT TO BE BROKEN

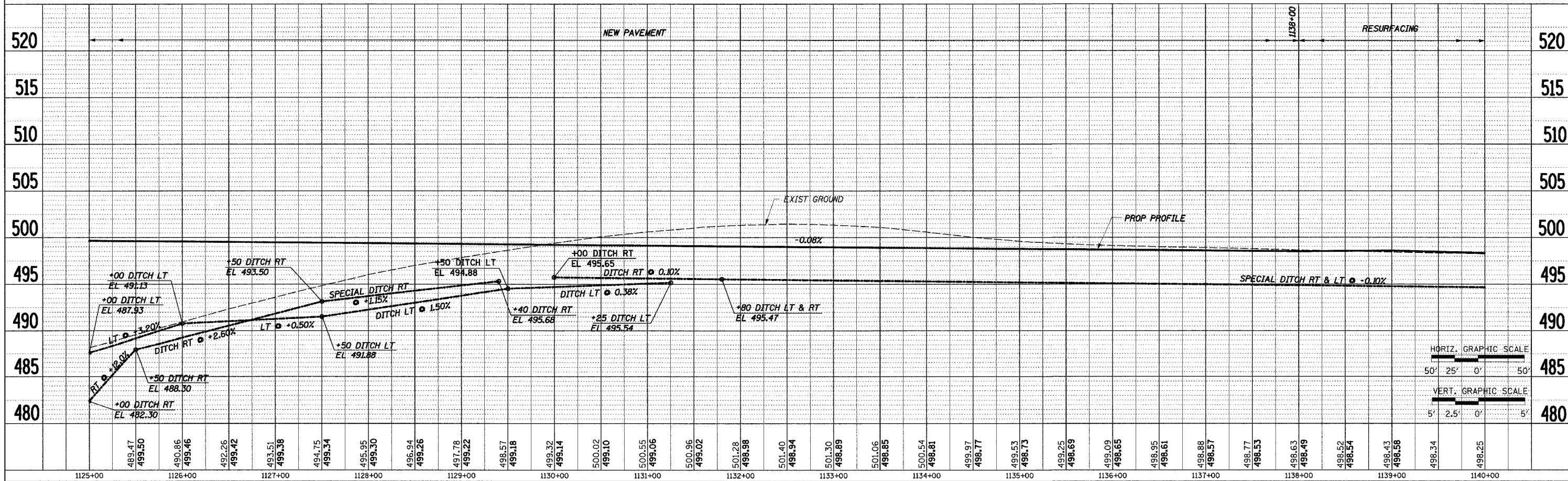
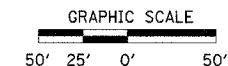

STA 1125+00 TO STA 1140+00

PLAN	DATE	BY	DATE
SURVEYED			
ALIGNED			
CHECKED			
NO. OF MAY CHECKED			
NO.			

PROFILE	DATE	BY	DATE
SURVEYED			
GRADES CHECKED			
NO. NOTED			
NO.			

12/14/2004 7:05:05 AM