

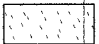

F.A. DIST.	SECTION	COUNTY	TOTAL SHEETS	SHEET NO.
32B	5R, Y, RS-1	CLAY	376	281
STA. TO STA.		BLISS		
FED. ROAD DIST. NO.		FED. AID PROJECT		

CONTRACT No 94367

- LEGEND**
-  TOPSOIL EXCAVATION
  -  REMOVAL & DISPOSAL OF RESTRICTED SOIL (RESTRICTED SOIL=EMBANKMENT SPL PROVISION)
  -  PAVEMENT REMOVAL
  -  PAVEMENT TO BE BROKEN & LEFT IN PLACE

PLOTTED BY: [ ]  
 DATE: [ ]  
 NOTE BOOK NO.: [ ]  
 AREAS CHECKED: [ ]

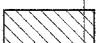
PLOTTED BY: [ ]  
 DATE: [ ]  
 NOTE BOOK NO.: [ ]  
 AREAS CHECKED: [ ]

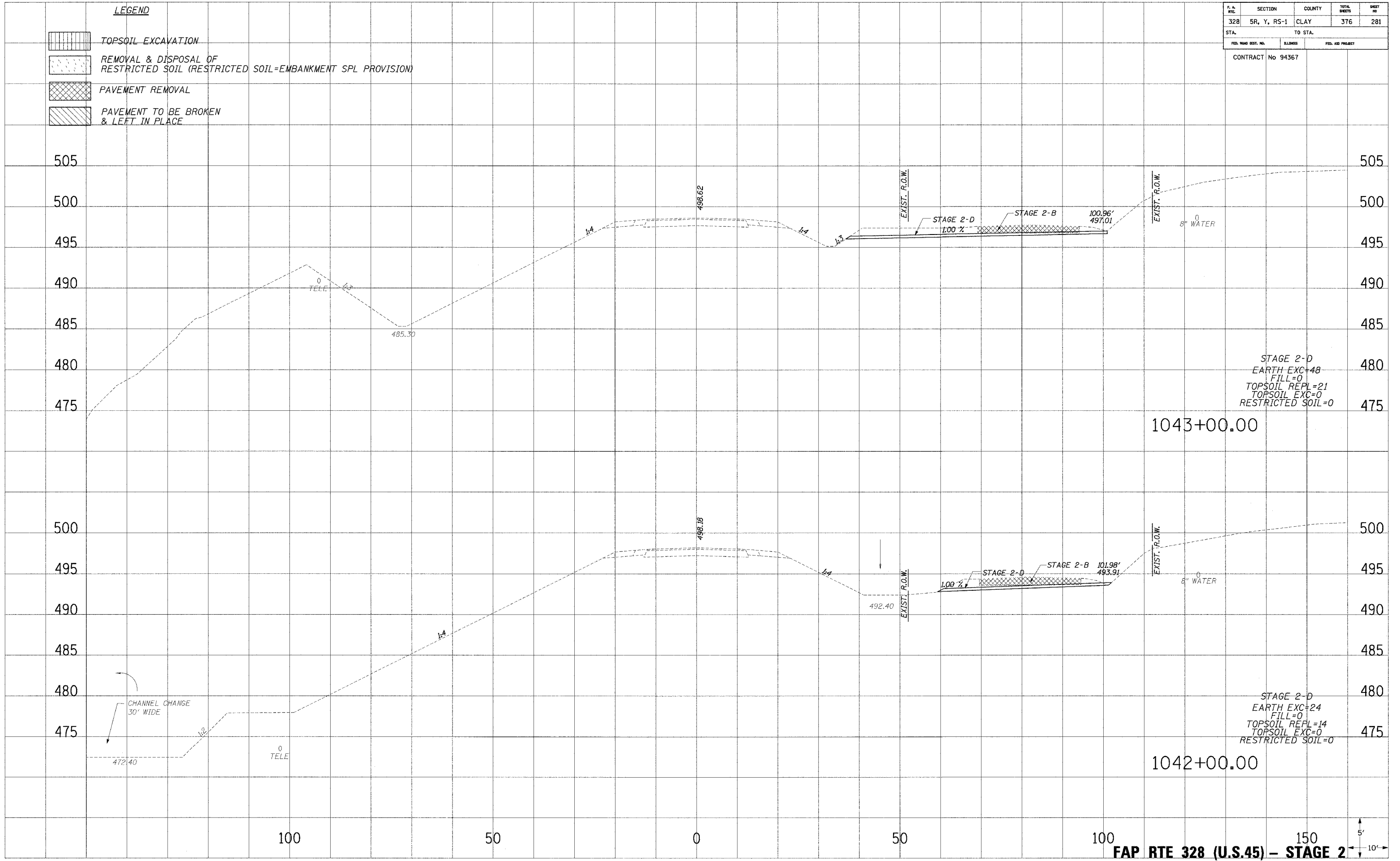

STAGE 2-D  
 EARTH EXC=48  
 FILL=0  
 TOPSOIL REPL=21  
 TOPSOIL EXC=0  
 RESTRICTED SOIL=0

STAGE 2-D  
 EARTH EXC=24  
 FILL=0  
 TOPSOIL REPL=14  
 TOPSOIL EXC=0  
 RESTRICTED SOIL=0

FAP RTE 328 (U.S.45) - STAGE 2