

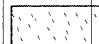

P.L. NO.	SECTION	COUNTY	TOTAL SHEETS	SHEET NO.
328	5R, Y, RS-1	CLAY	376	302
STA.		TO STA.		
FED. ROAD DIST. NO.		BLDG. NO.	FED. AID PROJECT	
		CONTRACT No 94367		

- LEGEND**
-  TOPSOIL EXCAVATION
 -  REMOVAL & DISPOSAL OF RESTRICTED SOIL (RESTRICTED SOIL=EMBANKMENT SPL PROVISION)
 -  PAVEMENT REMOVAL
 -  PAVEMENT TO BE BROKEN & LEFT IN PLACE

PLOTTED
 NOTE BOOK
 TEMPLATE
 AREAS
 CHECKED
 NO.

PLOTTED
 NOTE BOOK
 TEMPLATE
 AREAS
 CHECKED
 NO.

PLOTTED
 NOTE BOOK
 TEMPLATE
 AREAS
 CHECKED
 NO.

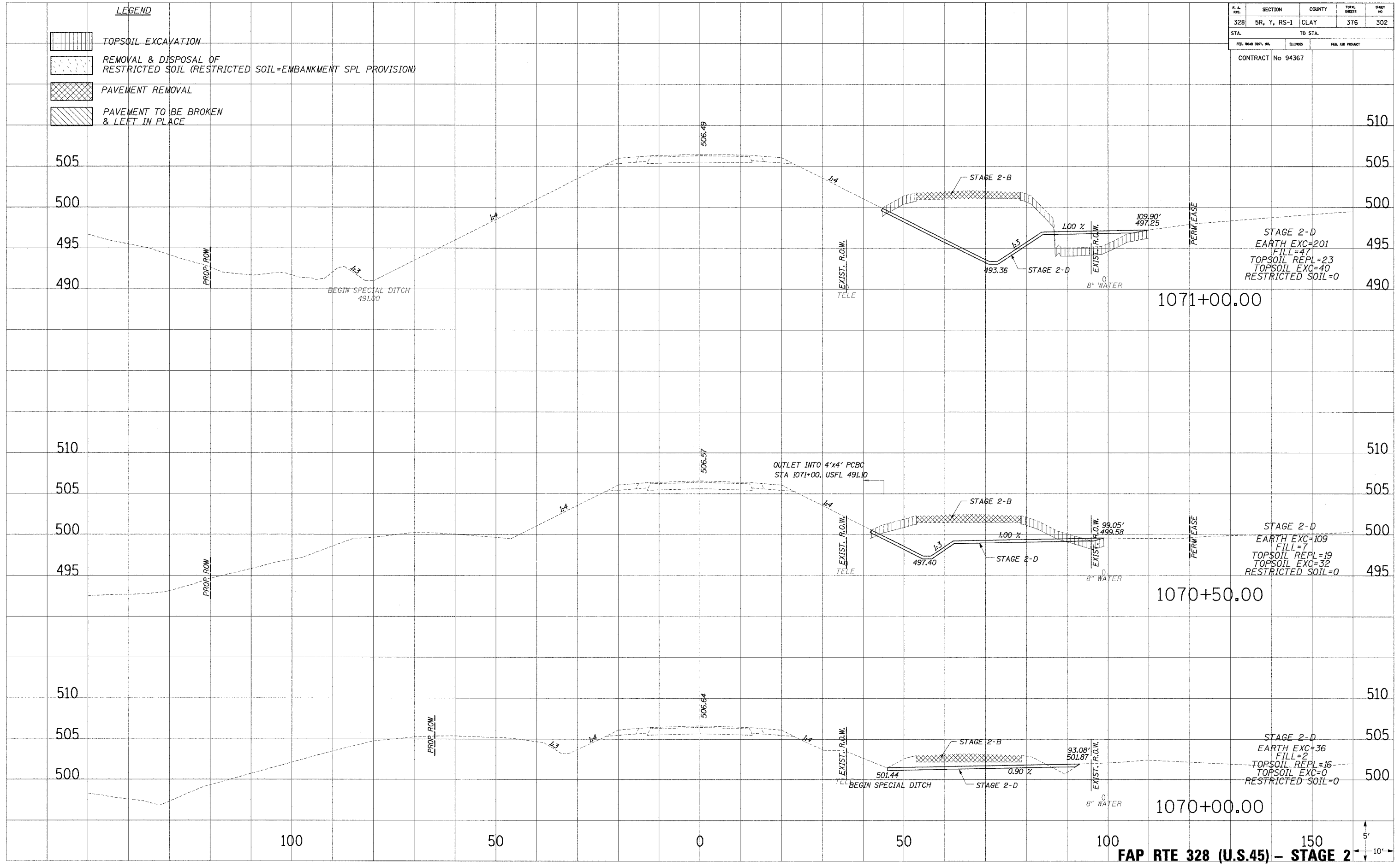

FAP RTE 328 (U.S.45) - STAGE 2

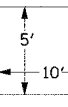

.../.../2004 6:17:35 AM