

P. & M. NO.	SECTION	COUNTY	TOTAL SHEETS	SHEET NO.
328	5R, Y, RS-1	CLAY	376	353
STA.		TO STA.		
FED. ROAD DIST. NO.		ILLINOIS	FED. AID PROJECT	
CONTRACT No 94367				

LEGEND

	TOPSOIL EXCAVATION
	REMOVAL & DISPOSAL OF RESTRICTED SOIL (SEE EMBANKMENT SPL PROVISION)
	PAVEMENT REMOVAL
	PAVEMENT TO BE BROKEN & LEFT IN PLACE

PLOTTED
DATE
BY
NO.

PLOTTED
DATE
BY
NO.

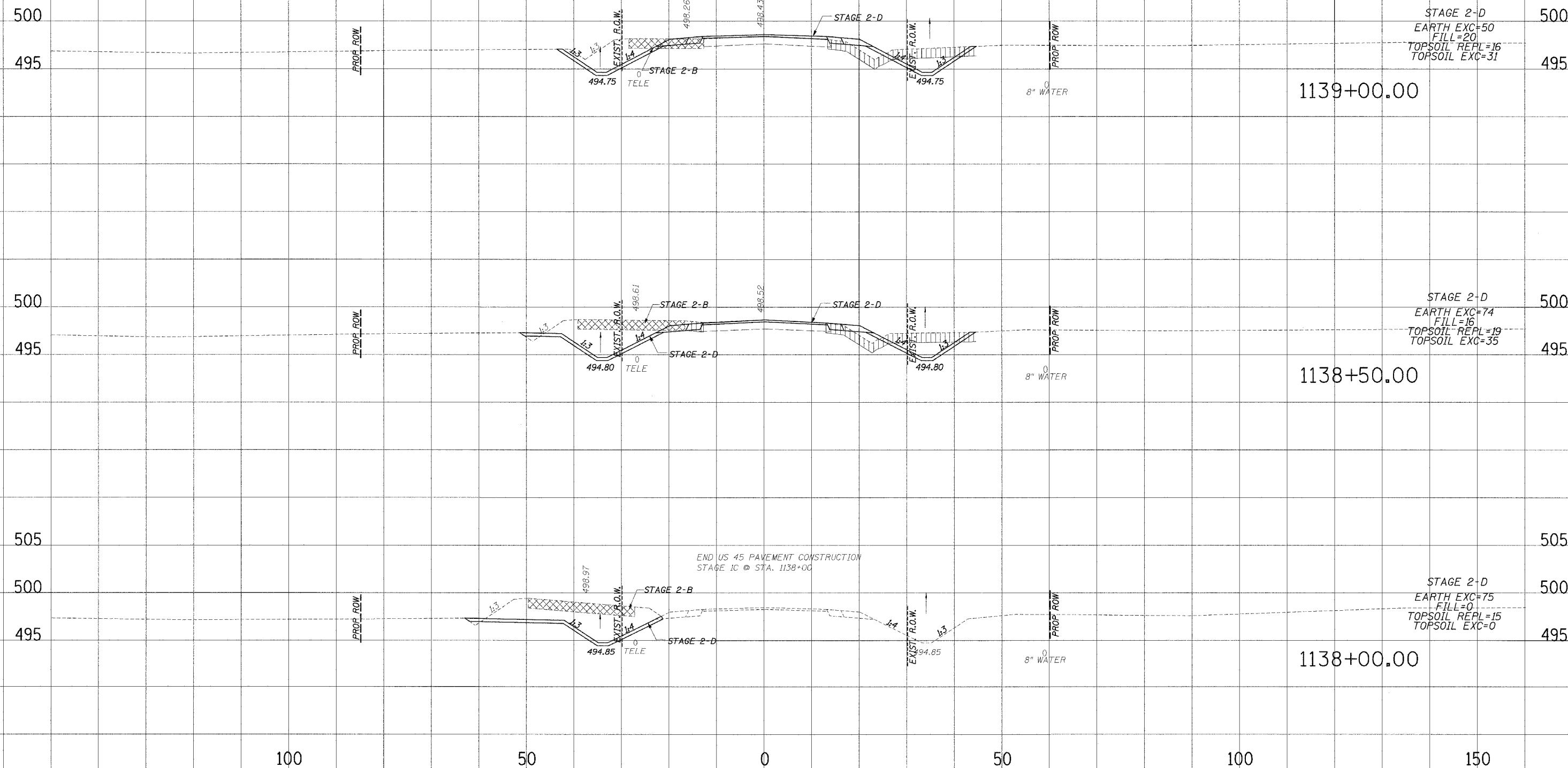

STAGE 2-D
EARTH EXC=50
FILL=20
TOPSOIL REPL=16
TOPSOIL EXC=31

1139+00.00

STAGE 2-D
EARTH EXC=74
FILL=16
TOPSOIL REPL=19
TOPSOIL EXC=35

1138+50.00

STAGE 2-D
EARTH EXC=75
FILL=0
TOPSOIL REPL=15
TOPSOIL EXC=0

1138+00.00

END US 45 PAVEMENT CONSTRUCTION
STAGE 1C @ STA. 1138+00

100

50

0

50

100

150

FAP RTE 328 (U.S.45) - STAGE 2

11/13/2004 2:35:50 PM