

PROPOSED TRAFFIC CONTROL TYPICAL SECTION 5  
 STA. 40+10 TO STA. 41+32

- SHEET NOTES:**
1. STATION 40+10 TO STATION 46+80.05 MILL EXISTING PAVEMENT AND APPLY LEVELING BINDER TO EXISTING PAVEMENT.
  2. CONSTRUCT BASE COURSE WIDENING TO SAME ELEVATION AS LEVELING BINDER ON EXISTING PAVEMENT. CONTRACTOR IS TO CONFINE BASE COURSE WIDENING TO ONE SIDE OF ROADWAY AT A TIME.
  3. WHEN BASE COURSE WIDENING IS COMPLETE APPLY SURFACE COURSE TO EXISTING PAVEMENT AND WIDENING. SURFACE COURSE TO BE APPLIED UNDER TRAFFIC UTILIZING FLAGGERS.

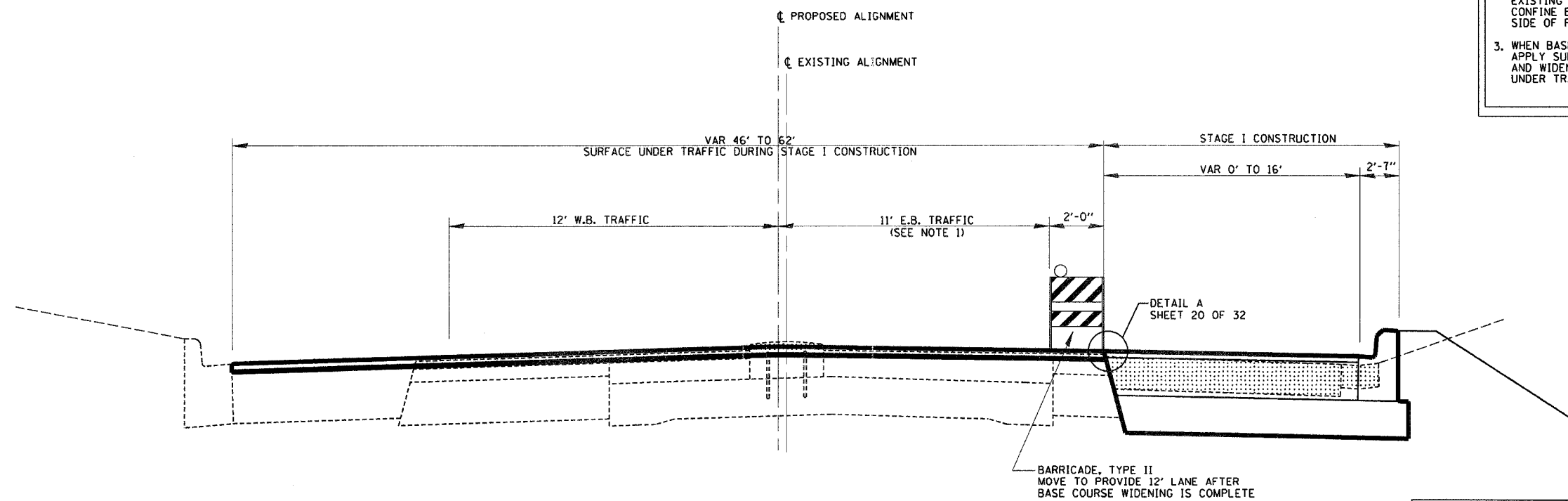

PROPOSED TRAFFIC CONTROL TYPICAL SECTION 6  
 STA. 41+32 TO STA. 46+80.05

**LEGEND**

STAGE I CONSTRUCTION  
 STAGE I REMOVAL

REVISIONS	
NAME	DATE

ILLINOIS DEPARTMENT OF TRANSPORTATION

TYPICAL SECTIONS  
 STAGE I  
 SHEET 11 OF 32

DRAWN BY MLO  
 CHECKED BY SJK  
 DATE 8/02