

F.A.P. RTE.	SECTION	COUNTY	TOTAL SHEETS	SHEET NO.
774	*	EFFINGHAM	344	43
FED. ROAD DIST. NO. 7		ILLINOIS	FED. AID PROJECT	
*107WRS-1, 107BY, 107BY-1 & 107B-2		CONTRACT NO. 94827		

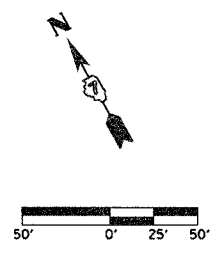
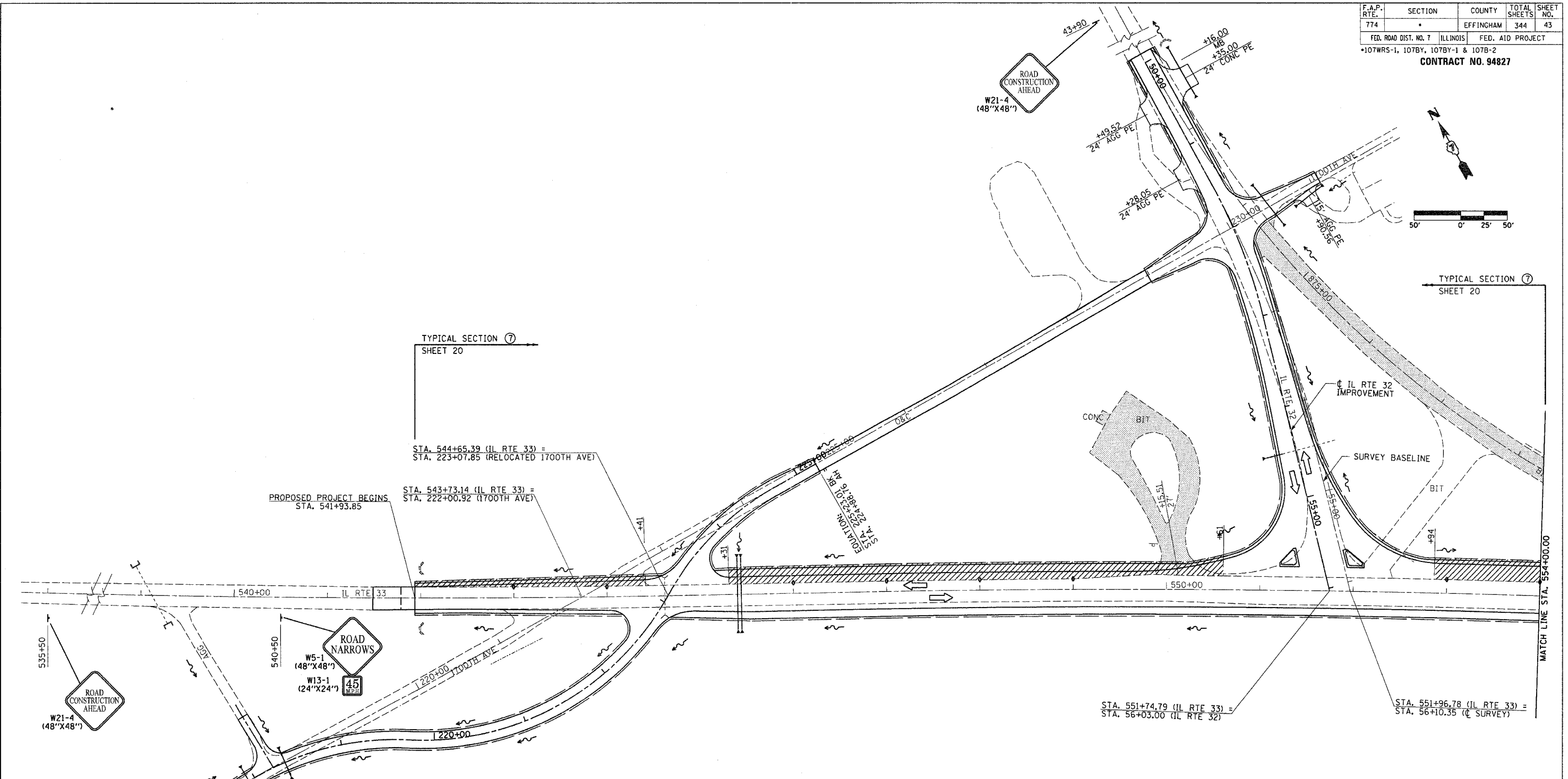

TYPICAL SECTION ⑦
SHEET 20

STA. 544+65.39 (IL RTE 33) =
STA. 223+07.85 (RELOCATED 1700TH AVE)

PROPOSED PROJECT BEGINS
STA. 541+93.85

STA. 543+73.14 (IL RTE 33) =
STA. 222+00.92 (1700TH AVE)

STA. 551+74.79 (IL RTE 33) =
STA. 56+03.00 (IL RTE 32)

STA. 551+96.78 (IL RTE 33) =
STA. 56+10.35 (☉ SURVEY)

NOTES:

1. MAINTAIN 2 LANE 2 WAY TRAFFIC ON IL ROUTE 32/33 THROUGHOUT DURATION OF STAGE II CONSTRUCTION.
2. FOR PROPOSED TRAFFIC CONTROL TYPICAL SECTIONS, SEE SHEETS 20, 21 AND 22 OF 32.
3. ALL TRAFFIC CONTROL ITEMS FOR STAGE II TO BE INCLUDED IN THE COST OF "TRAFFIC CONTROL AND PROTECTION (SPECIAL), LOCATION 2.", EXCEPT THE FOLLOWING WILL BE PAID FOR SEPARATELY.
-TEMPORARY CONCRETE BARRIERS (RELOCATE)
-TEMPORARY TRAFFIC BARRIER TERMINAL, TYPE 3
-ALL TEMPORARY PAVEMENT MARKINGS
-TEMPORARY RAMPS
4. UTILIZE STAGE CONSTRUCTION TO MAINTAIN ACCESS TO ALL PRIVATE AND COMMERCIAL ENTRANCES AND PUBLIC ACCESS ROADWAYS DURING STAGE II CONSTRUCTION.

LEGEND

- STAGE II CONSTRUCTION
- STAGE II REMOVAL
- BARRICADES, TYPE II

REVISIONS	
NAME	DATE

ILLINOIS DEPARTMENT OF TRANSPORTATION

**TRAFFIC CONTROL
STAGE II CONSTRUCTION
SHEET 12 OF 32**

DATE 8/02

DRAWN BY ASB
CHECKED BY RDW