

F.A.P. RTE.	SECTION	COUNTY	TOTAL SHEETS	SHEET NO.
774	.	EFFINGHAM	344	54
FED. ROAD DIST. NO. 7		ILLINOIS	FED. AID PROJECT	
•107WRS-1, 107BY, 107BY-1 & 107B-2		CONTRACT NO. 94827		

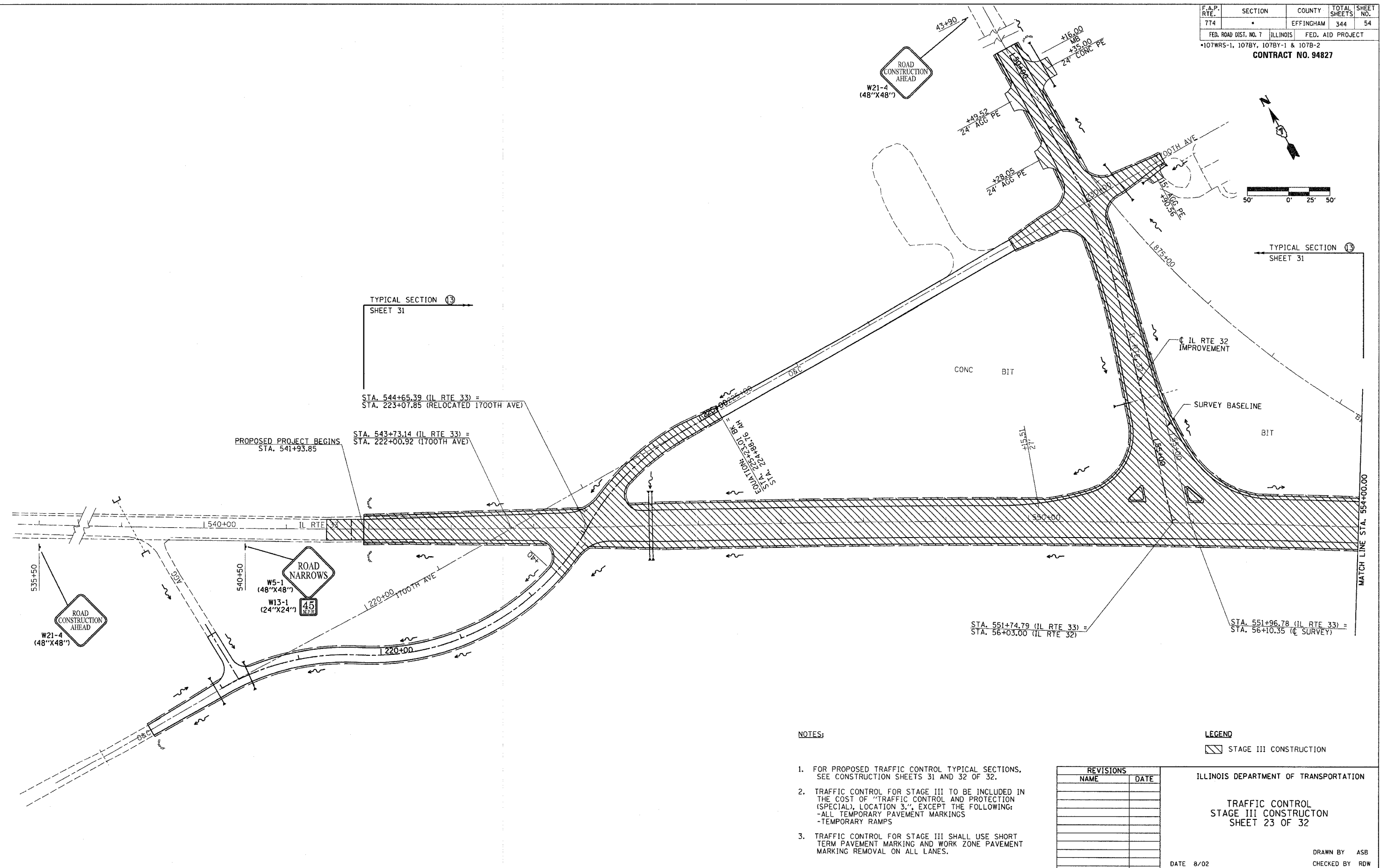

TYPICAL SECTION 13
SHEET 31

STA. 544+65.39 (IL RTE 33) =
STA. 223+07.85 (RELOCATED 1700TH AVE)

PROPOSED PROJECT BEGINS
STA. 541+93.85

STA. 543+73.14 (IL RTE 33) =
STA. 222+00.92 (1700TH AVE)

STA. 551+74.79 (IL RTE 33) =
STA. 56+03.00 (IL RTE 32)

STA. 551+96.78 (IL RTE 33) =
STA. 56+10.35 (C SURVEY)

NOTES:

- FOR PROPOSED TRAFFIC CONTROL TYPICAL SECTIONS, SEE CONSTRUCTION SHEETS 31 AND 32 OF 32.
- TRAFFIC CONTROL FOR STAGE III TO BE INCLUDED IN THE COST OF "TRAFFIC CONTROL AND PROTECTION (SPECIAL), LOCATION 3," EXCEPT THE FOLLOWING:
- ALL TEMPORARY PAVEMENT MARKINGS
- TEMPORARY RAMPS
- TRAFFIC CONTROL FOR STAGE III SHALL USE SHORT TERM PAVEMENT MARKING AND WORK ZONE PAVEMENT MARKING REMOVAL ON ALL LANES.

REVISIONS	
NAME	DATE

LEGEND

STAGE III CONSTRUCTION

ILLINOIS DEPARTMENT OF TRANSPORTATION

TRAFFIC CONTROL
STAGE III CONSTRUCTION
SHEET 23 OF 32

DATE 8/02

DRAWN BY ASB
CHECKED BY RDW