

F.A.P. RTE.	SECTION	COUNTY	TOTAL SHEETS	SHEET NO.
774		EFFINGHAM	344	82

FED. ROAD DIST. NO. 7 ILLINOIS FED. AID PROJECT
 107WRS-1, 107BY, 107BY-1 & 107B-2
CONTRACT NO. 94827

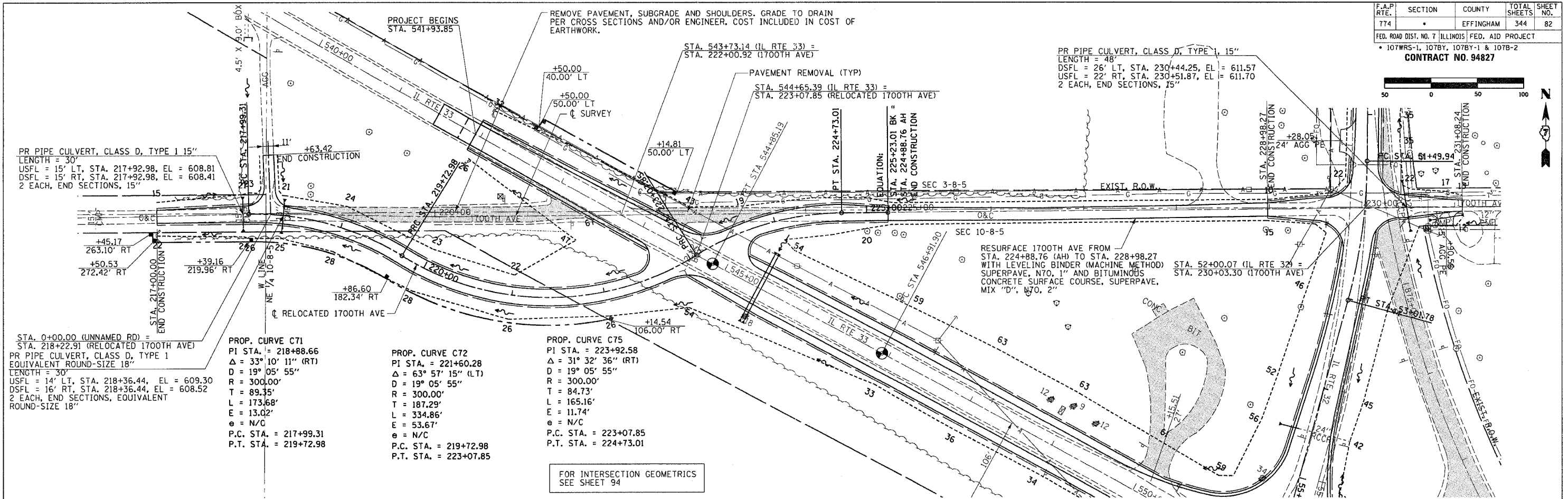

PR PIPE CULVERT, CLASS D, TYPE 1, 15"
 LENGTH = 30'
 USFL = 15' LT, STA. 217+92.98, EL = 608.81
 DSFL = 15' RT, STA. 217+92.98, EL = 608.41
 2 EACH, END SECTIONS, 15"

STA. 0+00.00 (UNNAMED RD) =
 STA. 218+22.91 (RELOCATED 1700TH AVE)
 PR PIPE CULVERT, CLASS D, TYPE 1
 EQUIVALENT ROUND-SIZE 18"
 LENGTH = 30'
 USFL = 14' LT, STA. 218+36.44, EL = 609.30
 DSFL = 16' RT, STA. 218+36.44, EL = 608.52
 2 EACH, END SECTIONS, EQUIVALENT
 ROUND-SIZE 18"

PROP. CURVE C71
 PI STA. = 218+88.66
 $\Delta = 33^\circ 10' 11"$ (RT)
 $D = 19^\circ 05' 55"$
 $R = 300.00'$
 $T = 89.35'$
 $L = 173.68'$
 $E = 13.02'$
 $e = N/C$
 P.C. STA. = 217+99.31
 P.T. STA. = 219+72.98

PROP. CURVE C72
 PI STA. = 221+60.28
 $\Delta = 63^\circ 57' 15"$ (LT)
 $D = 19^\circ 05' 55"$
 $R = 300.00'$
 $T = 187.29'$
 $L = 334.86'$
 $E = 53.67'$
 $e = N/C$
 P.C. STA. = 219+72.98
 P.T. STA. = 223+07.85

PROP. CURVE C75
 PI STA. = 223+92.58
 $\Delta = 31^\circ 32' 36"$ (RT)
 $D = 19^\circ 05' 55"$
 $R = 300.00'$
 $T = 84.73'$
 $L = 165.16'$
 $E = 11.74'$
 $e = N/C$
 P.C. STA. = 223+07.85
 P.T. STA. = 224+73.01

FOR INTERSECTION GEOMETRICS
 SEE SHEET 94

