

EXPANSION JOINT DETAIL

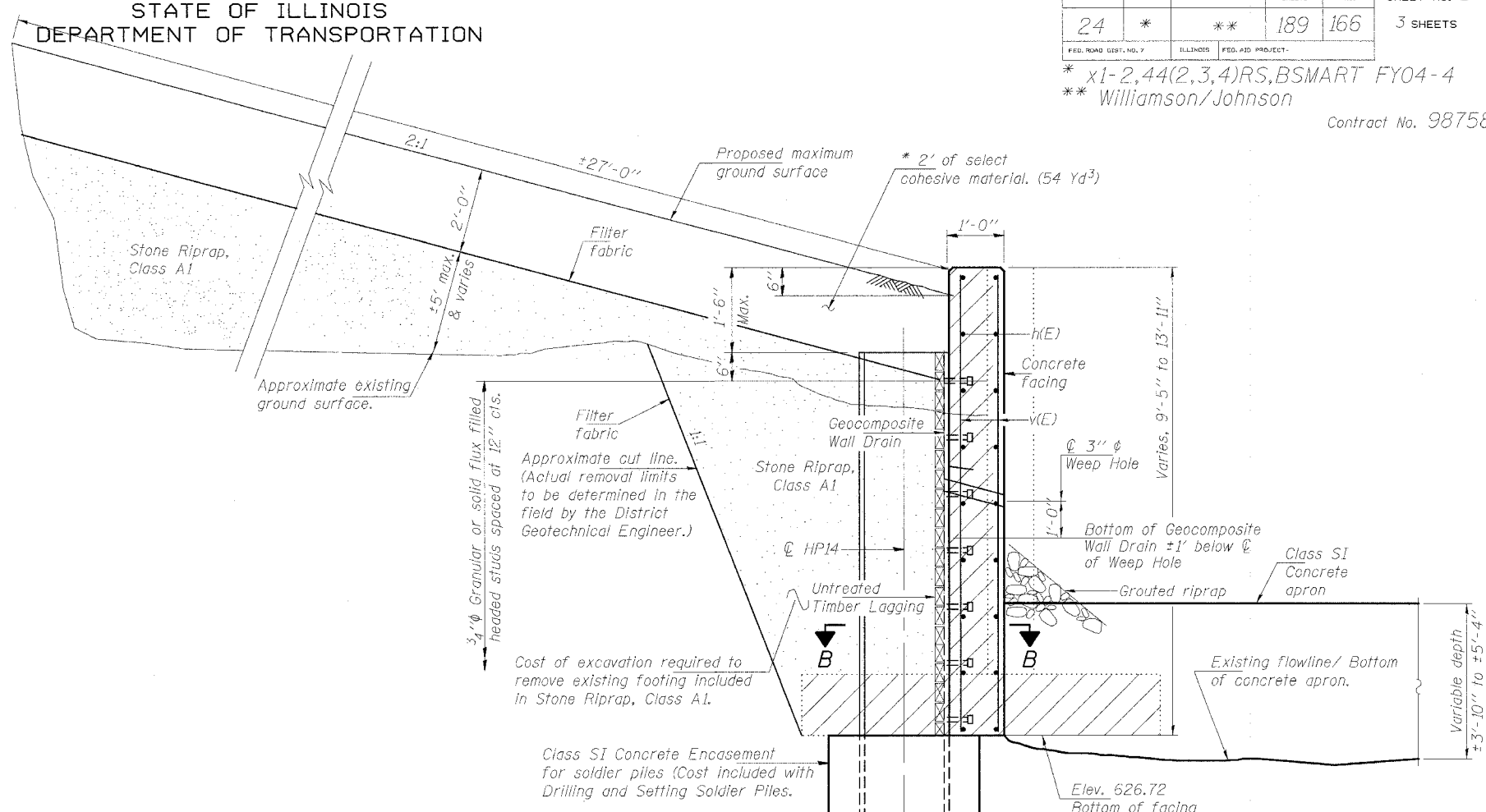

SECTION THRU WALL

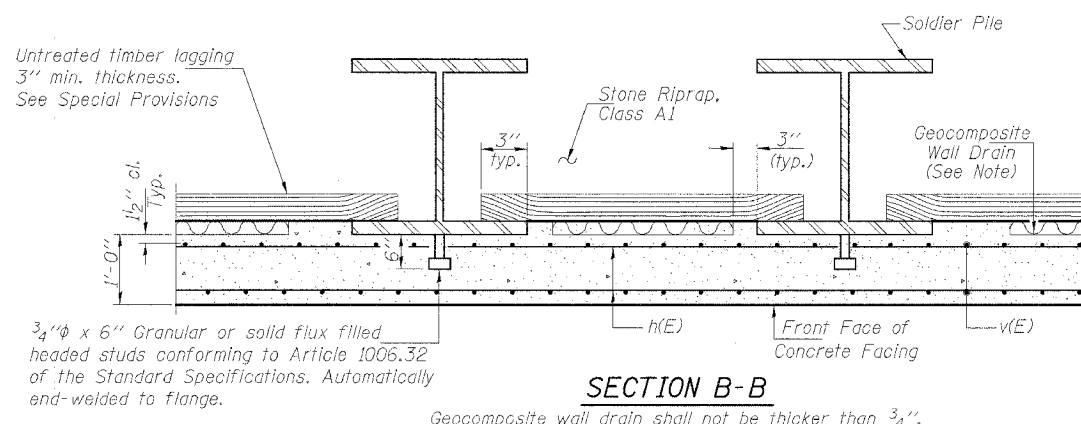

SECTION B-B
Geocomposite wall drain shall not be thicker than 3/4 inch.

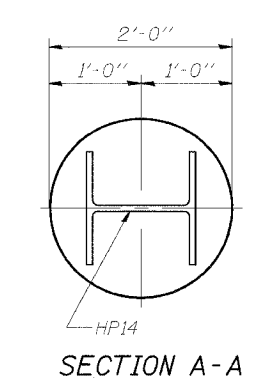

SECTION A-A

DESIGNED	FEBRUARY 24, 2005
CHECKED	EXAMINED
DRAWN	ENGINEER OF STRUCTURAL SERVICES
CHECKED	PASSED
	ENGINEER OF BRIDGES AND STRUCTURES

* May consist of existing soils and should be included in the contract unit price for Stone Riprap, Class A1.