

NOTE:

MILL EXISTING PAVEMENT TO A POINT THAT IS BOTH:
A. AT LEAST 0.10' BELOW THE EXISTING PAVEMENT SURFACE AND
B. AT LEAST 0.20' BELOW THE PROPOSED PAVEMENT SURFACE.

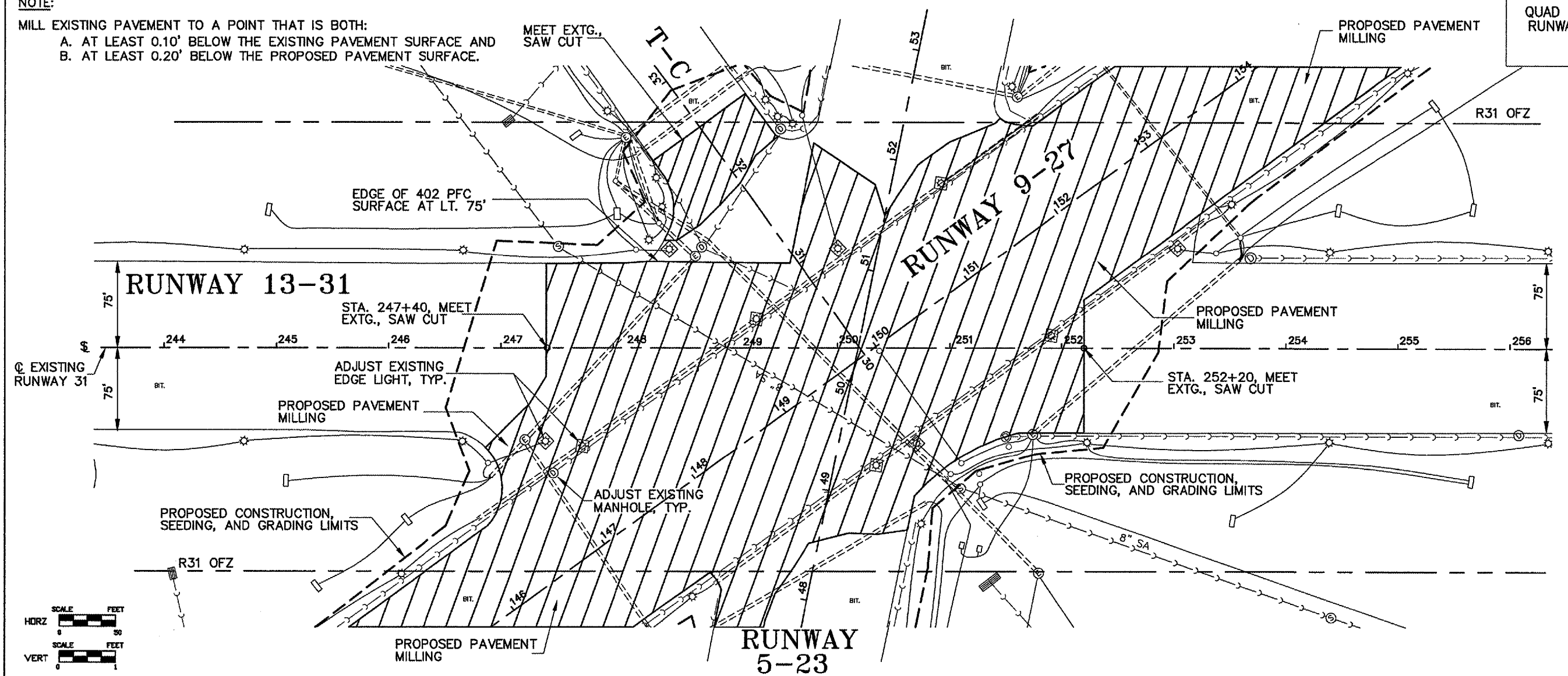

- LEGEND:**
- EDGE LIGHT
 - GUIDANCE SIGN
 - ELECTRICAL CABLE
 - STORM SEWER OR UNDERDRAIN INLET
 - OUTLET
 - STORM MANHOLE
 - ELECTRICAL MANHOLE
 - DRAINAGE DITCH
 - CONDUIT OR DUCT BANK
 - PROPOSED PAVEMENT MILLING
 - PROPOSED PAVEMENT REMOVAL

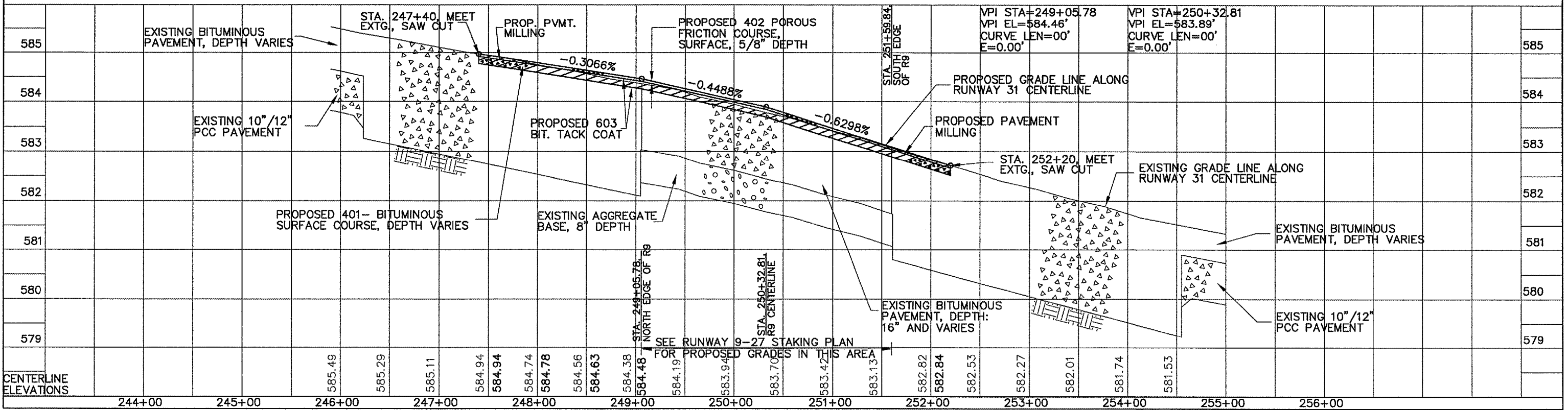
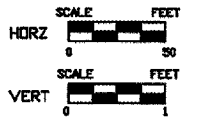

RUNWAY 13-31 PLAN & PROFILE. STA 244+00 TO STA 256+00 18/63

G:\Airport\A04T015\DESIGN REPORT\PP4.dwg, 1/25/2005 4:17:51 PM, jefim